

**MITSUBISHI
DIESEL ENGINE
S3L2-V363JG**

August 2008



**MITSUBISHI
HEAVY INDUSTRIES, LTD.**

Pub. No. 98615-MW200

MITSUBISHI GENUINE PARTS

"MITSUBISHI GENUINE PARTS" should be used exclusively for servicing your Mitsubishi engine.

"MITSUBISHI GENUINE PARTS" are superior and reliable because they have been produced under the excellent quality-control system, and have passed the strict inspections.

Imitation parts are not reliable from the viewpoints of their material and manufacturing method which are entirely incomparable with those of genuine parts.

A large assortment of "MITSUBISHI GENUINE PARTS" is always available at any of our authorized dealers, so do your ordering at your nearest dealer by specifying "MITSUBISHI GENUINE PARTS".

GUIDE FOR USE OF PARTS CATALOGUE

1. This Parts Catalogue contains service parts for the following Mitsubishi S3L2 diesel engine.
Then applicable engine type and serial number are as follows:

ENGINE NAME	MODEL	USE SPECIFICATION	APPLICABLE SERIAL NO.
S3L2	V363JGH	For Generator	167435-UP

2. When ordering parts, give the Mitsubishi dealer or distributor the following information:
 - (1) Part number (or assembly number) and part name.
 - (2) Quantity required
 - (3) Model and serial number

NOTE: In some cases, a substitute part is furnished instead of the part ordered.
3. Indication of assembled bolts with washer
Of the standard bolts, those with washers are identified by the symbol "B/W" in the Description column of each list. (Part Name: BOLT, W/WASHER)
For the part numbers of the bolts, washers and those of bolts with washers, refer to the listing (beginning with the page D1) at the end of this parts catalogue. These bolts and washers should be ordered individually.
4. For the numerical index, refer to the page beginning with C1 at the end of this parts catalogue.
5. Some illustration may have some difference from the shape of real part when the illustration Shows a representation of various parts.
6. The parts and part numbers are subject to change without prior notice.

SAMPLE OF PARTS CATALOGUE

Group number

Group name

01-01 CRANKCASE

Model type

When these column is blank, it is applicable from serial No. shown on cover and up.

Not applicable to the model of this column.

REF. NO.	PART NO.	R S C E N P O G	PART NAME & DESCRIPTION	MODEL&QTY		APPLICABLE SERIAL NO. FROM@ -@UPTO	M V R D
				S3L2			
1	32507-70010		CRANKCASE ASSY	1			
1 01	F2846-14000		PIN,DOWEL	1			A
1 02	32507-01400		WASHER	1			A
1 03	.		CAP,MAIN BEARING	6			
1 04	.		CAP,MAIN BEARING	1			
1 05	.		CRANKCASE	1			
2	32507-02500	C	HANGER B10,B13	1		-011285	
	32507-02700	N 1	HANGER B10,B13	1		011286-	V
3	32507-04100	Q	SHIM T=0.5	.		@011294	
	32507-04100	1	SHIM T=0.5	1		011295@	A
4	F1805-10025		BOLT,W/WASHER B/W	8			

Part not to be Supplied. See(3).

See(8)-(a)Description Codes.

See(8)-(c)Specification codes.

See(8)-(b)Description.

See(2)Reference number.

See(6)Change codes.

See(4)Interchangeability codes.

See(5)Sequence-of-change numbers.

Quantity per unit.

Applicable from serial No. indicated.

Applicable from 011295 (Scheduled)if suffixed with @ and sometimes differs from real serial No.

Applicable up to serial No. indicated.

High-demand part. See(11).

Part newly changed or added. See (12).

Applicable up to 011294 (Scheduled)if prefixed with @ and sometimes differs from real serial No.

NOTE:Some of model designations, number of variations and serial numbers, indicated above, are quoted from other parts catalogues.
Read these items of information as those for this parts catalogue.

NOTE: For the description of each item, refer to the pages which follow.

HOW TO USE THIS PARTS CATALOGUE

(to be referred to together with the former SAMPLE OF PARTS CATALOGUE)

(1)

01 CYLINDER HEAD

- 3-

REF. NO.	PART NO.	R/S P/O	C/N E/G	PART NAME & DESCRIPTION	MODEL & QTY			APPLICABLE SERIAL NO.		M/R	V/D
					S3L2			FROM	TO		
1	31B01-13040			HEAD ASSY, CYLINDER	1						
1 01	*			HEAD SUB ASSY, CYL	1						
1 02	MD000245			CAP. SEALING	1						
1 03	NF665538			CAP. SEALING	5						
1 04	31A01-01201			SEAT, INLET VALVE	3						

The items (1) thru (12) are as described below:

(1) Compiling system

The systems of a unit are grouped according to their location in the unit. The groups, each identified by group number, are listed in the order by CONTENTS. Each group is preceded by an "exploded view" which clearly illustrates each part in its correct relation to the other parts in the illustration.

(2) Reference number

Abbreviated to "REF. No.", this number is used to locate a part in the illustration. In cases that the reference number is of three to four digits, the first and second digits show the reference number of an assembly, and the last two digits show the numbers of its component parts.

(3) Part numbers

The part numbers shown in this parts catalogue are those assigned to genuine Mitsubishi parts.

NOTE: Parts with asterisk (*) are not supplied individually.

(4) Interchangeability codes

The interchangeability codes used in this parts catalogue are as follows:

PART NO.	Code (R / P)	DESCRIPTION
A(Old) B(New)	R	B(new part) and A(old part) are mutually interchangeable
A(Old) B(New)	1	A(Old part) is not supplied. B(new part) can be substituted for A(Old part).
A(Old) B(New)	3	B(new part) can be substituted for A(old part). [A(old part) cannot be substituted for B(new part).]
A(Old) B(New)	N	B(new part) and A(old part) are not interchangeable.
A(Old) B(New)	G	B(new part) can be substituted for A(old part) in combination with other part(s). (For the parts to be combined, refer to the listing beginning with the page E1 at the end of this parts catalogue.)

(5) Sequence-of-change numbers

The parts are changed for improved quality or performance. Their changes are indicated in sequence by numerals (1, 2, 3...)

Blank : Original

1 : 1st change

2 : 2nd change

3 : 3rd change

(6) Change codes

These codes indicate the reason or purpose of changes of the parts.

A : Added part (a part entered into service)

C : Change of part number

D : Deleted part (a part applicable up to the serial no. expressed in Serial No. column)

E : Added part except above reasons

Q : Change of quantity

(7) Part name

Abbreviations are sometimes used. For the abbreviations, refer to TABLE OF SYMBOLS & ABBREVIATIONS appeared in hind pages of this general information chapter.

NOTE: The location terms LH (left hand) and RH (right hand) are as these directions viewed from the flywheel side of an engine.

(8) Description & Abbreviation codes

(a) Description codes (expressed in the first part of Description column).

B/W: Assembled bolt (with washer)

KIT: Part supplied as a kit

STD: Standard part

OPT: Optional part

AR : Part used, as required or by selection or in adjust quantity for necessity

SFN: Semi-finished part

(b) The Description codes in above paragraph (a) are followed by supplementary explanation such as dimensions (thickness, length, etc.) ,manufacturer part number, manufacturer name, etc. as occasion demands.

NOTE: Unless otherwise indicated, the dimensions are shown in millimeter and the name of unit is abbreviated.

(Examples) Thickness: T=1.00 Length: L=1000

Width: W=1500 Height: H=500

(c) Specification codes

Each specification or type of model, and selective specifications of a unit are indicated by codes of three digits. For these codes, refer to LIST OF SPECIFICATION CODES appeared in hind pages of this general information chapter.

NOTE: Unless indicated by the specification codes, the parts may be used for the products of all specifications.

(Examples) A10: For diesel fuel
B10: With industrial electric starter

- (d) The parts indicated as "NOT SHOWN", such as component parts of overhaul gasket kit, are not shown in the illustration.

(9) Model & quantity

- (a) Model : Model, type, specification, destination, etc. of product to which a parts catalogue applies are indicated in the title column of each variation.
- (b) Quantity : Quantity of part or assembly, and its component parts required for one unit of product is indicated.

NOTE : In case "AR" appears in QTY column, it is required to adjust quantity for use.

(10) Applicable serial numbers

Applicable serial numbers of engine are indicated in the "UPTO" or "FROM" column. Serial numbers with "@" are scheduled ones and sometimes differ from the real serial numbers. If the "FROM" column is blank, the part is applicable to serial number shown on this cover and up.

(11) Management rank

The parts ranked as "A" are high-demand parts. This ranking is to be referred to by dealers, and is devised to facilitate and rationalize their distribution, stocking and inventory of the parts.

- (12) The parts changed or added after the last parts list that has been published are identified by "V."

TABLE OF SYMBOLS & ABBREVIATIONS

SYMBOL	DESCRIPTION	SYMBOL	DESCRIPTION
ACCEL	ACCELERATOR	ELEC	ELECTRIC
ADJ	ADJUSTING (ADJUSTABLE)	ENG	ENGINE
AIR-CON	AIR-CONDITIONER	EQUIP	EQUIPMENT
ASSY	ASSEMBLY	EXH	EXHAUST
ATT	ATTACHMENT	E/TNK	EXPANSION TANK
AUTO	AUTOMATIC	FITT	FITTING
AUX	AUXILIARY	FLEX	FLEXIBLE
AR	AS REQUIRED	FR	FRONT
B/H	BACKHOE	GSKT	GASKET
BATT	BATTERY	GEN	GENERATOR
BRG	BEARING	GOV	GOVERNOR
B/PMP	BILGE PUMP	G/N	GROUP NUMBER
BRKT	BRACKET	H/EXCH	HEAT EXCHANGER
BUSH	BUSHING	HEX	HEXAGON
CARB	CARBURETOR	HYD	HYDRAULIC
C/L	CENTERLINE	H=	HEIGHT
COMPR	COMPRESSOR	IND	INDUSTRIAL
CON-ROD	CONNECTING-ROD	INJ	INJECTION
C/MBR	CROSS-MEMBER	INSTAL	INSTALLATION
CYL	CYLINDER	INST	INSTRUMENT
DIA	DIAMETER	INTLK	INTERLOCK
DIFF	DIFFERENTIAL	JUNC	JUNCTION
DISTR	DISTRIBUTOR	KD	KNOCKDOWN
DR	DRIVE	L.H	LEFT HAND
D=	OUT DIAMETER	LUB	LUBRICATION
		L=	LENGTH

TABLE OF SYMBOLS & ABBREVIATIONS

SYMBOL	DESCRIPTION	SYMBOL	DESCRIPTION
MANF	MANIFOLD	STD	STANDARD
MAX	MAXIMUM	SUPT	SUPPORT
M.L.H	MAXIMUM LIFTING HEIGHT	SYM	SYMBOL
MIN	MINIMUM	SYNCH	SYNCHRONIZER
MTR	MOTOR	SYS	SYSTEM
MTG	MOUNTING	TEMP	TEMPERATURE
NO.	NUMBER	TERM	TERMINAL
OPT	OPTION	T/CONV	TORQUE-CONVERTER
O/D	OVER DRIVE	T/F	TRANSFER
O.S	OVERSIZE	T/M	TRANSMISSION
PTO	POWER TAKE-OFF	T/HSG	TURBINE-HOUSING
P/S	POWER STEERING	T/C	TURBOCHARGER
PRESS	PRESSURE	T=	THICKNESS
P/N	PART NUMBER	U/BODY	UNDERBODY
QTY	QUANTITY	U.S	UNDERSIZE
		UNIV	UNIVERSAL
RAD	RADIATOR	VAC	VACUUM
RE	REAR	VENT	VENTILATOR
REG	REGULATOR	W/STRIP	WEATHERSTRIP
REV	REVERSE	W/	WITH
R.H	RIGHT HAND	W/O	WITHOUT
REF.NO.	REFERENCE	W/W	WOODWARD
R/N	REFERENCE	W/PMP	WATER PUMP
S/PMP	SEA WATER PUMP	W=	WIDTH
SECT	SECTION	Z=	NUMBER OF GEAR TEETH
S/MBR	SIDEMEMBER		

TABLE OF SYMBOLS & ABBREVIATIONS

SYMBOL	DESCRIPTION	SYMBOL	DESCRIPTION
1ST	FIRST		
2ND	SECOND		
3RD	THIRD		
4TH	FOURTH		
5TH	FIFTH		
&	AND		
@	UNCONFIRMED		
*	PART NOT TO BE SUPPLIED		

MEMO

A series of horizontal dotted lines for writing, bounded by solid lines at the top and bottom.

CONTENTS

GROUP NO.	GROUP NAME	PAGE
ENGINE BODY		
01	CYLINDER HEAD	2
01-02	LIFTING EYE	4
04	VALVE MECHANISM	6
04-02	ROCKER COVER	8
05	CAMSHAFT & TAPPET	10
07-00-01	CRANKCASE	12
07-00-02	CRANKCASE	14
07-02	DRAIN COCK & PIPE	16
09	MAIN BEARING	18
11	TIMING GEAR CASE	20
12	FLYWHEEL HOUSING	22
13	OIL PAN	24
14	ENGINE SUPPORT	26
17	PISTON	28
19	CONNECTING-ROD	30
20	CRANKSHAFT & PULLEY	32
20-02	CRANK PULLEY	34
21	FLYWHEEL	36
23	TIMING GEAR	38
INLET & EXHAUST SYSTEM		
30	INLET SYSTEM	40
32	EXHAUST SYSTEM	42
OIL SYSTEM		
35	OIL PUMP	44
35-02	OIL STRAINER	46
36	OIL SYSTEM	48
40	OIL FILTER	50

GROUP NO.	GROUP NAME	PAGE
42	OIL FILLER & GAGE	52
43	BREATHER	54
COOLING SYSTEM		
45	WATER PUMP	56
45-02	WATER PUMP PULLEY	58
46	COOLING SYSTEM	60
48	FAN	62
48-02	FAN SPACER	64
49	V-BELT	66
FUEL SYSTEM		
61-00-01	FUEL SYSTEM	68
61-00-02	NOZZLE & NOZZLE HOLDER	70
62	FUEL FILTER	72
63	GOVERNOR	74
65-00-01	INJECTION PUMP	76
65-00-02	INJECTION PUMP	78
65-02	FUEL INJECTION PUMP DRIVE	80
STARTING SYSTEM		
66	STARTER (12V-1.7KW)	82
66-02	GLOW PLUG	84
68-00-01	ALTERNATOR	86
68-00-02	ALTERNATOR (12V-50A)	88
CONTROL SYSTEM		
87	ENGINE CONTROL	90
INSTRUMENT		
90	INSTRUMENT	92
ACCESSORY		
92	ACCESSORY	94

GROUP NO.	GROUP NAME	PAGE
REPAIR PARTS		
94	OVERHAUL GASKET KIT	96
	NUMERICAL PARTS INDEX	C1

MEMO

A series of horizontal dotted lines for writing, bounded by solid lines at the top and bottom.

01 CYLINDER HEAD

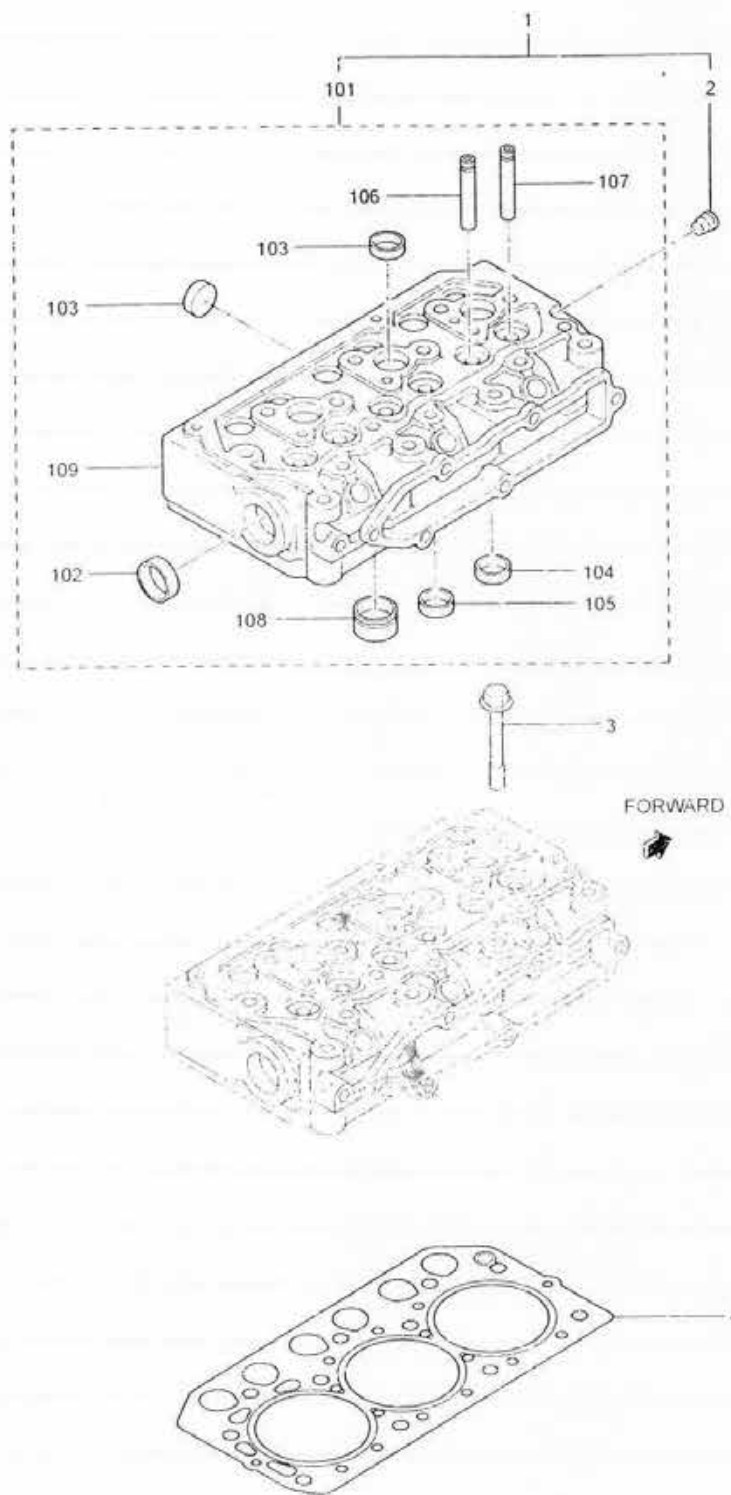

REF. -NO.	PART NO.	R P	S E Q	C N G	PART NAME & DESCRIPTION	MODEL & QTY			APPLICABLE SERIAL O.		M R D
						S3L2			FROM@-	-@UPTO	
1	31B01-13040				HEAD ASSY, CYLINDER	1					
1 01	*				HEAD SUB ASSY, CYL	1					
1 02	MD000245				CAP, SEALING	1					
1 03	MF665538				CAP, SEALING	5					
1 04	31A01-01201				SEAT, INLET VALVE	3					
1 05	31A01-01301				SEAT, EXHAUST VALVE	3					
1 06	31A01-02500				GUIDE, EXHAUST VALVE	3					
1 07	31A01-02800				GUIDE, INLET VALVE	3					
1 08	31A03-13600				JET, COMBUSTION	3					
1 09	*				HEAD, CYLINDER	1					
2	MS661140				PLUG, TAPERED	1					
3	31A01-11101				BOLT, CYLINDER HEAD	11					
4	31B01-23200				GASKET, CYLINDER HEAD	1					

01-02 LIFTING EYE

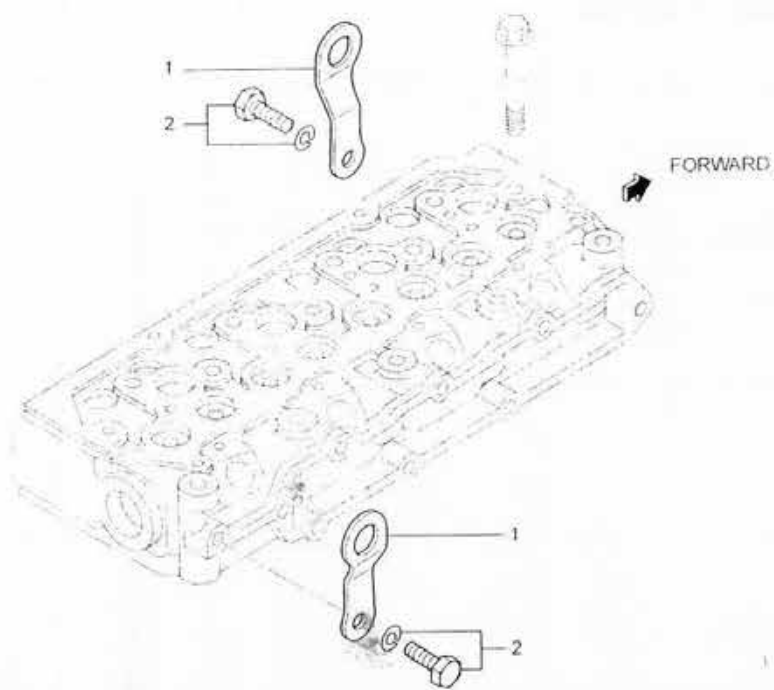

REF -NO.	PART NO.	R P	S E N G	PART NAME & DESCRIPTION	MODEL & QTY			APPLICABLE SERIAL NO.		M R	V R D
					S3L2			FROM@-	@UPTO		
1	MM408470			HANGER, ENGINE	2						
2	MF241280			BOLT. W/WASHER	2						

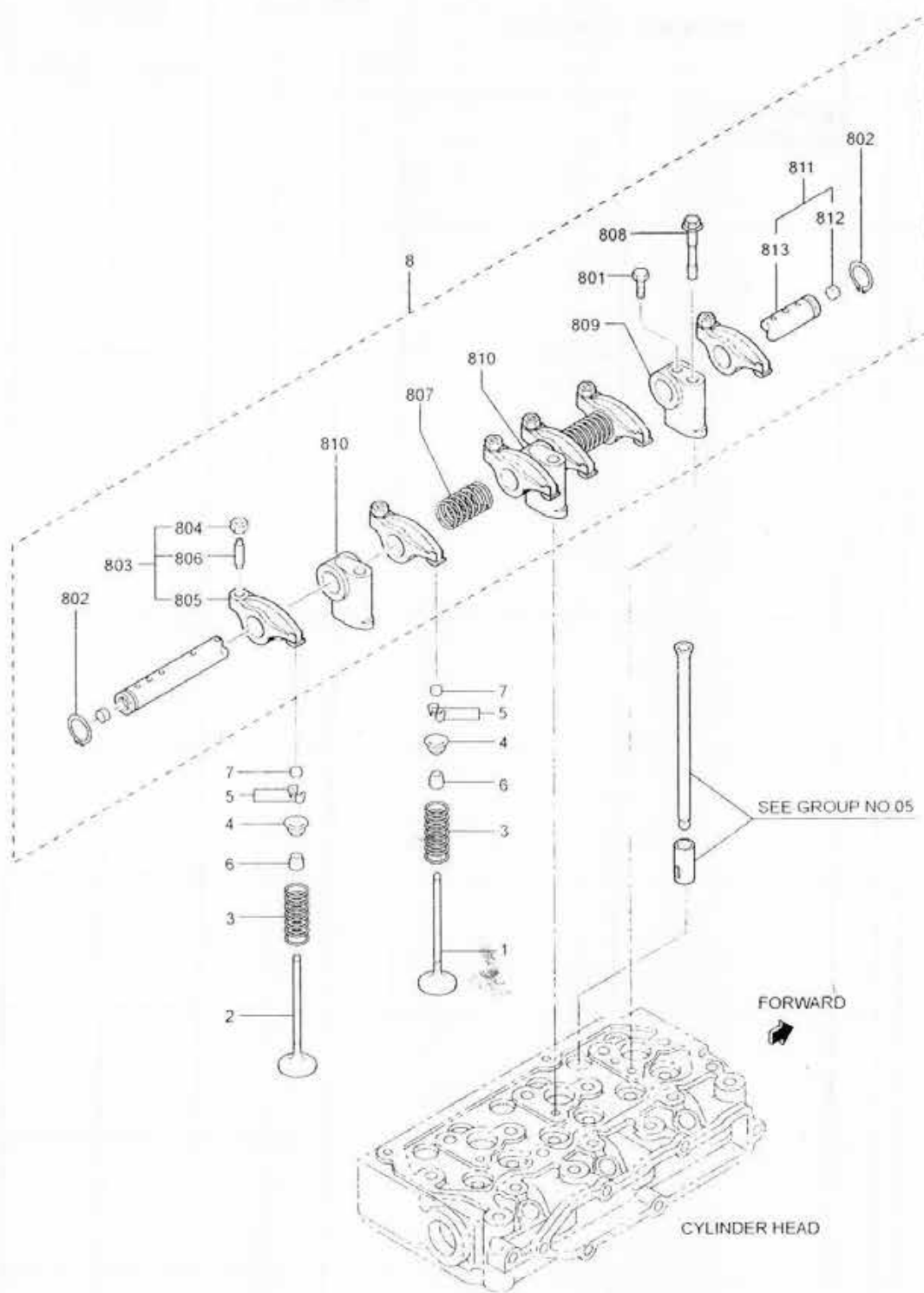

REF NO 5 IS COMES IN PAIRS.

REF -NO.	PART NO.	R P	S E N G	PART NAME & DESCRIPTION	MODEL & QTY			APPLICABLE SERIAL NO.		M R	V R D
					S3L2			FROM@-	-@UPTO		
1	31A04-10400			VALVE, INLET	3						
2	31A04-10500			VALVE, EXHAUST	3						
3	31A04-01301			SPRING, VALVE	6						
4	MM433-30601			RETAINER, VALVE STEM	6						
5	MDO16483			VALVE LOCK, SPRING	12						
6	MD115472			SEAL, VALVE STEM	6						
7	31A04-00700			CAP, VALVE STEM	6						
8	31B04-00014			ROCKER & SHAFT ASSY	1						
8 01	F1035-05010			BOLT	1						
8 02	MF522010			RING, SNAP	2						
8 03	31A04-11024			ROCKER ASSY	6						
8 04	F2325-08000			NUT, JAM	6						
8 05	*			ROCKER ARM	6						
8 06	32A04-02401			SCREW, ROCKER	6						
8 07	32C04-04501			SPRING, ROCKER	2						
8 08	32C04-06101			BOLT, ROCKER BRACKET	3						
8 09	31A04-34100			BRACKET, ROCKER SHAFT	1						
8 10	31A04-34300			BRACKET, ROCKER SHAFT	2						
8 11	31B04-01010			SHAFT ASSY, ROCKER	1						
8 12	*			CAP, SEALING	2						
8 13	*			SHAFT, ROCKER	1						

04-02 ROCKER COVER

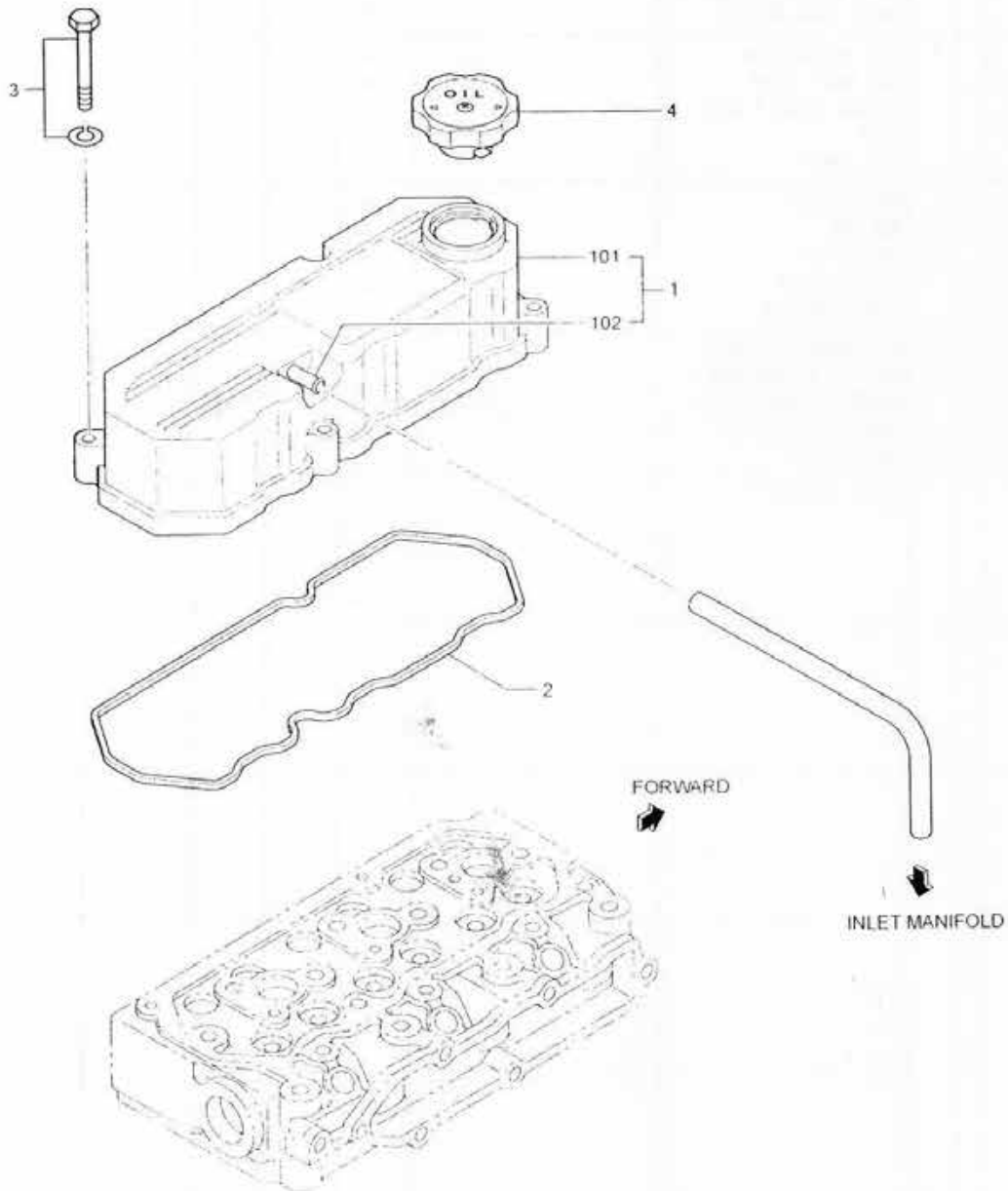

REF -NO.	PART NO.	R / P	S E N G Q	PART NAME & DESCRIPTION	MODEL & QTY			APPLICABLE SERIAL NO.		M / R D
					S3L2			FROM@-	-@UPTO	
1	31B04-03011			COVER ASSY, ROCKER	1					
1 01	*			COVER, ROCKER	1					
1 02	*			PIPE, BREATHER	1					
2	31B04-13201			GASKET, ROCKER COVER	1					
3	MF241261			BOLT, W/WASHER	4					
4	MD008784			CAP, OIL FILLER	1					

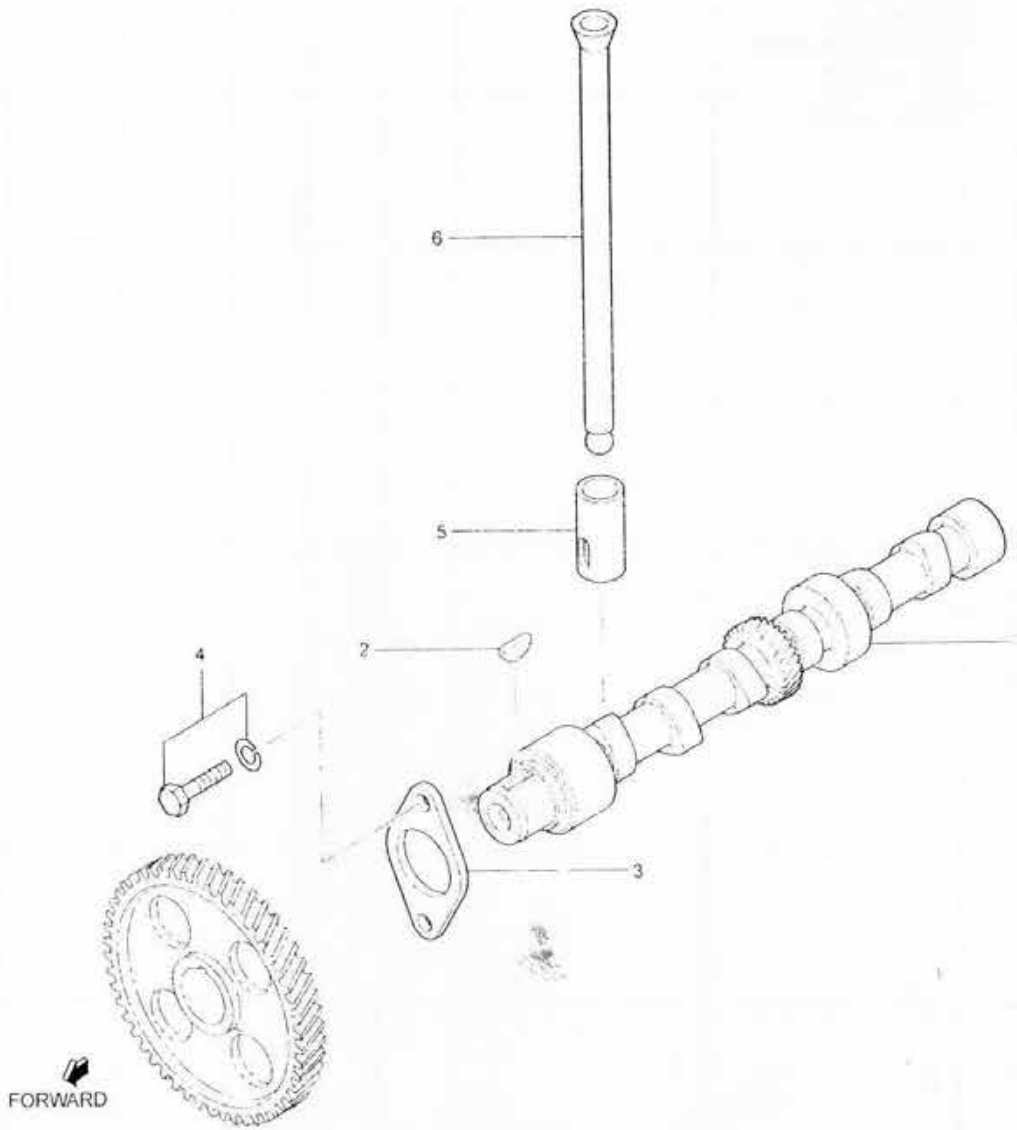

REF. -NO.	PART NO.	R P	S E Q	C N G	PART NAME & DESCRIPTION	MODEL & QTY			APPLICABLE SERIAL NO.		M R	V R D
						S3L2			FROM@-	-@UPTO		
1	31B05-00103				CAMSHAFT	1						
2	MF476215				KEY, WOODRUFF	1						
3	30405-31403				PLATE, THRUST	1						
4	MF240051				BOLT, W/WASHER	2						
5	31A05-00300				TAPPET	6						
6	31A05-01300				ROD, PUSH	6						

07-00-01 CRANKCASE

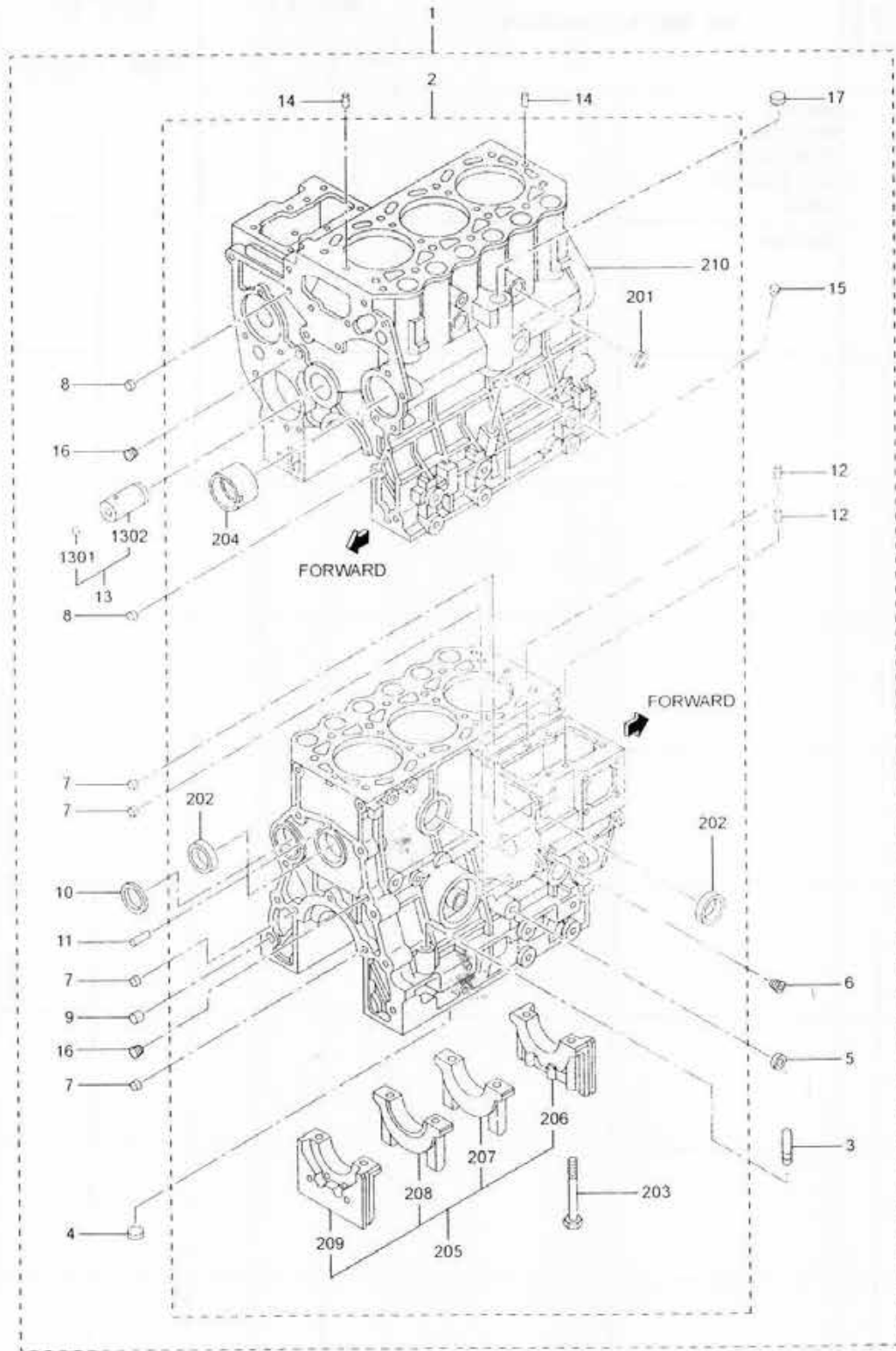

REF. -NO.	PART NO.	R P	S E Q	C N G	PART NAME & DESCRIPTION	MODEL & QTY			APPLICABLE SERIAL NO.		M R	V R D
						S3L2			FROM@-	@UPTO		
1	31B07-52010				BLOCK ASSY, CYLINDER	1						
2	*				CRANKCASE SUB ASSY	1						
2 01	04826-22000				CAP, SEALING	2						
2 02	04826-23500				CAP, SEALING	2						
2 03	31A07-00801				BOLT, BEARING CAP	8						
2 04	31A07-03100				BUSHING, CAMSHAFT	1						
2 05	*				CAP SET, BEARING	1						
2 06	*				CAP, BEARING FRONT	1						
2 07	*				CAP, BEARING NO. 2	1						
2 08	*				CAP, BEARING NO. 3	1						
2 09	*				CAP, BEARING REAR	1						
2 10	*				BLOCK, CYLINDER	1						
3	MM430613				GUIDE, OIL LEVEL GAGE	1						
4	MF665532				CAP, SEALING	1						
5	MF665533				CAP, SEALING	1						
6	MS661140				PLUG, TAPERED	1						
7	MS471104				BUSHING, KNOCK	4						
8	MS471105				BUSHING, KNOCK	2						
9	MS471110				BUSHING, KNOCK	1						
10	MF665511				PLUG, EXPANSION	1						
11	MF472404				PIN, DOWEL	1						
12	MM409645				PIN, DOWEL	2						
13	31A23-00051				SHAFT ASSY, IDLER	1						
13 01	F8000-08000				BALL, STEEL BEARING	1						
13 02	*				SHAFT, IDLER	1						
14	F2846-05000				PIN, DOWEL	2						
15	MD024256				PLUG, TAPERED	1						
16	04827-90130				PLUG, TAPERED	2						
17	MF665537				CAP, SEALING	1						

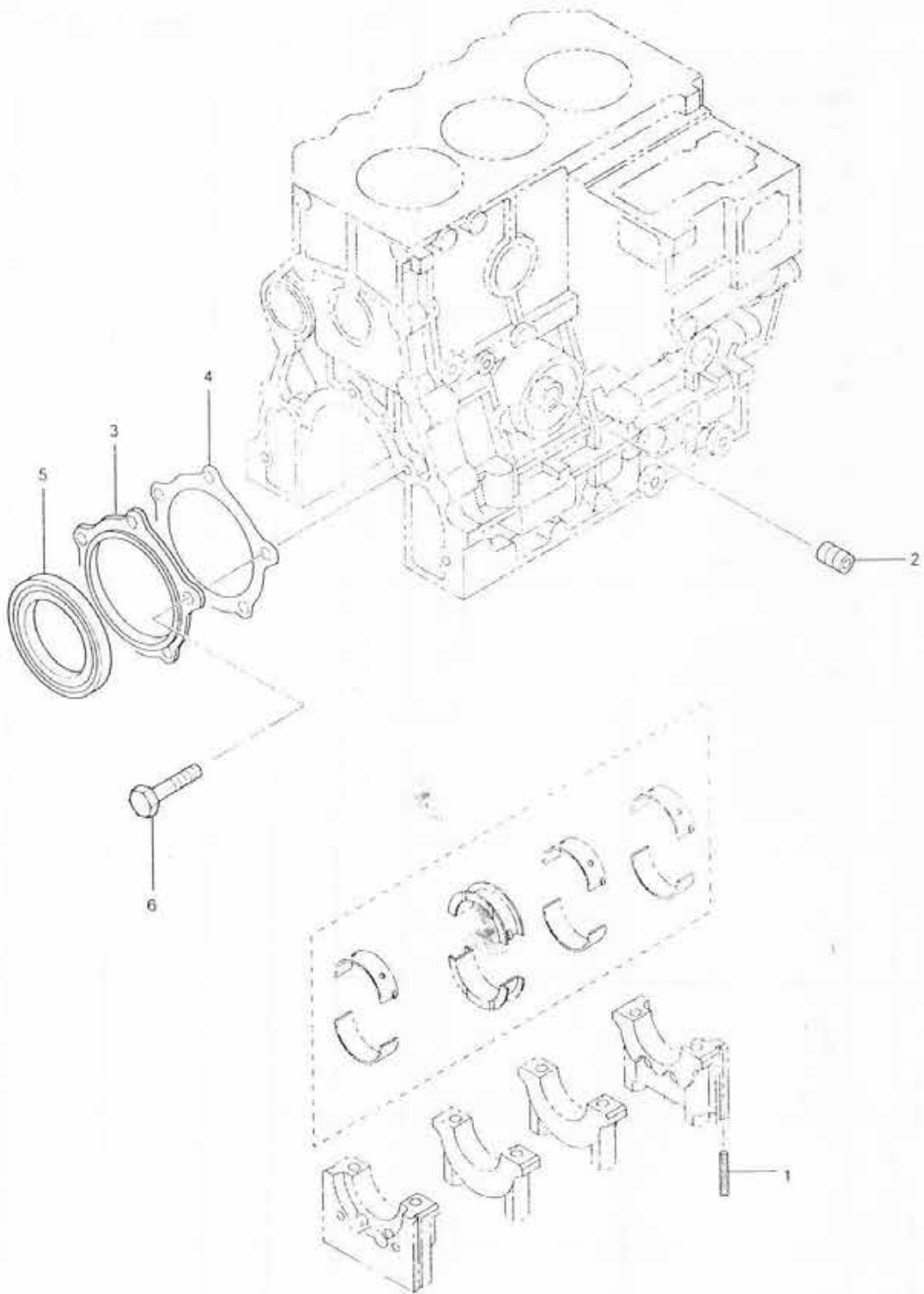

REF. -NO.	PART NO.	R / P	S E N G P O	PART NAME & DESCRIPTION	MODEL & QTY			APPLICABLE SERIAL NO.		M / R D
					S3L2			FROM@-	@UPTO	
1	31A07-12200			SEAL, SIDE	4					
2	30L07-00700			SHAFT, OIL FILTER	1					
3	31A07-11601			CASE, OIL SEAL	1					
4	31A07-11701			GASKET, OIL SEAL CASE	1					
5	31A07-02300			SEAL, OIL	1					
6	MF100055			BOLT	5					

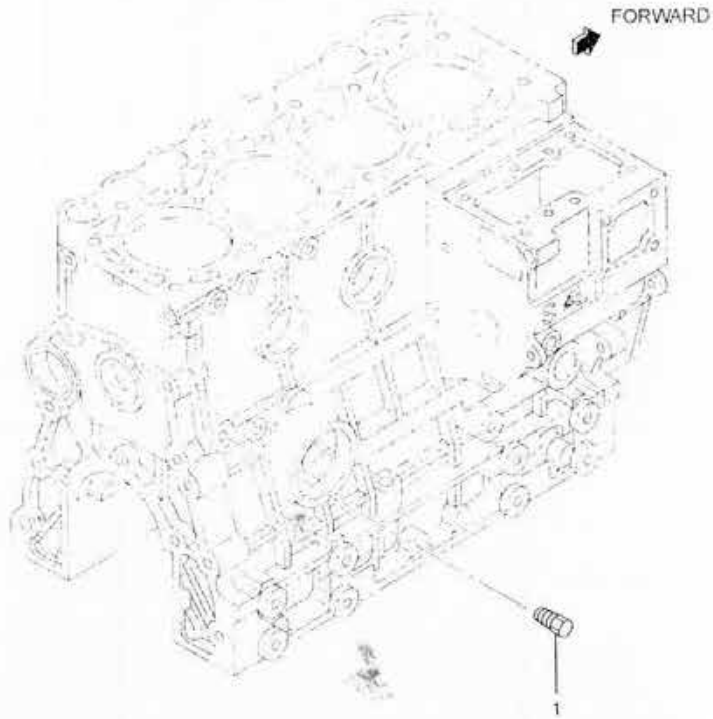

REF. NO.	PART NO.	R / P	S E N G	PART NAME & DESCRIPTION	MODEL & QTY			APPLICABLE SERIAL NO.		M / R	V / D
					S3L2			FROM@-	@UPTO		
1	MD000269			PLUG, TAPER	1						

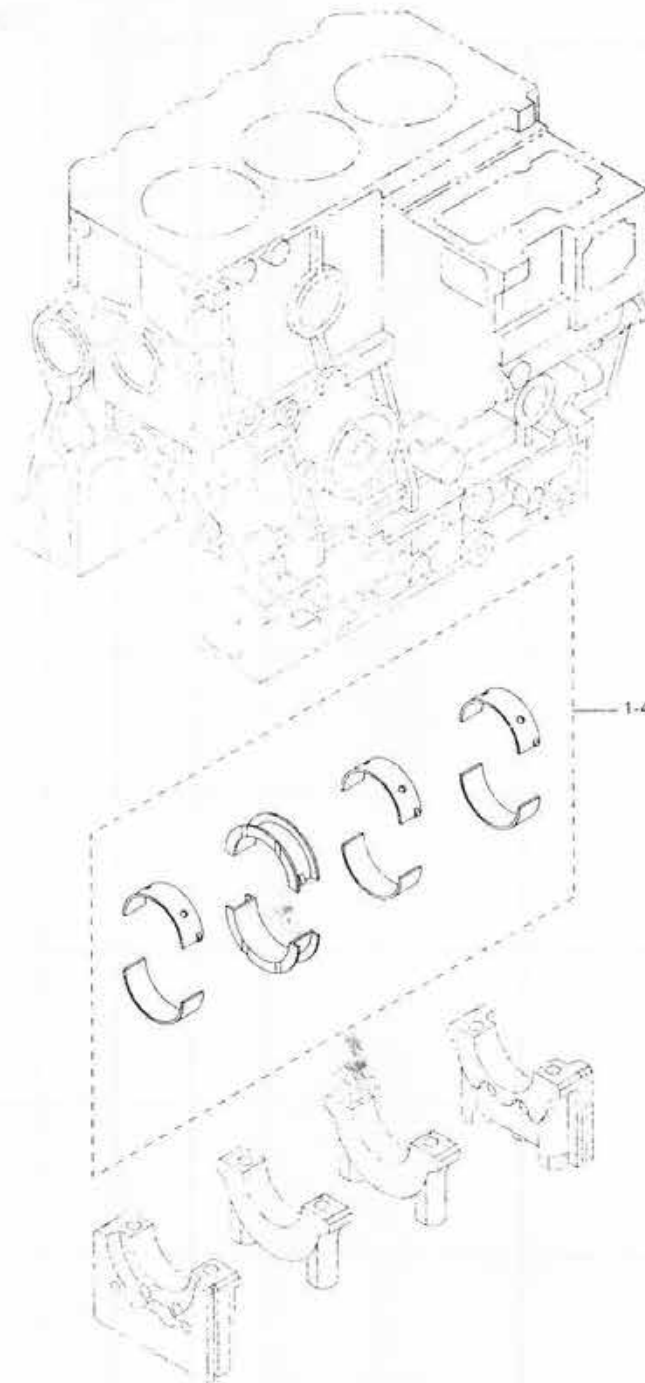

REF. -NO.	PART NO.	R / P	S E N G	PART NAME & DESCRIPTION		MODEL & QTY			APPLICABLE SERIAL NO.		M / R	V R D
						S3L2			FROM@-	@UPTO		
1	31A09-01010			BEARING SET, MAIN	STD	1						
2	31A09-01020			BEARING SET, MAIN	U. S 0. 25	1						
3	31A09-01030			BEARING SET, MAIN	U. S 0. 50	1						
4	31A09-01040			BEARING SET, MAIN	U. S 0. 75	1						

TIMING GEAR CASE

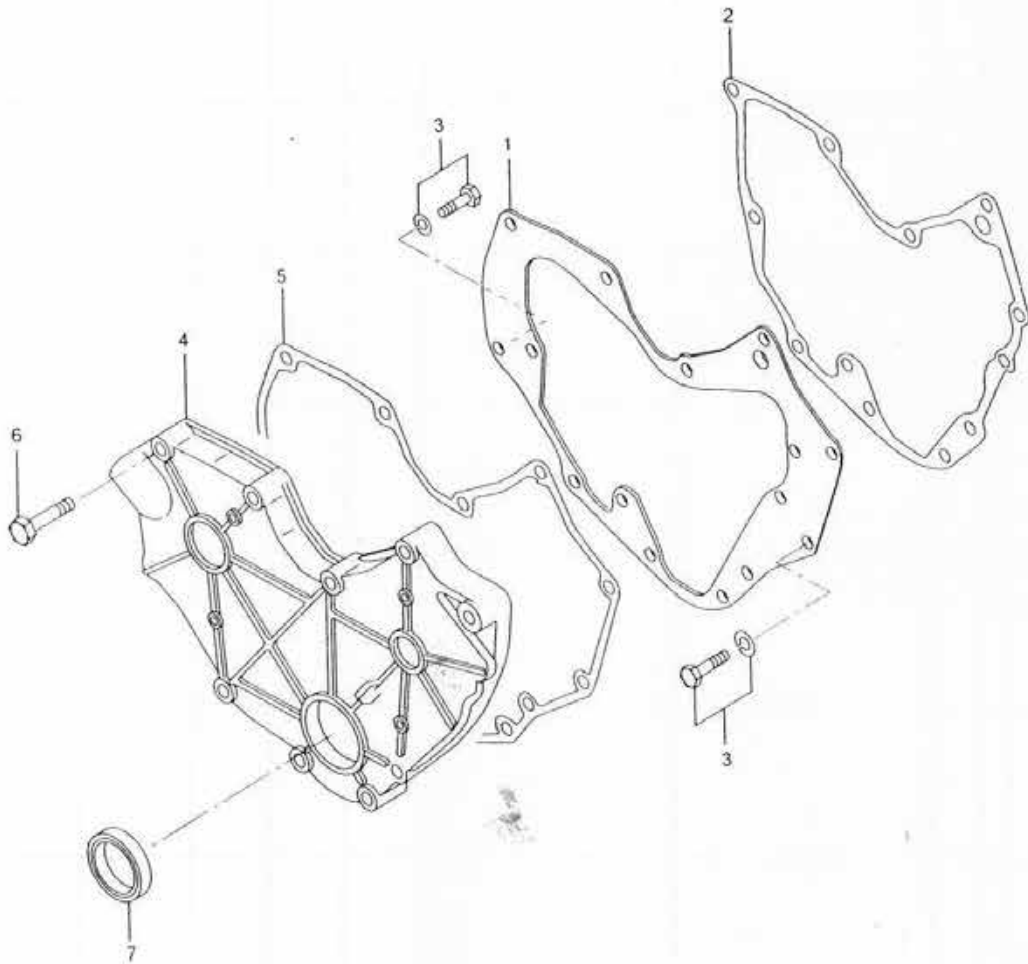

REF. -NO.	PART NO.	R / P	S E N G	PART NAME & DESCRIPTION	MODEL & QTY			APPLICABLE SERIAL NO.		M / R	V R D
					S3L2			FROM@-	-@UPTO		
1	31A11-02200			PLATE, FRONT	1						
2	31A07-11901			GASKET, FRONT PLATE	1					A	
3	MF240051			BOLT, W/WASHER	7					A	
4	31A11-00500			CASE, GEAR	1					A	
5	31A11-11200			GASKET, GEAR CASE	1					A	
6	MF100064			BOLT	8						
7	MD008762			SEAL, OIL	1					A	

FLYWHEEL HOUSING

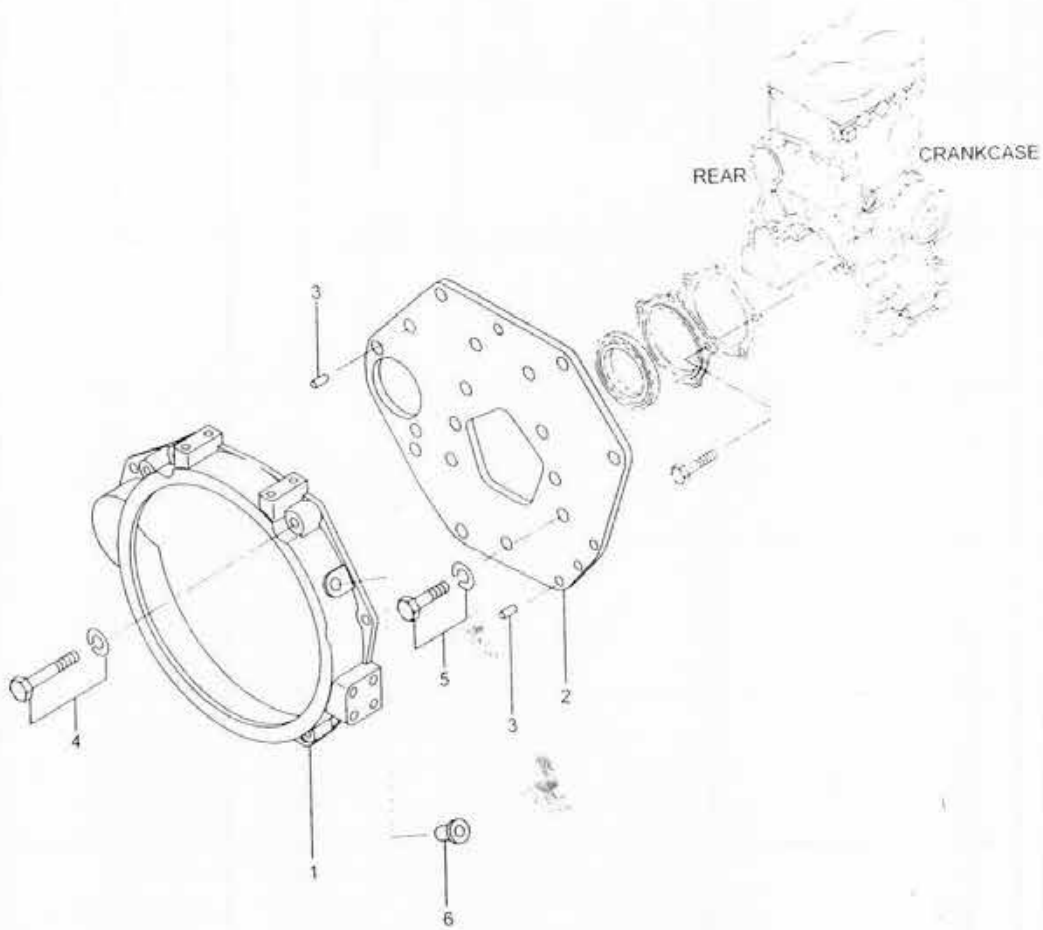

REF. -NO.	PART NO.	R P	S E N G	PART NAME & DESCRIPTION	MODEL & QTY			APPLICABLE SERIAL NO.		M R	V R D
					S3L2			FROM@-	@UPTO		
1	<u>30A12-01102</u>			HOUSING, FLYWHEEL	1						
2	31A07-04401			PLATE, REAR	1						
3	MM408245			PIN, KNOCK	2						
4	MF241315			BOLT, W/WASHER	2					A	
5	MF241308			BOLT, W/WASHER	13					A	
6	05534-16000			PLUG	1						

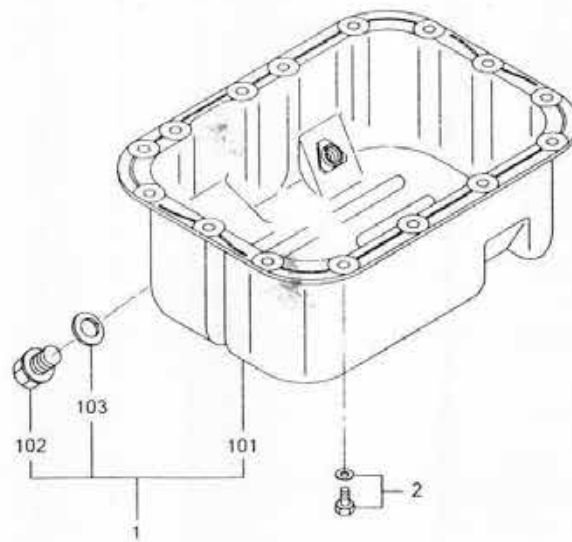
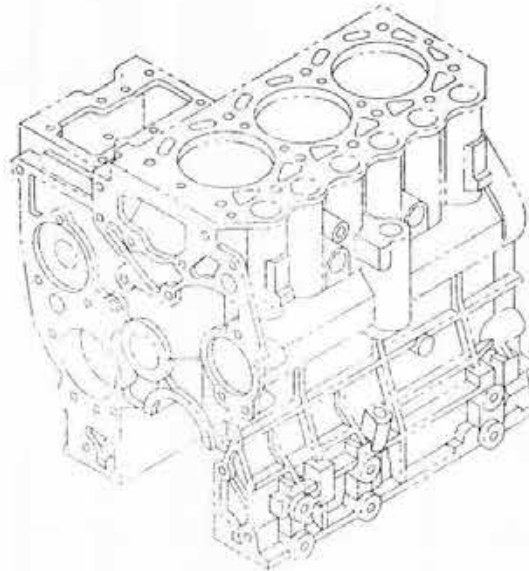

REF. -NO.	PART NO.	R / P	S E N G Q	PART NAME & DESCRIPTION	MODEL & QTY			APPLICABLE SERIAL NO.		M / R	V R D
					S3L2			FROM@-	@UPTO		
1	31B13-00013			PAN ASSY, OIL	1						
1 01	*			PAN, OIL	1						
1 02	MD050316			PLUG, DRAIN	1						
1 03	MD050317			GASKET, OIL DRAIN	1						A
2	MF240051			BOLT, W/WASHER	15						A

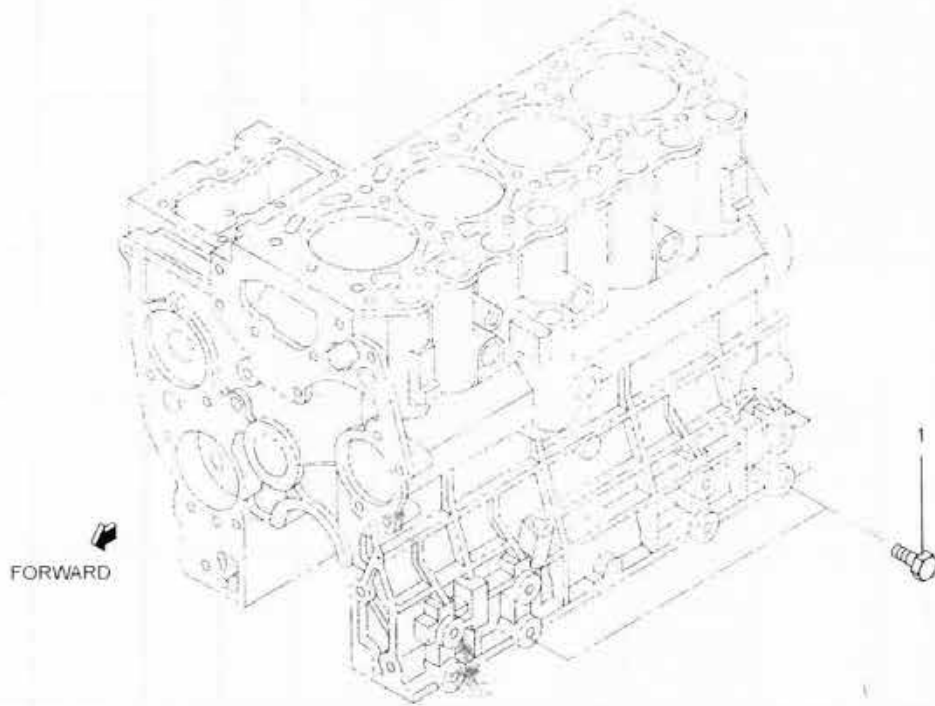

REF. -NO.	PART NO.	R / P	S E N G	PART NAME & DESCRIPTION	MODEL & QTY			APPLICABLE SERIAL NO.		M / R	V R D
					S3L2			FROM@-	@UPTO		
1	MF100110			BOLT	4						

PISTON

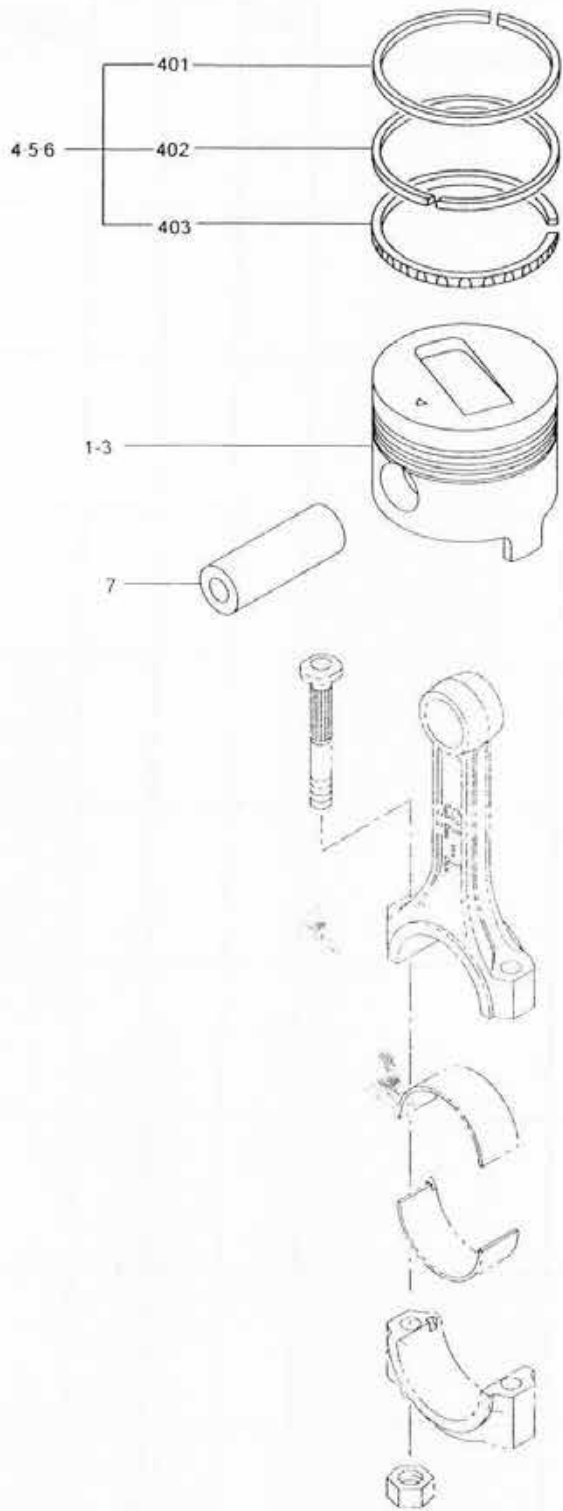

REF. -NO.	PART NO.	R P	S E N G	PART NAME & DESCRIPTION		MODEL & QTY			APPLICABLE SERIAL NO.		M R	V R D
						S3L2			FROM@-	@UPTO		
1	31A17-09100			PISTON	STD	3						
2	31A17-09200			PISTON	O. S 0. 25	3						
3	31A17-09300			PISTON	O. S 0. 50	3						
4	31A17-00010			RING SET, PISTON	STD	3						
4 01	*			RING, PISTON NO. 1		3						
4 02	*			RING, PISTON NO. 2		3						
4 03	*			RING ASSY, OIL		3						
5	31A17-00020			RING SET, PISTON	O. S 0. 25	3						
6	31A17-00030			RING SET, PISTON	O. S 0. 50	3						
7	31A17-10602			PIN, PISTON		3						

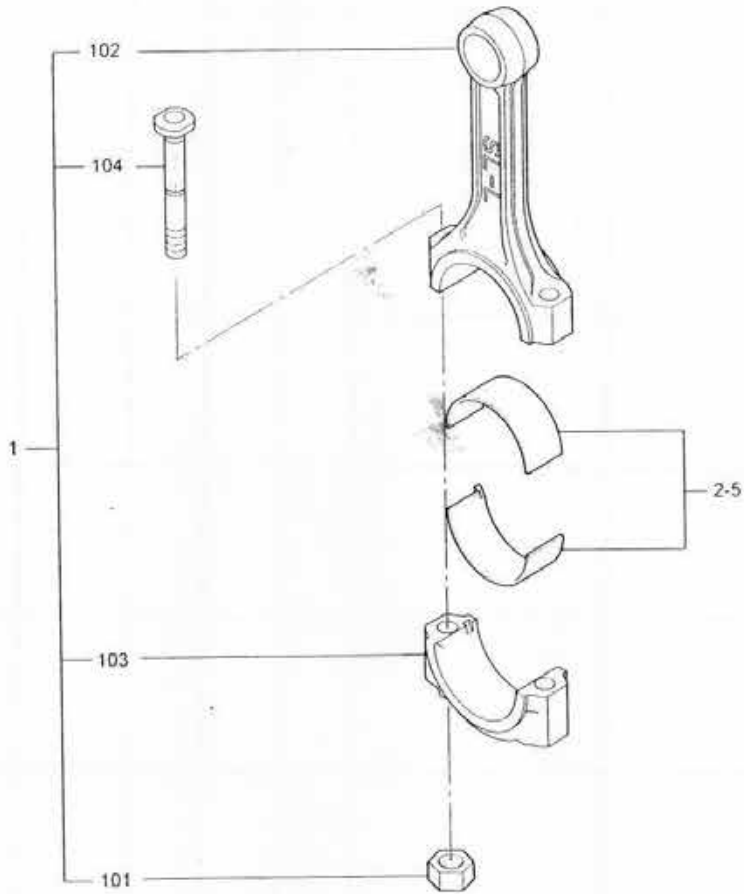
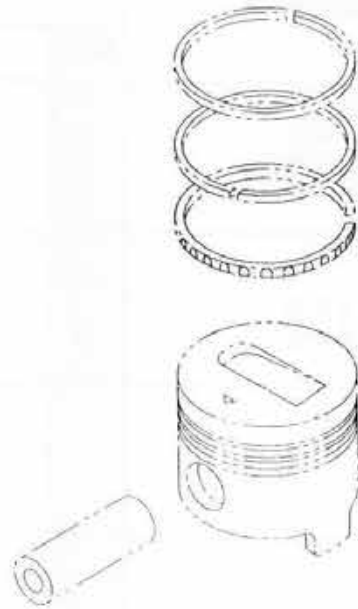

REF. -NO.	PART NO.	R P	S E N G	PART NAME & DESCRIPTION	MODEL & QTY			APPLICABLE SERIAL NO.		M R	V R D
					S3L2			FROM@-	-@UPTO		
1	31B19-01023			ROD ASSY, CONNECTING	3						
1 01	MD006704			NUT, CONNECTING-ROD	6						
1 02	MD021105			BOLT, CONNECTING-ROD	6						
1 03	*			CAP, CONNECTING-ROD	3						
1 04	*			CONNECTING-ROD	3						
2	30A19-00040			BEARING SET, CON-ROD	3						
3	30A19-10010			BEARING SET, CON-ROD	3						
4	30A19-10020			BEARING SET, CON-ROD	3						
5	30A19-10030			BEARING SET, CON-ROD	3						
				STD							
				U. S 0. 25							
				U. S 0. 50							
				U. S 0. 75							

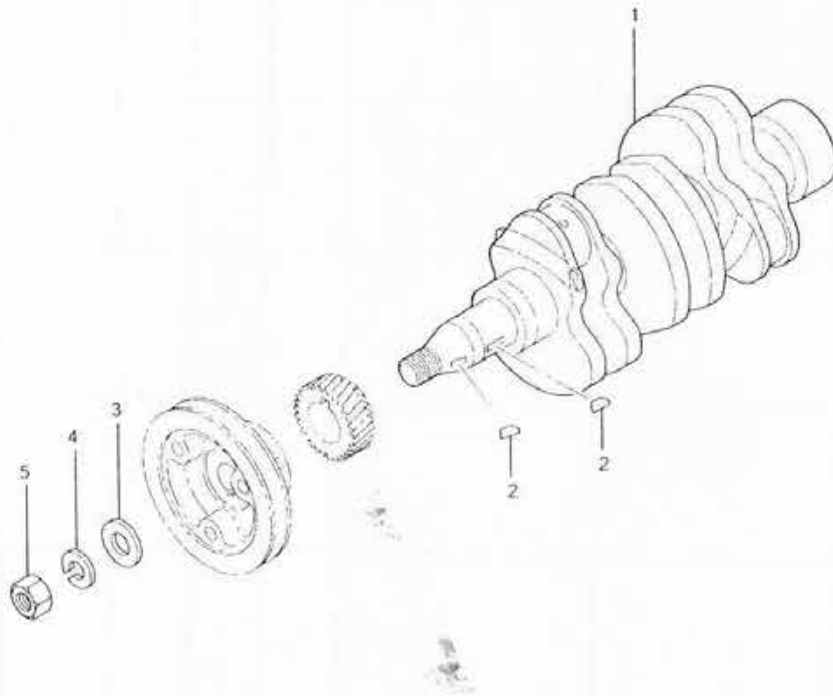

REF. -NO.	PART NO.	R / P	S E Q	C N G	PART NAME & DESCRIPTION	MODEL & QTY			APPLICABLE SERIAL NO.		M / R	V R D
						S3L2			FROM@-	-@UPTO		
1	31B20-00203				CRANKSHAFT	1						
2	MF476215				KEY, WOODRUFF	2						
3	MF450010				WASHER, PLAIN	1						
4	MF450410				WASHER, SPRING	1						
5	MF430126				NUT	1						

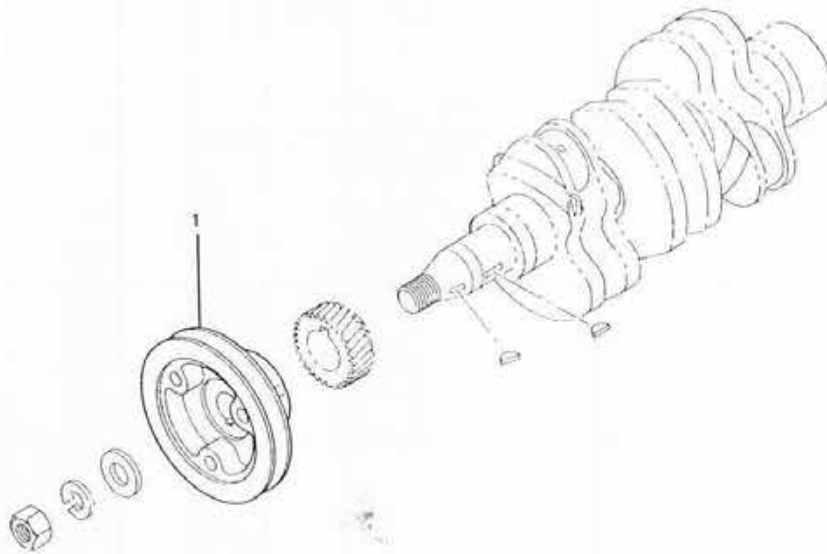

REF. -NO.	PART NO.	R / P	S E N G	PART NAME & DESCRIPTION	MODEL & QTY			APPLICABLE SERIAL NO.		M / R	V / D
					S3L2			FROM@-	-@UPTO		
1	31B20-02900			PULLEY, CRANKSHAFT	1						

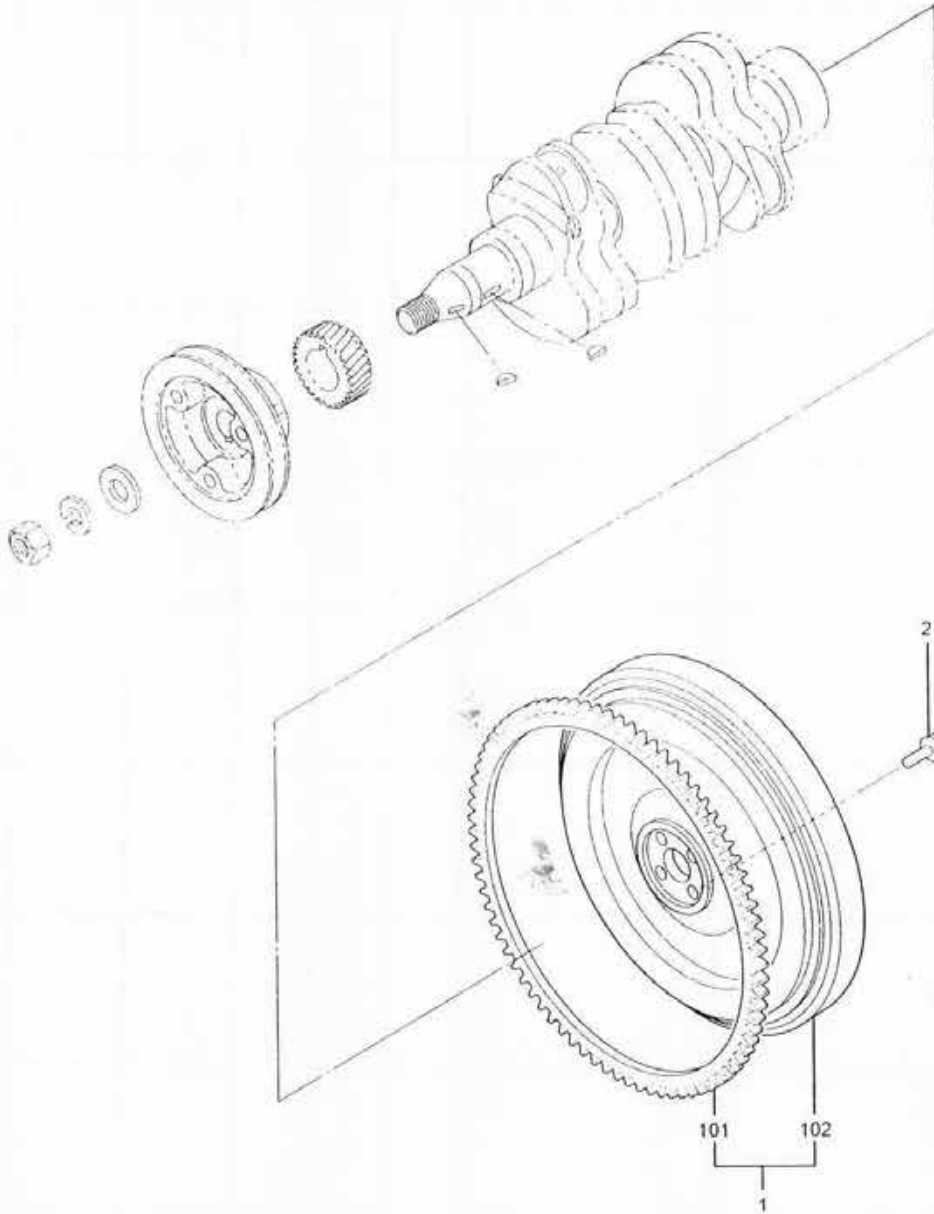

REF. -NO.	PART NO.	R P	S E Q	C N G	PART NAME & DESCRIPTION		MODEL & QTY			APPLICABLE SERIAL NO.		M R	V R D
							S3L2			FROM@-	-@UPTO		
1	31B21-01080				FLYWHEEL SUB ASSY		1						
1 01	*				GEAR, RING	Z=120	1						
1 02	*				FLYWHEEL		1						
2	31A21-03800				BOLT, DRIVE PLATE		4						

TIMING GEAR

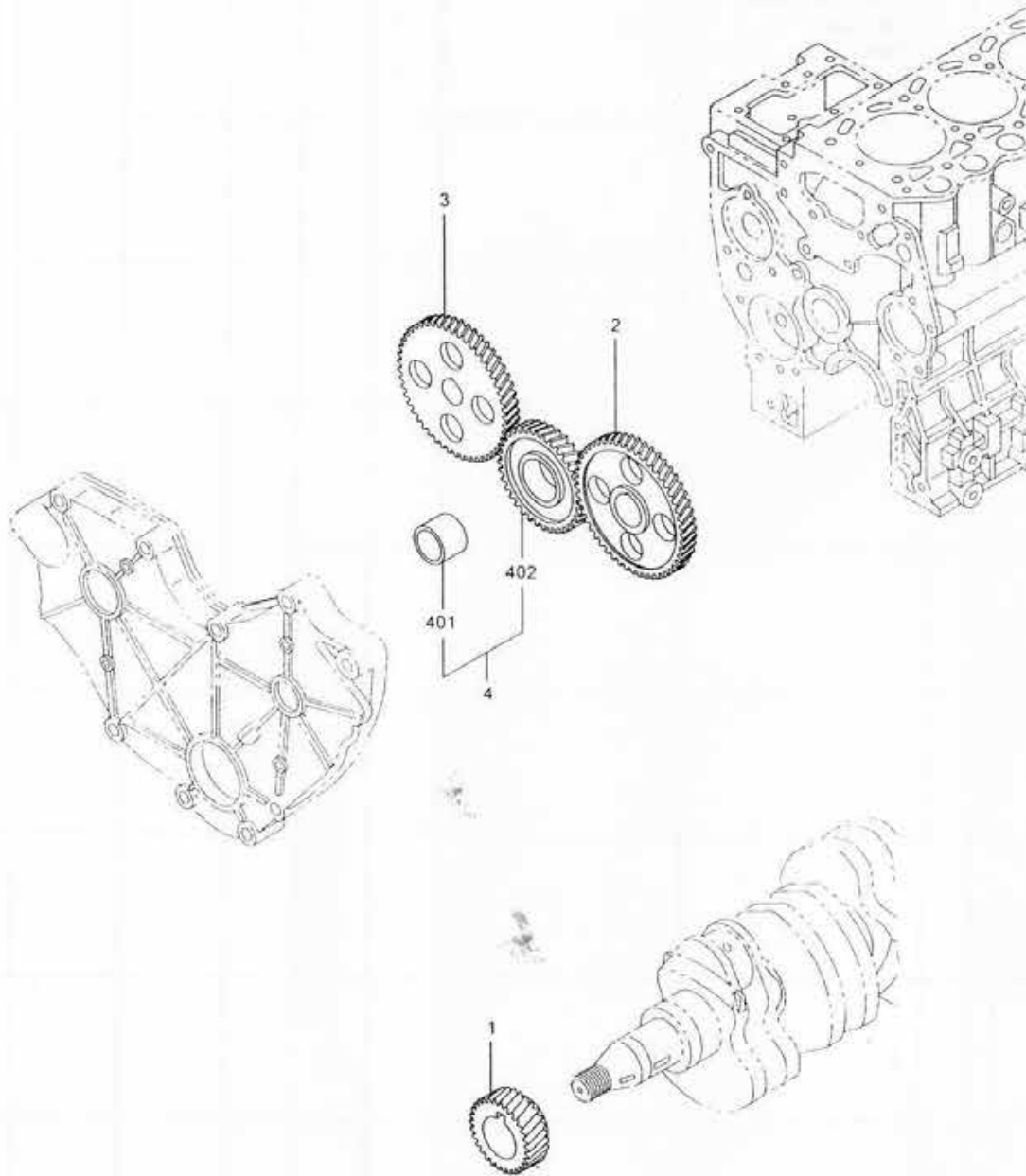

REF. -NO.	PART NO.	R P	S E Q	C N G	PART NAME & DESCRIPTION			MODEL & QTY			APPLICABLE SERIAL NO.		M R	V R D
					S3L2			FROM@-	-@UPTO					
1	31A23-01302				GEAR, CRANKSHAFT	Z=28		1						
2	31A23-01406				GEAR, CAMSHAFT	Z=56		1						
3	31A23-00800				GEAR, INJECTION PUMP	Z=56		1						
4	31A23-01023				GEAR ASSY, IDLER	Z=39		1						
4 01	31A23-00600				BUSHING, IDLER			1						
4 02	*				GEAR, IDLER			1						

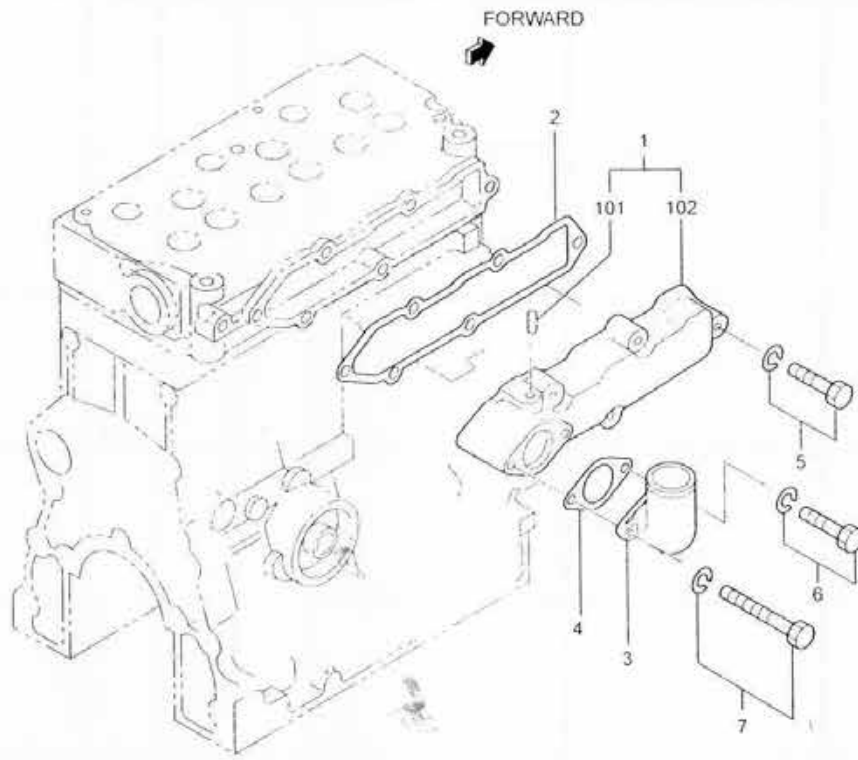

REF. -NO.	PART NO.	R / P	S E N G	PART NAME & DESCRIPTION	MODEL & QTY			APPLICABLE SERIAL NO.		M R	V R D
					S3L2			FROM@-	-@UPTO		
1	31B30-00040			COVER ASSY, INLET	1						
1 01	*			PIPE, BREATHER	1						
1 02	*			COVER, INLET	1						
2	31B30-00800			GASKET, INLET COVER	1						
3	31A30-00300			PIPE, INLET	1						
4	31A30-00801			GASKET, INLET PIPE	1						
5	MF241259			BOLT, W/WASHER	5						
6	MF241253			BOLT, W/WASHER	1						
7	MF241266			BOLT, W/WASHER	1						

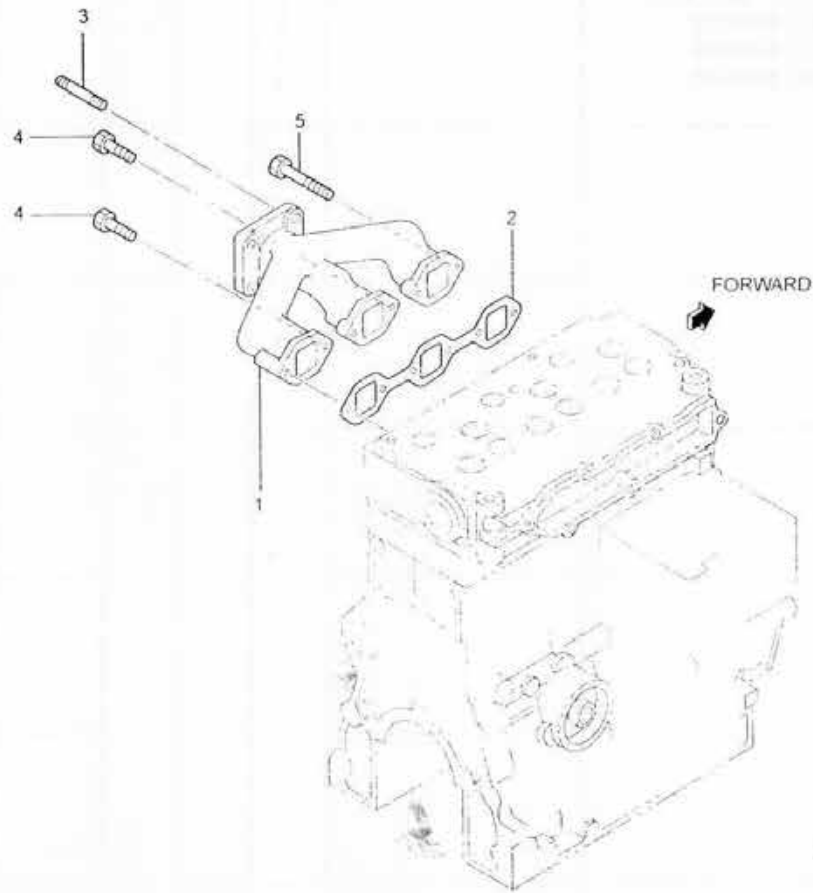

REF. NO.	PART NO.	R P	S E N G	PART NAME & DESCRIPTION	MODEL & QTY			APPLICABLE SERIAL NO.		M R	V R D
					S3L2			FROM@-	@UPTO		
1	31B32-00900			MANIFOLD, EXHAUST	1						
2	31B32-01200			GASKET, EXHAUST	1					A	
3	MF401936			STUD	4					A	
4	F1035-08020			BOLT	4					A	
5	MF101266			BOLT	2					A	

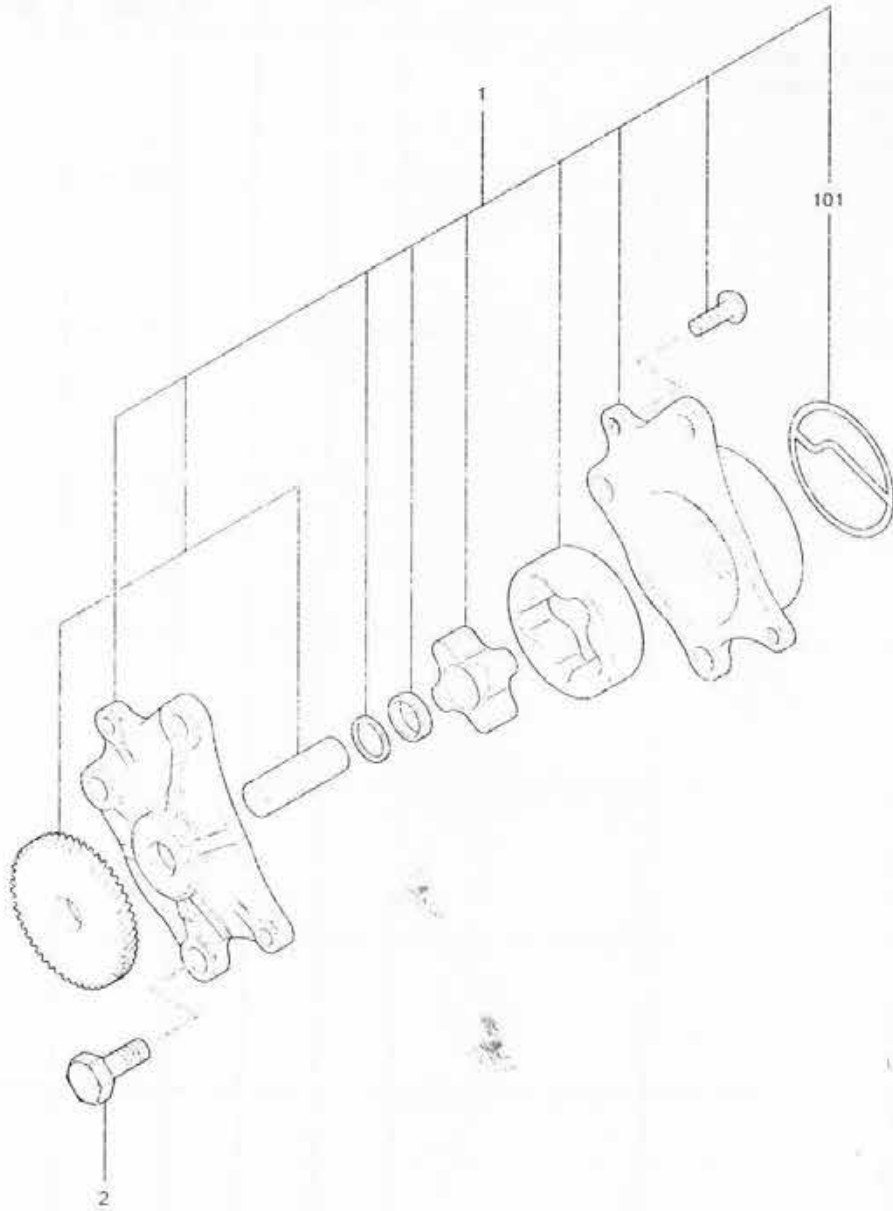

NOTE: The shaft and inner rotor and gear which are force fitted to each other are not to be supplied individually

REF. NO.	PART NO.	R P	S E P	C N G	MODEL & QTY			APPLICABLE SERIAL NO.		M R D
					S3L2			FROM@-	-@UPTO	
1	31A35-30010						1			
1	01 31A35-02300						1			
2	MF101256						3			

35-02 OIL STRAINER

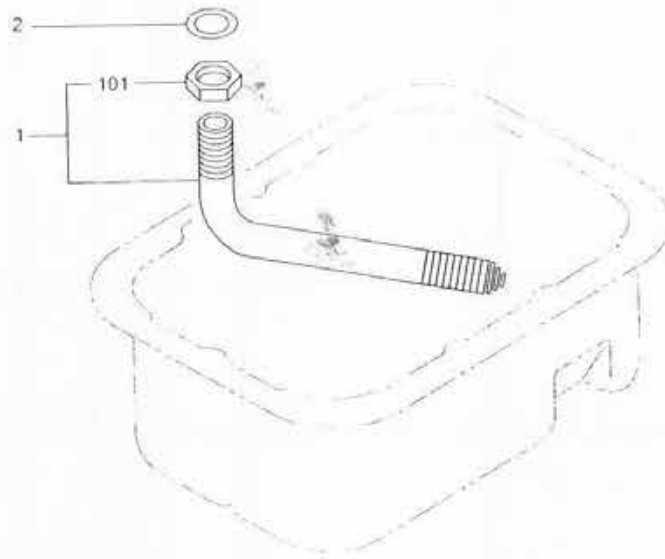

REF. -NO.	PART NO.	R P	S E O	C N G	PART NAME & DESCRIPTION	MODEL & QTY		APPLICABLE SERIAL NO.		M R	V R D
						S3L2		FROM@-	-@UPTO		
1	31A35-05040				STRAINER ASSY, OIL	1					
1 01	MF430729				NUT, JAM	1					
2	MF660036				GASKET	1					



REF. -NO.	PART NO.	R / P	S E N G P O G	PART NAME & DESCRIPTION	MODEL & QTY			APPLICABLE SERIAL NO.		M / R	V / R D
					S3L2			FROM@-	-@UPTO		
1	32A36-05012			VALVE ASSY. RELIEF	1						
2	34340-00700			GASKET	1						

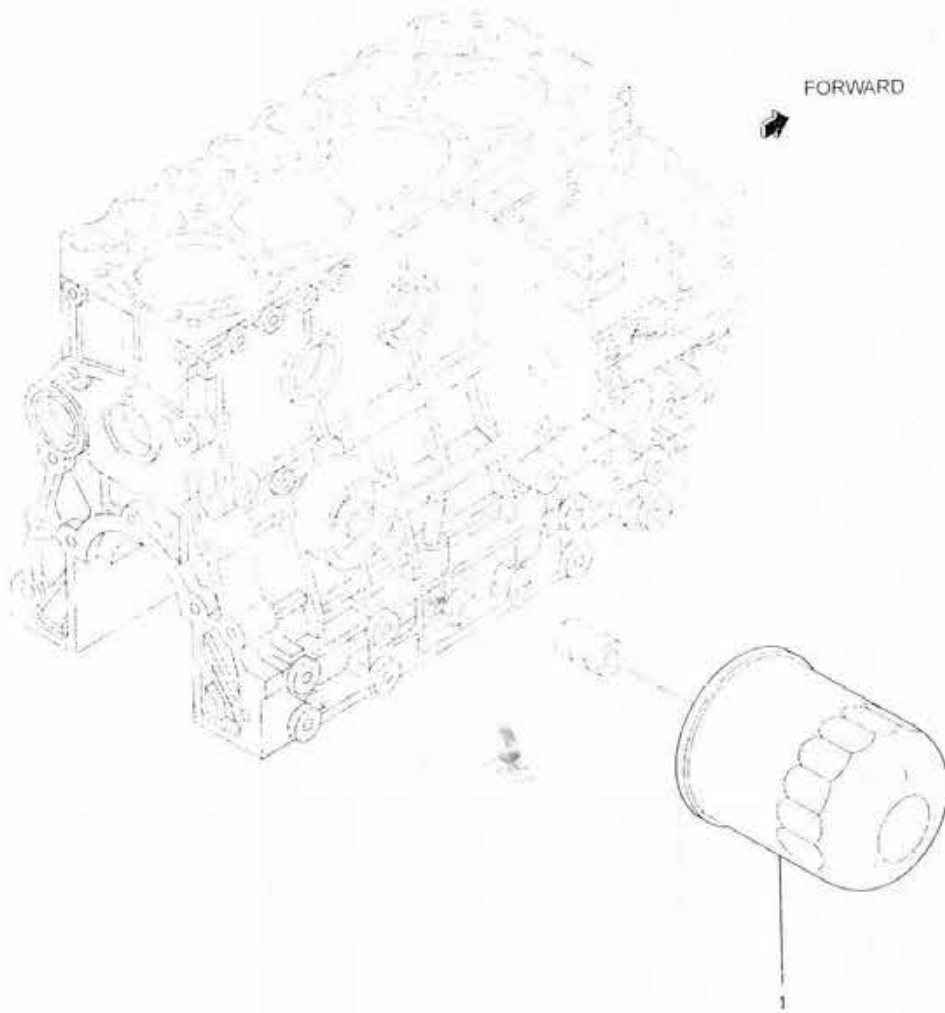

REF. -NO.	PART NO.	R P	S E N G	PART NAME & DESCRIPTION	MODEL & QTY			APPLICABLE SERIAL NO.		M R	V R D
					S3L2			FROM@-	@UPTO		
1	30A40-00105			FILTER ASSY. OIL	1					A	

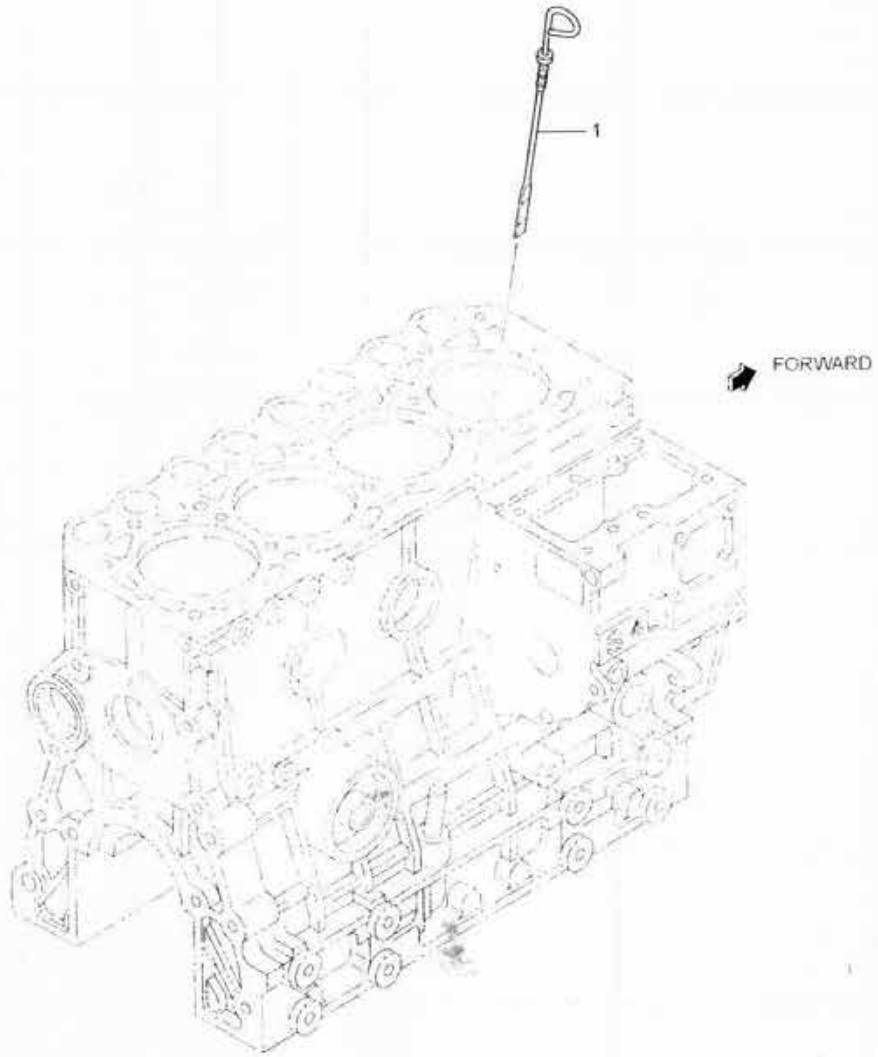

REF. -NO.	PART NO.	R/S P/Q	C N G	PART NAME & DESCRIPTION	MODEL & QTY			APPLICABLE SERIAL NO.		M/R	V/R	D
					S3L2			FROM@-	@UPTO			
1	31A42-00300			GAGE, OIL LEVEL	1							

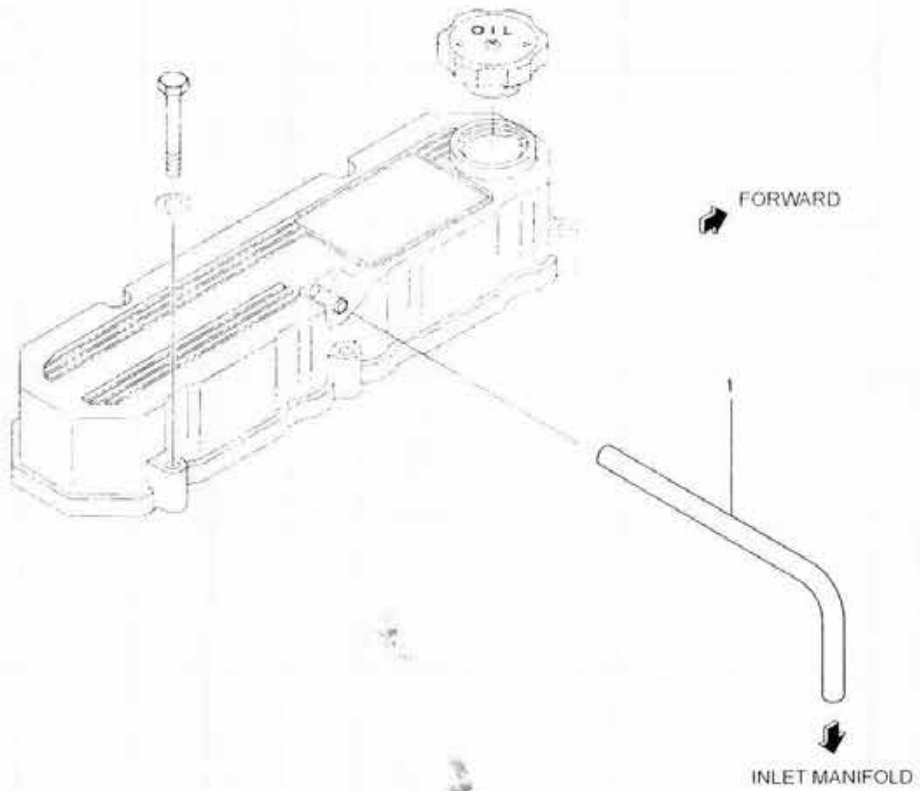

REF. -NO.	PART NO.	R / P	S E N G	PART NAME & DESCRIPTION	MODEL & QTY			APPLICABLE SERIAL NO.		M / R	V R D
					S3L2			FROM@-	-@UPTO		
1	MM400380			PIPE, BREATHER	1						

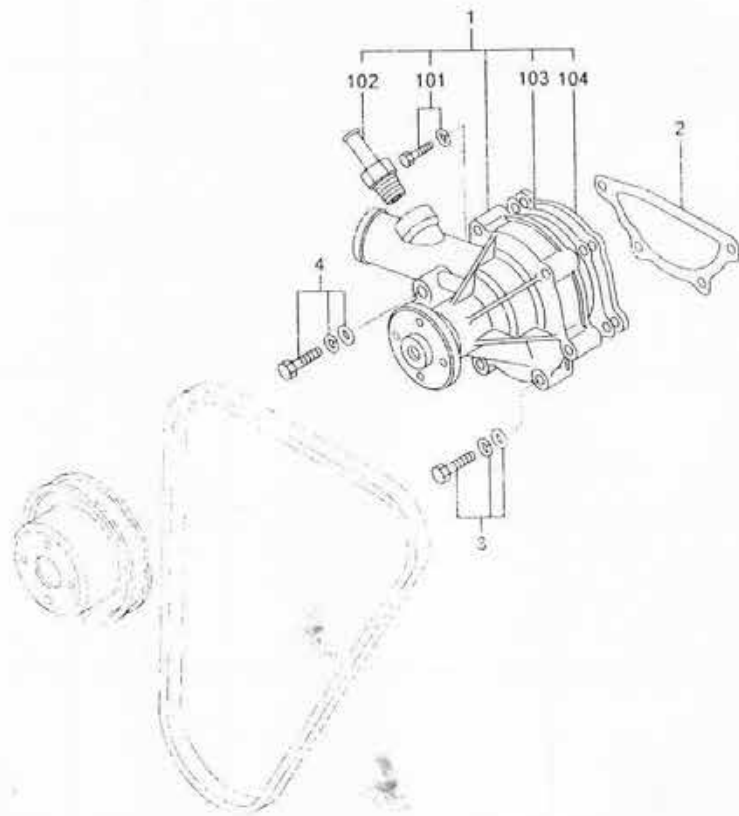

REF. -NO.	PART NO.	R / P	S E N G	PART NAME & DESCRIPTION	MODEL & QTY			APPLICABLE SERIAL NO.		M / R	V R D
					S3L2			FROM@-	-@UPTO		
1	MM409303			PUMP ASSY, WATER	1						
1 01	MF240031			BOLT, W/WASHER	2						
1 02	MM409304			UNION, WATER PUMP	1						
1 03	MM409326			GASKET, WATER PUMP	1						
1 04	MM409327			PLATE, WATER PUMP	1						
2	30H45-00101			GASKET, WATER PUMP	1						
3	MF244860			BOLT, W/WASHER	3						
4	MF244863			BOLT, W/WASHER	1						

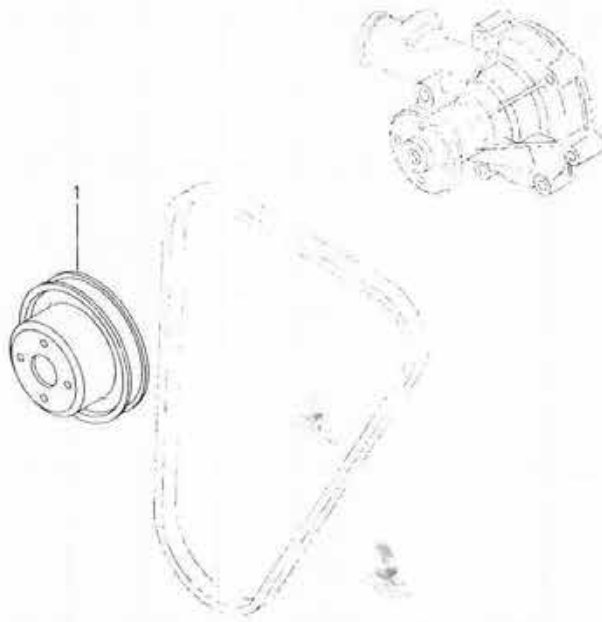

REF. -NO.	PART NO.	R / P	S E N G	PART NAME & DESCRIPTION	MODEL & QTY			APPLICABLE SERIAL NO.		M / R	V R D
					S3L2			FROM@-	@UPTO		
1	31A45-20700			PULLEY, WATER PUMP	1						

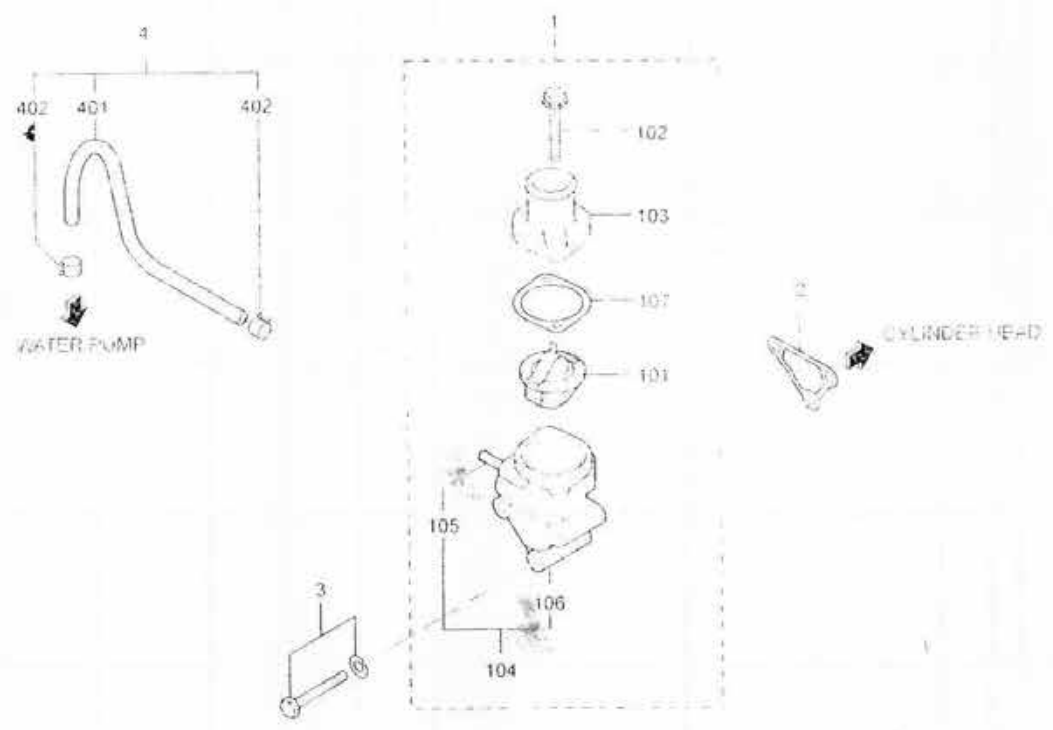

REF. NO.	PART NO.	R P	S E N G	PART NAME & DESCRIPTION	MODEL & QTY		APPLICABLE SERIAL NO.		M R D	V R D
					S3L2		FROM-	-UPTO		
1	*			THERMOSTAT ASSY	1					
1 01	K6516441			THERMOSTAT	1					
1 02	MF140227			BOLT, FLANGE	2					
1 03	MM409-31302			COVER, THERMOSTAT	1					
1 04	31A46-00020			CASE ASSY, THERMOSTAT	1					
1 05	*			PIPE, THERMOSTAT	1					
1 06	*			CASE, THERMOSTAT	1					
1 07	31A46-11200			GASKET, THERMOSTAT	1					
2	31A46-10101			GASKET, THERMO CASE	1					
3	MF241266			BOLT, W/WASHER	3					
4	31A46-05010			HOSE ASSY	1					
4 01	31A46-02600			HOSE, BY-PASS	1					
4 02	F4300-02071			CLAMP	2					

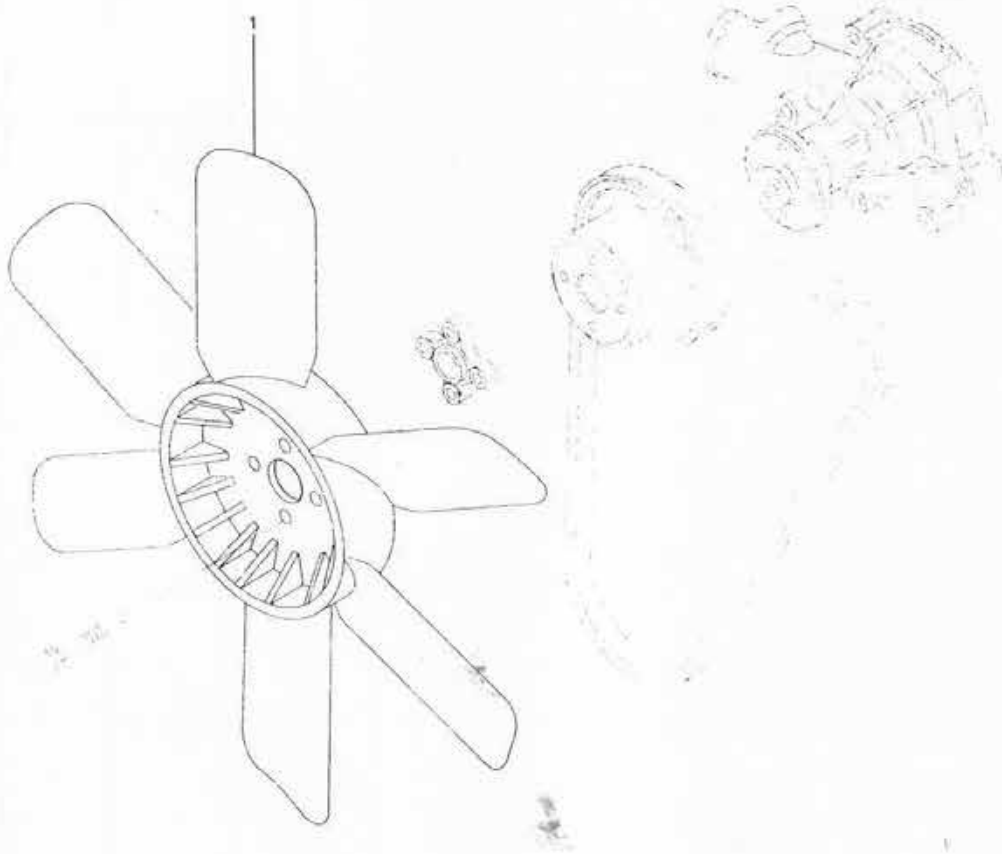

REF. -NO.	PART NO.	R P	S E Q	C N G	PART NAME & DESCRIPTION	MODEL & QTY		APPLICABLE SERIAL NO.		M R	V R D
						S3L2		FROM@-	-@UPTO		
1	MM405-43002				FAN, COOLING	1					



REF. NO.	PART NO.	R P /	S E N G	PART NAME & DESCRIPTION	MODEL & QTY		APPLICABLE SERIAL NO.		M V R D
					S3L2		FROM@-	@UPTO	
1	MM434493			SPACER, FAN	1				
2	MF241229			BOLT, W. WASHER	4				A

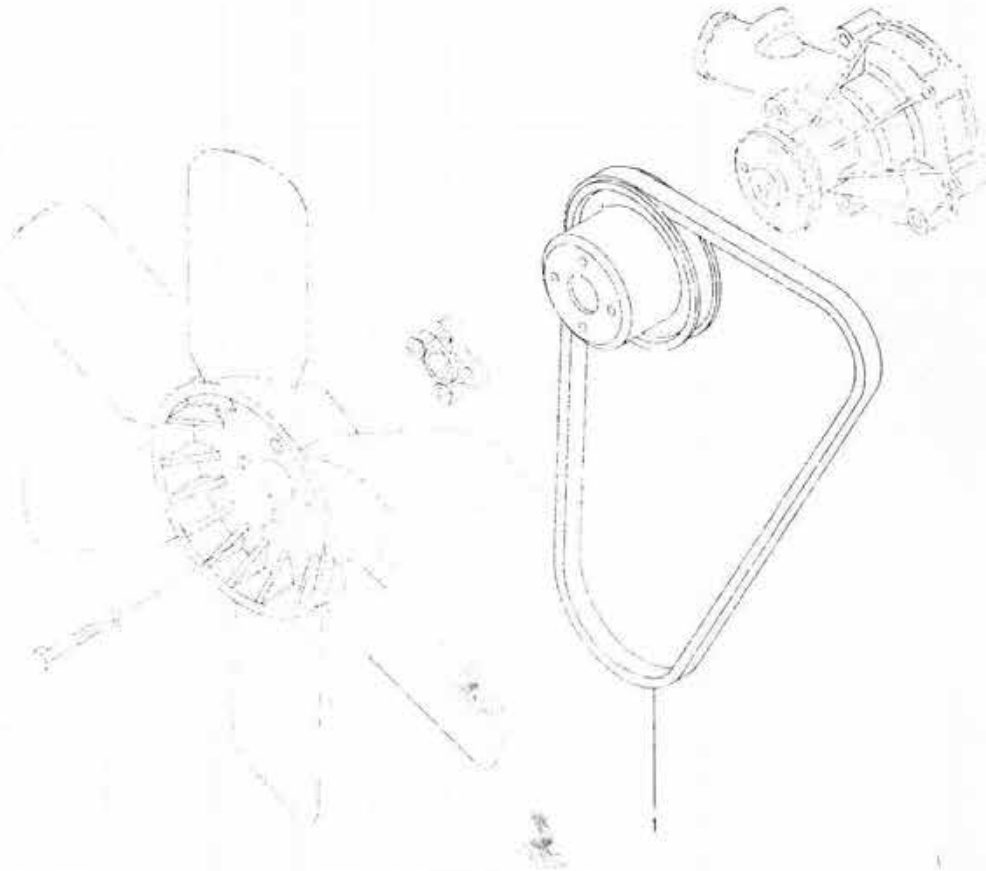

REF. NO.	PART NO.	R P	S E Q	C N G	PART NAME & DESCRIPTION			MODEL & QTY		APPLICABLE SERIAL NO.		M R	V R D
					S3L2			FROM@-	@UPTO				
1	MD041704				V-BELT	L-970		1					

61-00-01 FUEL SYSTEM

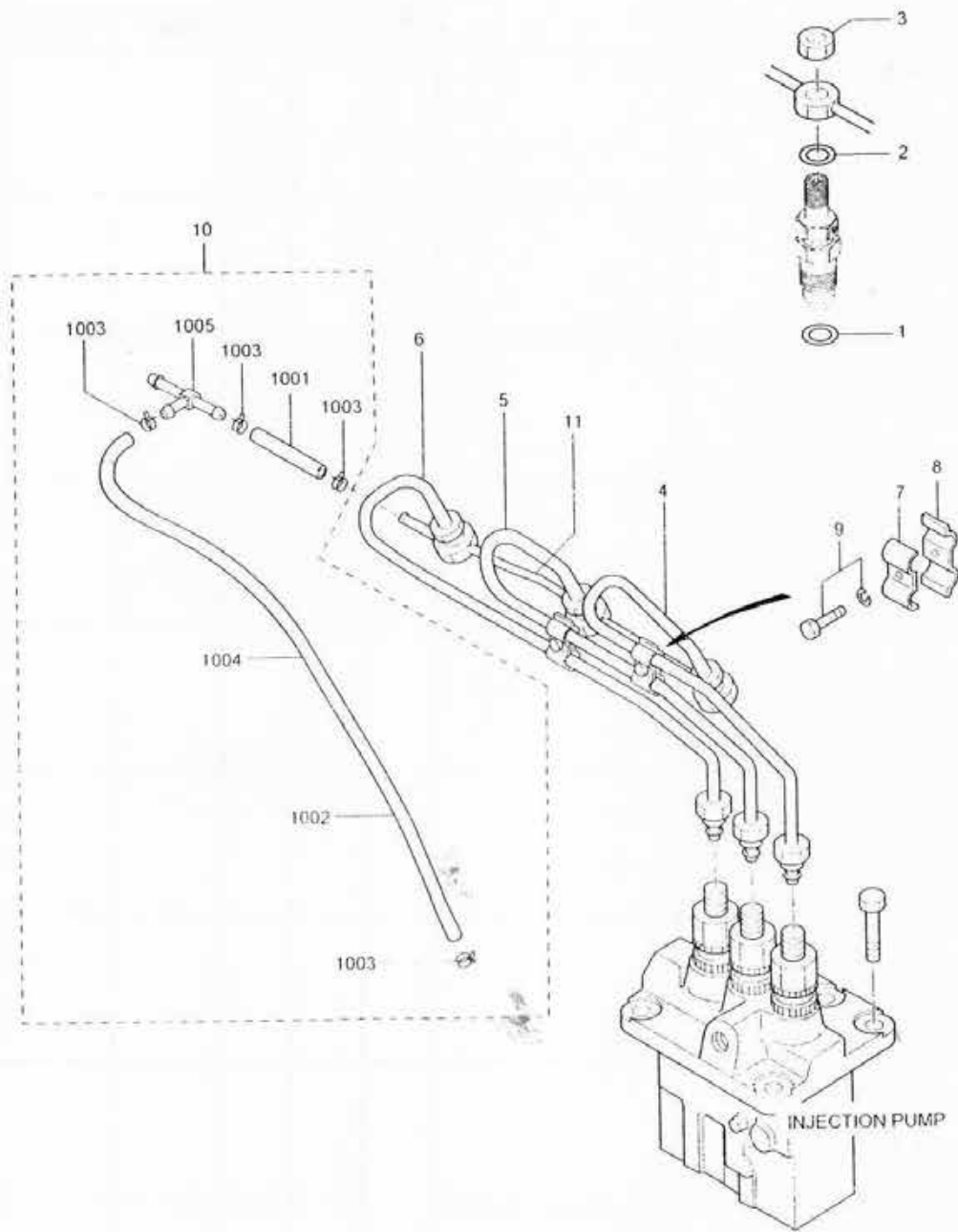

REF. -NO.	PART NO.	R P	S E N G	PART NAME & DESCRIPTION	MODEL & QTY			APPLICABLE SERIAL NO.		M R	V R D
					S3L2			FROM@-	-@UPTO		
1	MD070717			GASKET, HOLDER	3						
2	MD068355			GASKET, FUEL RETURN	3						
3	MD068353			NUT	3						
4	31A61-07101			PIPE, INJECTION NO. 1	1						
5	31A61-07201			PIPE, INJECTION NO. 2	1						
6	31A61-07301			PIPE, INJECTION NO. 3	1						
7	MM430703			CLAMP	2						
8	MM430614			CLAMP	2						
9	MF243628			BOLT, W/WASHER	2						
10	31B61-13100			HOSE ASSY, AIR VENT	1						
10 01	MM430131			HOSE, FUEL	1						
10 02	MS604032			HOSE, FUEL	1						
10 03	MS660169			CLIP, HOSE	4						
10 04	31A61-01200			HOSE, RUBBER	1						
10 05	31A61-01500			JOINT, THREE WAY	1						
11	31B61-02800			PIPE, FUEL LEAK-OFF	1						

61-00-02 NOZZLE & NOZZLE HOLDER

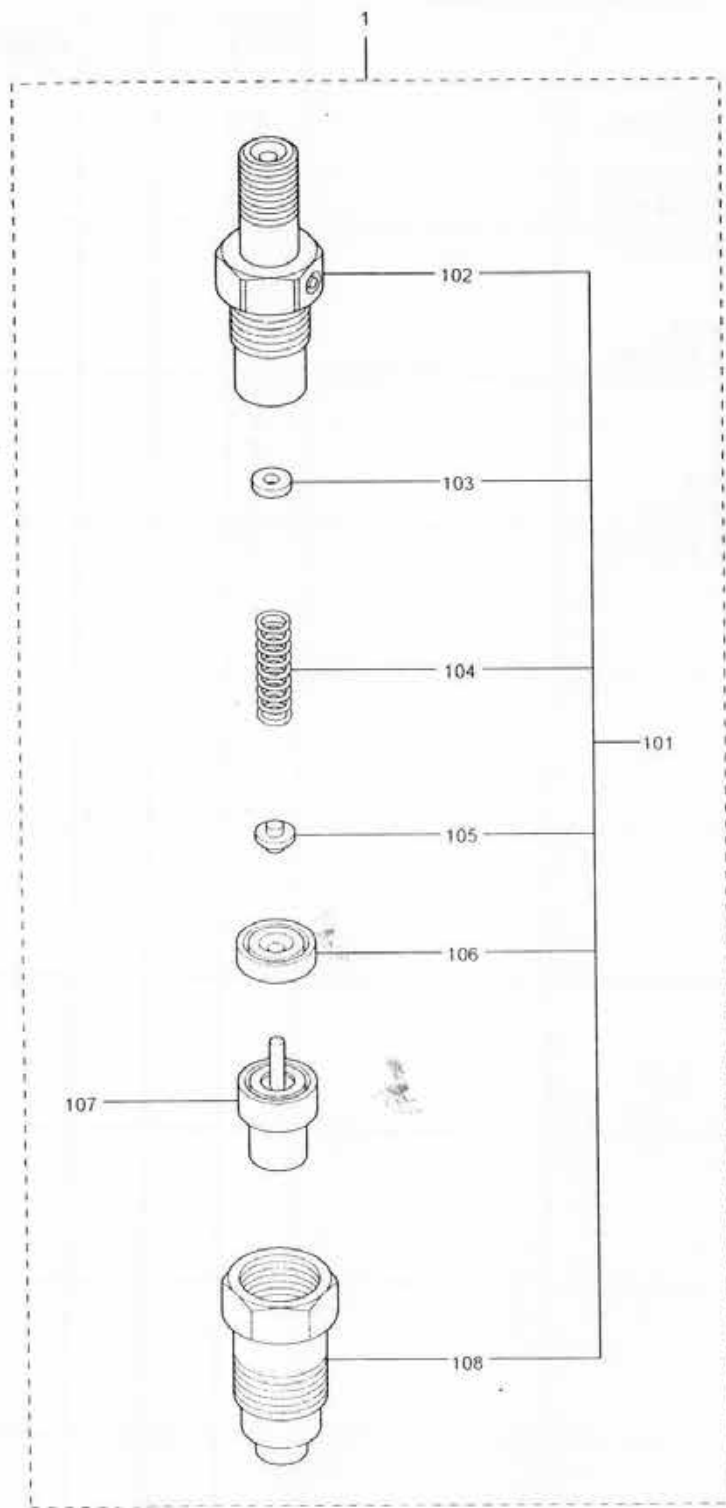

61-00-02 NOZZLE & NOZZLE HOLDER

REF. -NO.	PART NO.	R P	S E Q	C N G	PART NAME & DESCRIPTION	MODEL & QTY			APPLICABLE SERIAL NO.		M R	V R D
						S3L2			FROM@-	@UPTO		
1	MM435-94101				NOZZLE & HOLDER ASSY			3				
1 01	MM514045				HOLDER ASSY			3				
1 02	MM514048				BODY SUB ASSY			3				
1 03	MD603490				WASHER			AR				
	MD603491				WASHER	T=1. 25		AR				
	MD603492				WASHER	T=1. 35		AR				
	MD603493				WASHER	T=1. 40		AR				
	MD603494				WASHER	T=1. 45		AR				
	MD603495				WASHER	T=1. 50		AR				
	MD603496				WASHER	T=1. 55		AR				
	MD603497				WASHER	T=1. 60		AR				
	MD603498				WASHER	T=1. 65		AR				
	MD603499				WASHER	T=1. 70		AR				
1 04	MM514047				SPRING, PRESSURE			3				
1 05	MM501838				PIN, PRESSURE			3				
1 06	MM501841				PIECE, DISTANCE			3				
1 07	MD603660				NOZZLE ASSY			3				
1 08	MM514380				NUT, NOZZLE RETAINING			3				

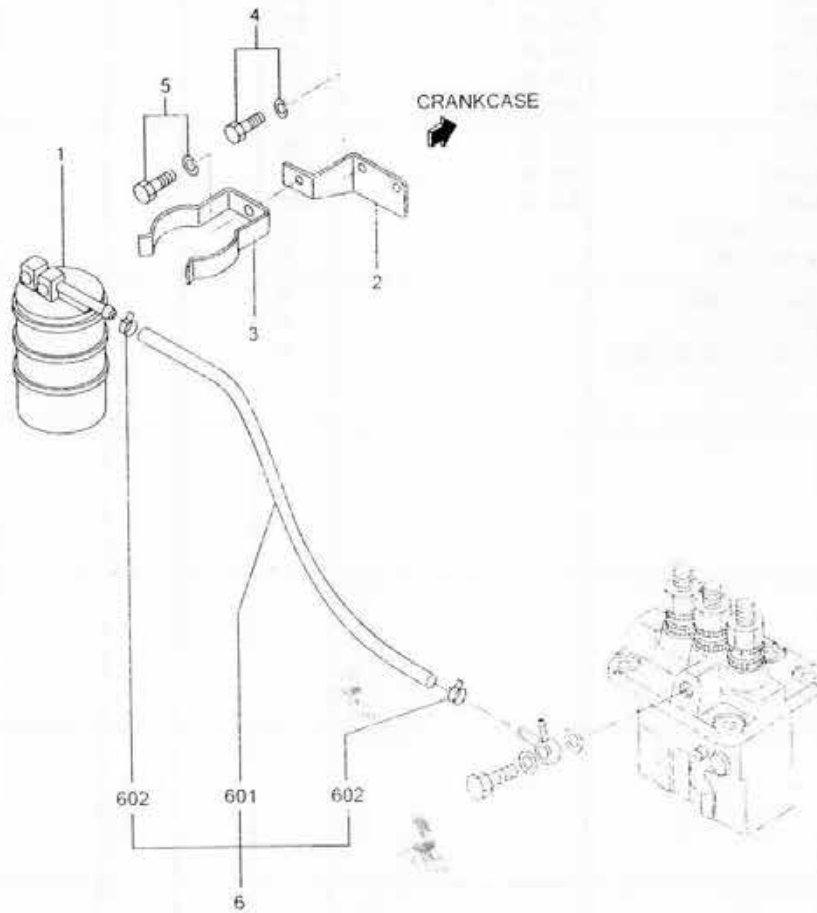

REF. NO.	PART NO.	R/S P/Q	S/C E/N Q/G	PART NAME & DESCRIPTION	MODEL & QTY		APPLICABLE SERIAL NO.		M/R	V/D
					S3L2		FROM@-	@UPTO		
1	MM435190			FILTER ASSY, FUEL	1					
2	31B62-01100			BRACKET, FUEL FILTER	1					
3	MM400-88001			CLAMP, HOSE	1					
4	MF240051			BOLT, W/WASHER	2				A	
5	MF241223			BOLT, W/WASHER	1				A	
6	30A61-04900			HOSE ASSY, FUEL	1					
6 01	MS602039			HOSE, FUEL	1					
6 02	MS660163			CLIP, HOSE	2					
THIS PAGE IS NOT APPLICABLE. FOR CORRECT PART NO. REFER ATTACHED DRAWING NO. 31N96-00260										

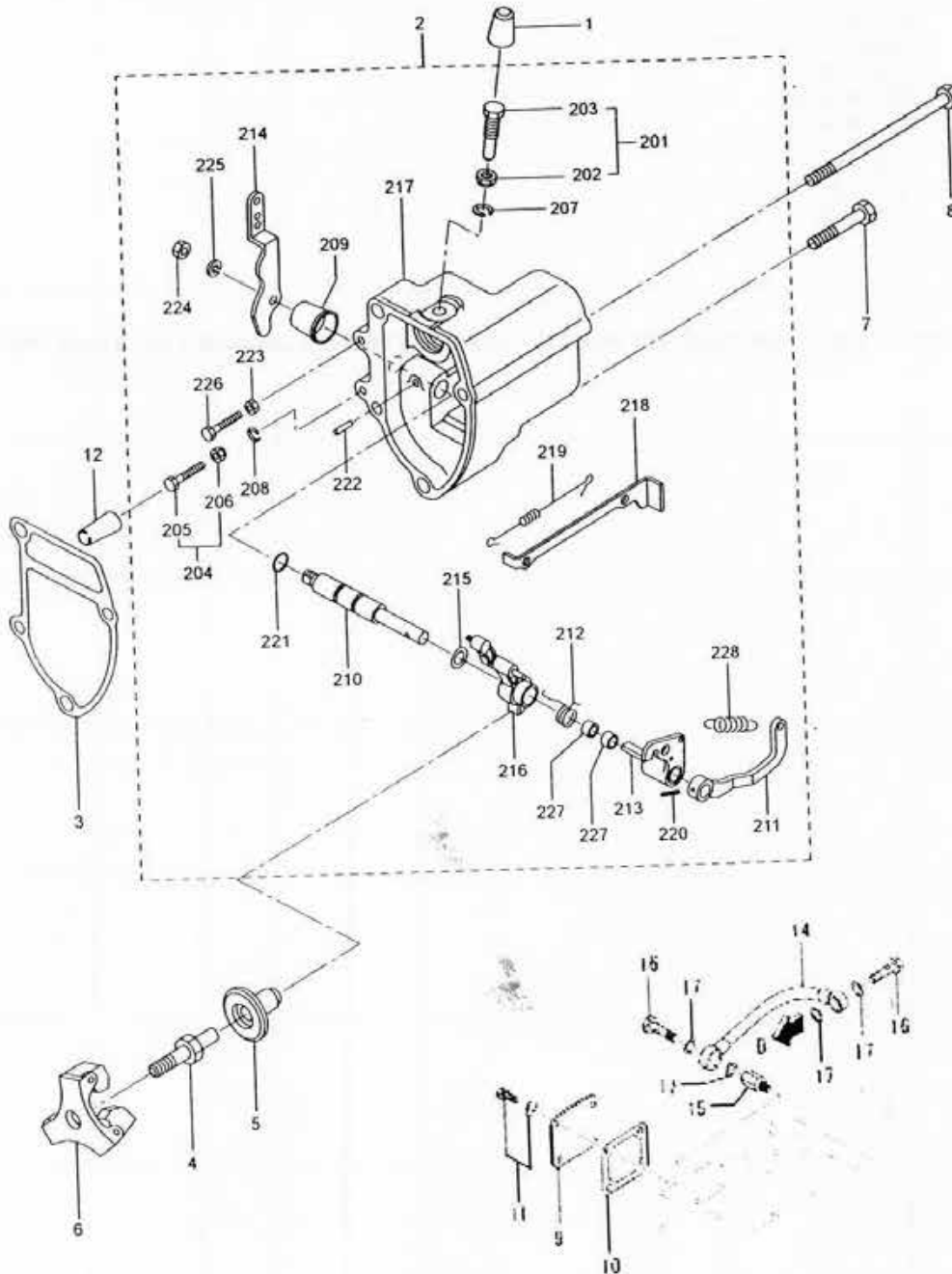

REF. -NO.	PART NO	R P	S E N G	PART NAME & DESCRIPTION	MODEL & QTY			APPLICABLE SERIAL NO.		M V R D
					S3L2			FROM@-	@UPTO	
1	30N63-00400			COVER, TORQUE SET	1					
2	31B63-02091			CASE ASSY, GOVERNOR	1					
2 01	*			SCREW ASSY, RACK SET	1					
2 02	30L63-00600			NUT, TORQUE SET	1					
2 03	31A63-05601			SCREW, RACK SET	1					
2 04	30L63-00080			BOLT ASSY, HIGH SPEED	1					
2 05	30L63-02100			BOLT, HIGH SPEED SET	1					
2 06	30L63-02300			NUT, HIGH SPEED SET	1					
2 07	30N63-04300			C-RING	1					
2 08	30N63-04800			C-RING	1					
2 09	31A63-01800			COVER, GOVERNOR SHAFT	1					
2 10	31A63-02600			SHAFT, GOVERNOR	1					
2 11	31A63-02700			LEVER, GOVERNOR	1					
2 12	31A63-05300			SPRING, START	1					
2 13	31A63-05400			LEVER, TENSION	1					
2 14	31A63-11301			LEVER, SPEED CONTROL	1					
2 15	31A63-15200			SHIM, GOVERNOR SHAFT	1					
2 16	31A63-07300			LEVER, GOVERNOR	1					
2 17	31A63-17200			CASE, GOVERNOR	1					
2 18	31B63-00400			TIE-ROD	1					
2 19	31B63-00500			SPRING, TIE ROD	1					
2 20	F2850-03020			PIN, SPRING	1					
2 21	F3150-01010			O-RING	1					
2 22	31N63-00300			PIN, GROOVED	1					
2 23	MF430004			NUT	1					
2 24	F2325-08000			NUT, JAM	1					
2 25	F2515-08000			WASHER, SPRING	1					
2 26	31N63-00200			BOLT, LOW IDLE SET	1					
2 27	MM406-420			BEARING, NEEDLE	2					
2 28	MM433-720			SPRING, GOVERNOR	1					
3	31A63-12201			GASKET, GOVERNOR CASE	1					
4	31A63-10305			SHAFT, SLIDING SLEEVE	1					
5	31A63-25101			SLEEVE, SLIDING	1					
6	31A63-02030			WEIGHT ASSY, GOVERNOR	1					
7	MF100064			BOLT	3					
8	31A63-02301			BOLT, GOVERNOR CASE	1					
9	MM409150			COVER, TIE ROD	1					
10	30A63-00101			GASKET, TIE ROD	1					
11	MF241224			BOLT, W/WASHER	4					
12	30N63-04700			COVER, HIGH SPEED SET	1					
14	31A63-08100			PIPE, OIL	1					
15	31A63-06900			CONNECTOR	1					
16	MF650-102			BOLT, EYE (10X20)	2					
17	MF660-063			GASKET (10)	4					

65-00-01 INJECTION PUMP

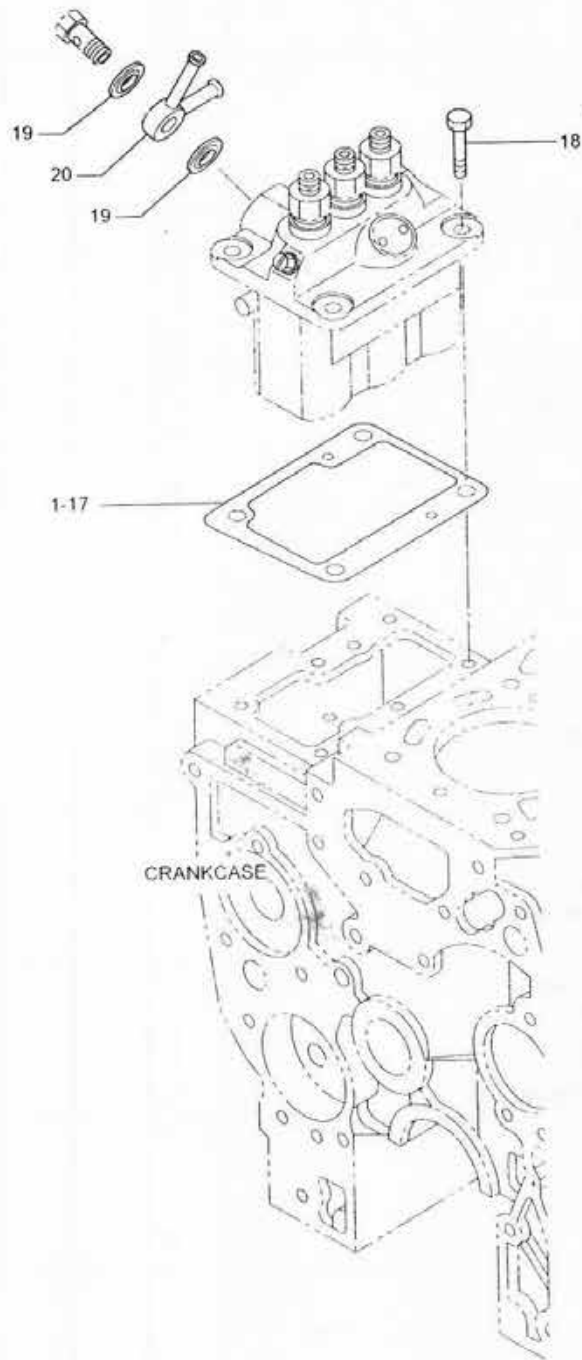

REF. -NO.	PART NO.	R P	S E N G	PART NAME & DESCRIPTION		MODEL & QTY			APPLICABLE SERIAL NO.		M R	V R D
						S3L2			FROM@-	@UPTO		
1	MM409040			SHIM	T=0. 2	AR						
2	MM409041			SHIM	T=0. 3	AR						
3	MM409042			SHIM	T=0. 4	AR						
4	MM409043			SHIM	T=0. 5	AR						
5	MM409044			SHIM	T=0. 6	AR						
6	MM409045			SHIM	T=0. 7	AR						
7	MM409046			SHIM	T=0. 8	AR						
8	MM409047			SHIM	T=0. 9	AR						
9	MM409048			SHIM	T=1. 0	AR						
10	31B65-06100			SHIM	T=1. 1	AR						
11	31B65-06200			SHIM	T=1. 2	AR						
12	31B65-06600			SHIM	T=0. 74	AR						
13	31B65-06700			SHIM	T=0. 86	AR						
14	31B65-06800			SHIM	T=0. 95	AR						
15	31B65-06900			SHIM	T=1. 04	AR						
16	31B65-07100			SHIM	T=1. 16	AR						
17	31B65-07200			SHIM	T=1. 25	AR						
18	MF100055			BOLT		4						
19	MK661-12000			WASHER, SEALING		2						
20	31B65-00300			COLOR, UNION		1						

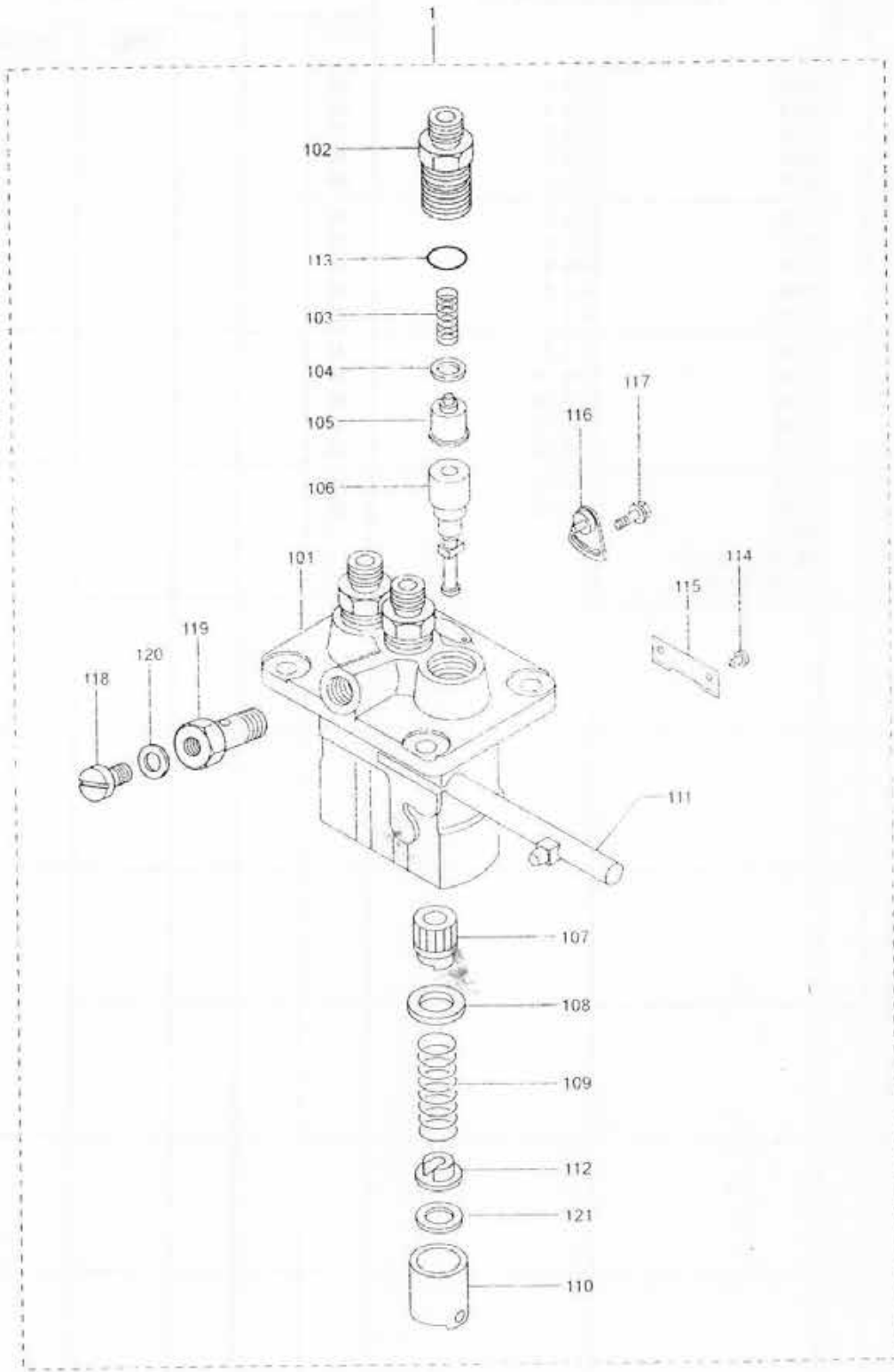

REF. NO.	PART NO.	R/S P/Q	C/N E/G	PART NAME & DESCRIPTION	MODEL & QTY			APPLICABLE SERIAL NO.		M/R D
					S3L2			FROM	UPTO	
1	31865-14090			PUMP ASSY, FUEL, INJ	1					
1 01	47X01-06100			HOUSING SUB ASSY	1					
1 02	47X01-13200			HOLDER DELIVERY	3					
1 03	47X01-13300			SPRING, DELIVERY	3					
1 04	MM501856			GASKET, DELIVERY	3					
1 05	47X01-07700			VALVE SUB ASSY	3					
1 06	47X01-07600			ELEMENT SUB ASSY	3					
1 07	MM500229			SLEEVE, CONTROL	3					
1 08	MM501098			SEAT, SPRING UPPER	3					
1 09	MM500360			SPRING, PLUNGER	3					
1 10	MM500230			TAPPET SUB ASSY	3					
1 11	MM501311			RACK ASSY, CONTROL	1					
1 12	MM500316			SEAT, SPRING LOWER	3					
1 13	47X01-22700			O-RING	3					
1 14	MM500231			PIN, TAPPET GUIDE	3					
1 15	MM501162			PLATE	1					
1 16	MM514109			PLATE, ADJUSTING	2					
1 17	MM514195			BOLT, WASHER HEAD	2					
1 18	MM501152			SCREW, AIR BLEEDER	1					
1 19	MM501320			SCREW, HOLLOW	1					
1 20	MM500578			WASHER, PIPE UNION	1					
1 21	MM500299			SHIM T=0.6	AR					
	MM500309			SHIM T=0.2	AR					
	MM500310			SHIM T=0.3	AR					
	MM500311			SHIM T=0.4	AR					
	MM500312			SHIM T=0.5	AR					
	MM500314			SHIM T=0.25	AR					
	MM500315			SHIM T=0.35	AR					
	MM501246			SHIM T=0.45	AR					
	MM501364			SHIM T=0.55	AR					
	MM501365			SHIM T=0.65	AR					

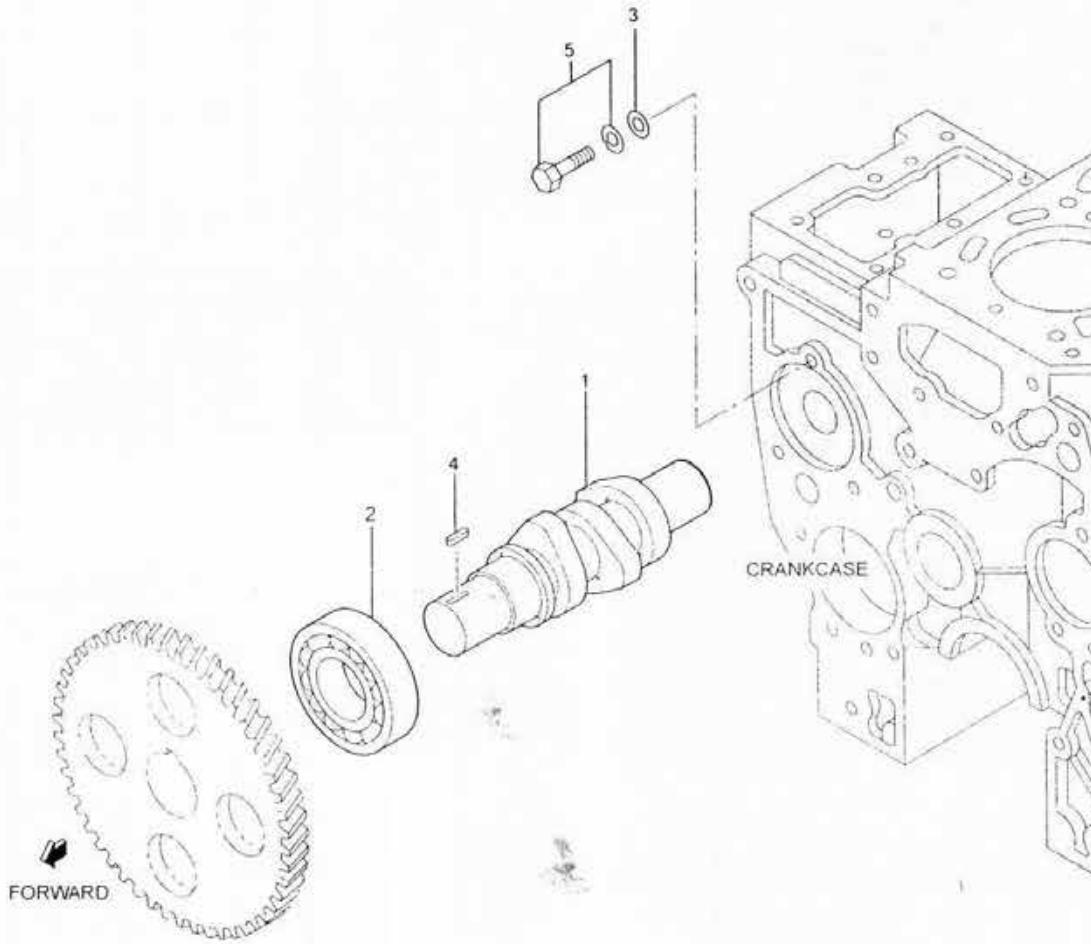

REF. -NO.	PART NO.	R P	S E N G	PART NAME & DESCRIPTION	MODEL & QTY			APPLICABLE SERIAL NO.		M R	V R D
					S3L2			FROM@-	-@UPTO		
1	31865-01200			SHAFT, FUEL INJ PUMP	1						
2	MD703856			BEARING, BALL	1						
3	MD000425			WASHER	1						
4	MF476018			KEY, SUNK	1						
5	MF241251			BOLT, W/WASHER	1						

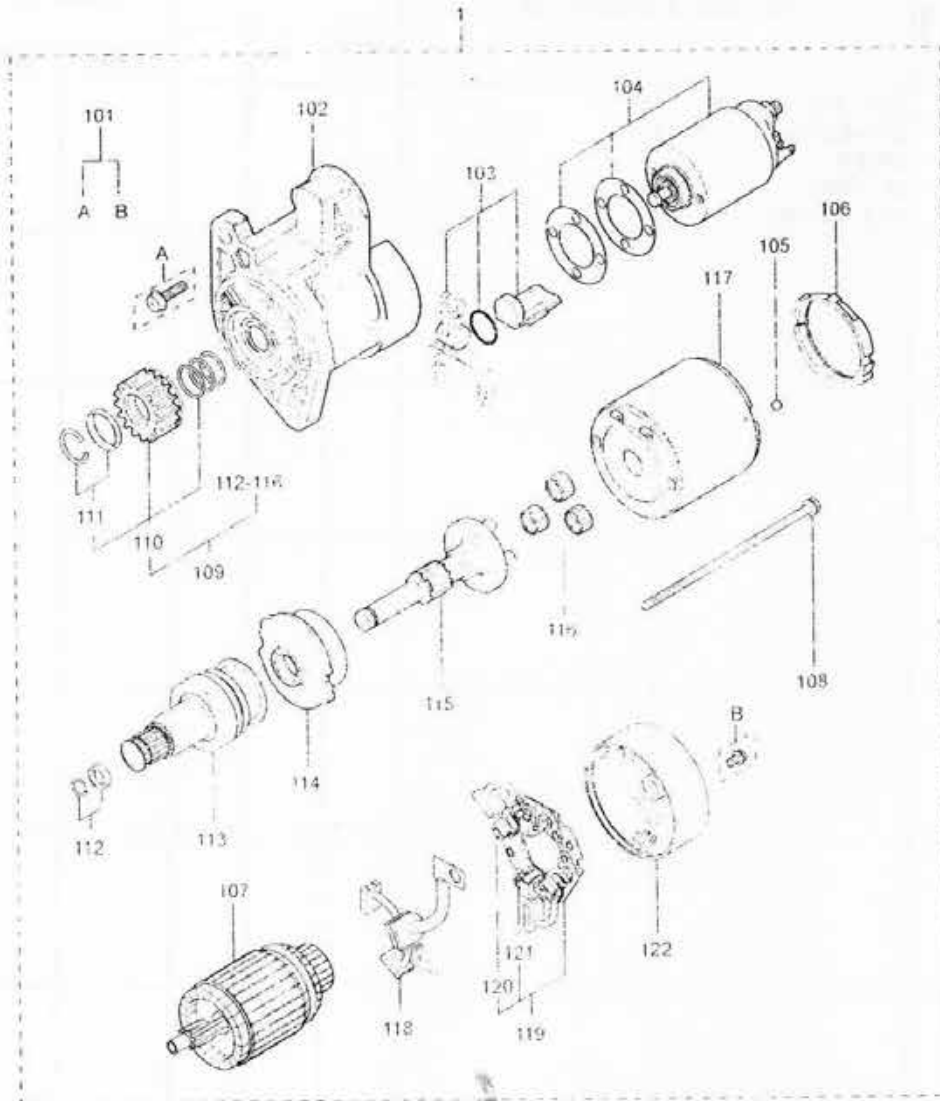

PART WITHOUT REF NO. WILL NOT BE SUPPLIED

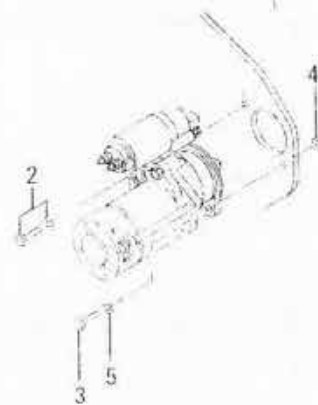

REF. -NO.	PART NO.	R P	S E N G	PART NAME & DESCRIPTION	MODEL & QTY			APPLICABLE SERIAL NO.		M R	V R D
					S3L2			FROM@-	-@UPTO		
1	31B66-00101			STARTER ASSY	1						
1 01	47X11-02237			SCREW SET	1						
1 02	47X11-02247			BRACKET ASSY, FRONT	1						
1 03	47X11-02235			LEVER SET	1						
1 04	47X11-02319			SWITCH ASSY	1						
1 05	47X11-02213			BALL	1						
1 06	47X11-02320			PACKING	1						
1 07	47X11-02239			ARMATURE SET	1						
1 08	47X11-02246			BOLT	1						
1 09	47X11-02227			SHAFT ASSY, CLUTCH	1						
1 10	47X11-02232			PINION SET	1						
1 11	47X11-02233			STOPPER SET	1						
1 12	47X11-02234			STOPPER SET	1						
1 13	47X11-02231			OVER RUNNING CLUTCH	1						
1 14	47X11-02290			GEAR ASSY, INTERNAL	1						
1 15	47X11-02228			SHAFT ASSY, GEAR	1						
1 16	47X11-02207			GEAR ASSY	3						
1 17	47X11-02321			YOKE ASSY	1						
1 18	47X11-02241			BRUSH ASSY	1						
1 19	47X11-02242			HOLDER ASSY, BRUSH	1						
1 20	47X11-02243			SPRING, BRUSH	2						
1 21	47X11-02244			SPRING, BRUSH	2						
1 22	47X11-02248			BRACKET ASSY, REAR	1						
2	MF241282			BOLT, W/WASHER	1						
3	MM409427			BOLT	1						
4	MF430006			NUT	1						
5	MF450406			WASHER, SPRING	1						

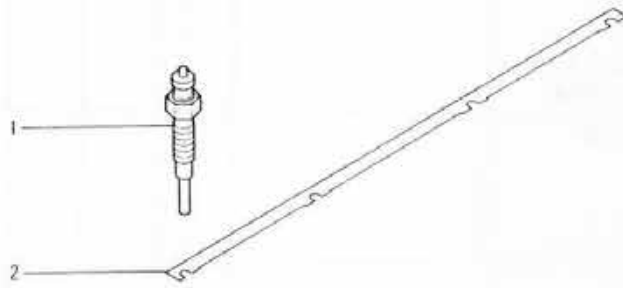

REF. -NO.	PART NO.	R / P	S E N G Q	PART NAME & DESCRIPTION	MODEL & QTY			APPLICABLE SERIAL NO.		M R D
					S3L2			FROM@-	-@UPTO	
1	32A66-03100			PLUG, GLOW	3					
2	31B66-04100			PLATE, CONNECTOR	1					

68-00-01 ALTERNATOR

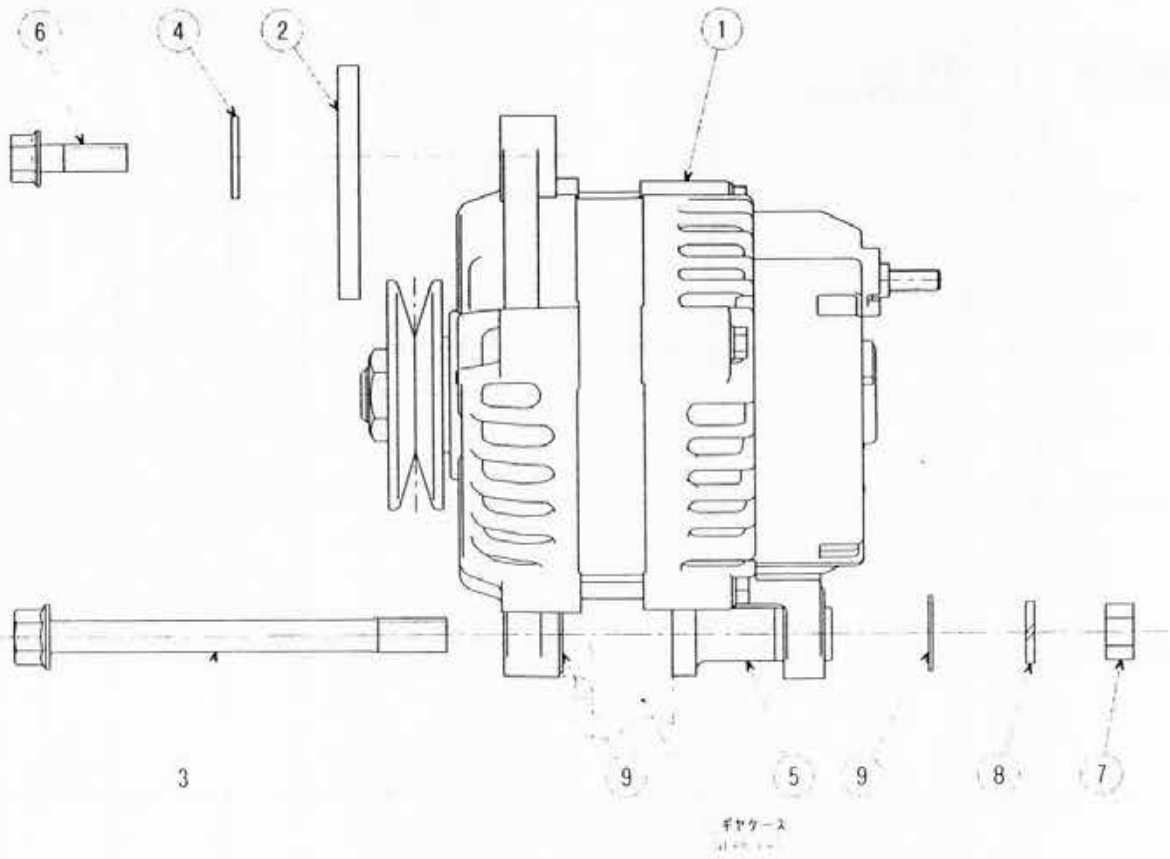

REF. -NO.	PART NO.	R P	S E P Q	C N G	PART NAME & DESCRIPTION	MODEL & QTY			APPLICABLE SERIAL NO.		M R	V R D
						S3L2			FROM@-	@UPTO		
1	31N68-00800				ALTERNATOR, ASSY	1						
2	31N68-00400				PLATE, ADJUSTING	1						
3	31N68-00600				BOLT, FLANGE	1						
4	30N68-00300				WASHER	1						
5	31N68-00500				SPACER ALTERNATOR	1						
6	F1010-08025				BOLT FLANGE	1						
7	F2300-10000				NUT	1						
	F2515-10000				WASHER SPRING	1						
	31N68-00700				WASHER PLAIN	2						

68-00-02 ALTERNATOR (12V-50A)

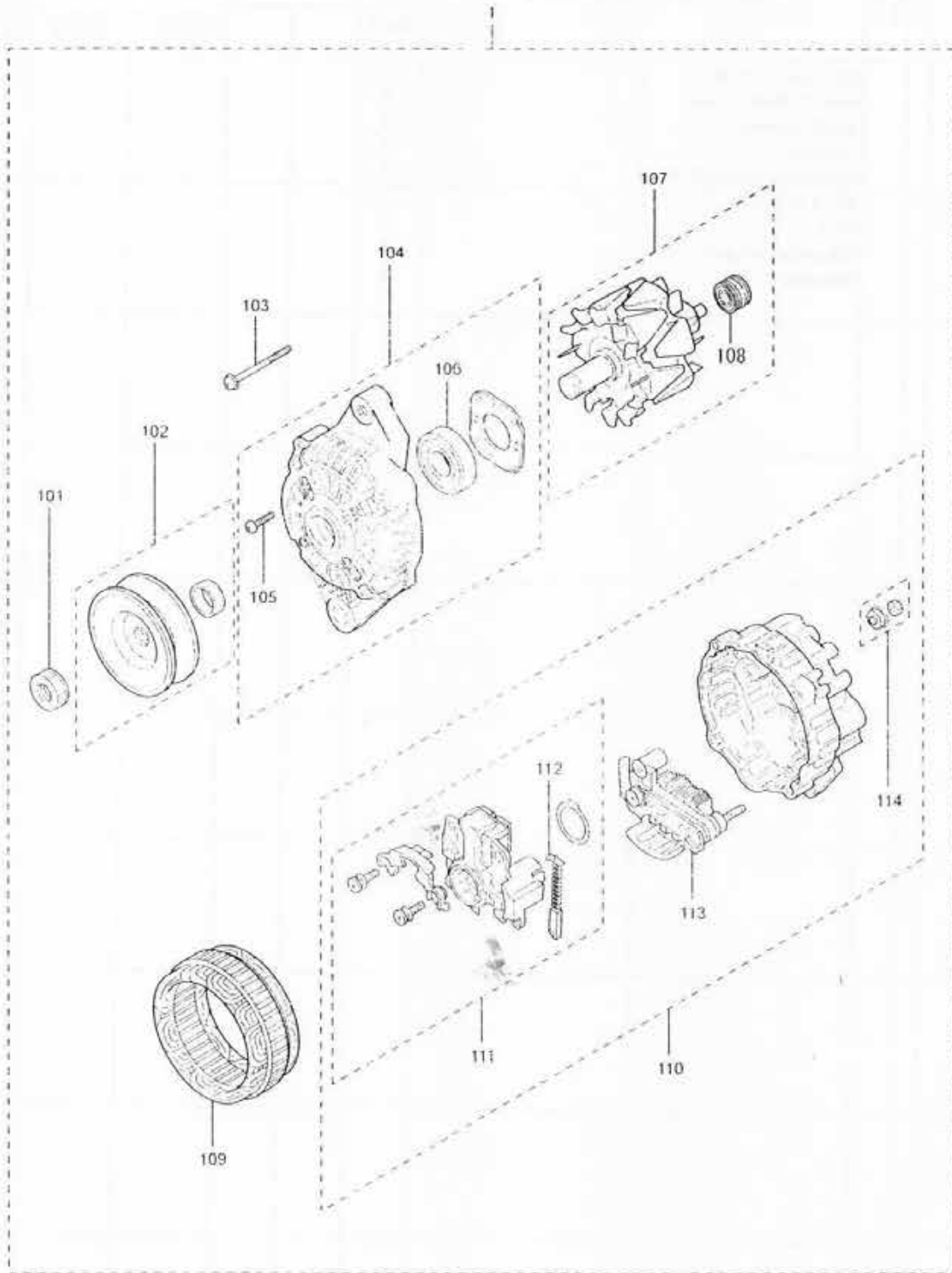

PARTS WITHOUT REF NO WILL NOT BE SUPPLIED

REF. -NO.	PART NO.	R / P	S E N G	PART NAME & DESCRIPTION	MODEL & QTY			APPLICABLE SERIAL NO.		M / R	V R D
					S3L2			FROM@-	@UPTO		
1	31A68-00402			ALTERNATOR ASSY	1						
1 01	A981X-20771			NUT SET	1						
1 02	MM502578			PULLEY ASSY	1						
1 03	A414X-19271			BOLT SET	1						
1 04	47X11-02305			BRACKET ASSY, FRONT	1						
1 05	A414X-21271			SCREW SET	1						
1 06	A930X-94570			BEARING, FRONT	1						
1 07	47X11-02311			ROTOR ASSY	1						
1 08	MD611928			BEARING, REAR	1						
1 09	47X11-02312			STATOR ASSY	1						
1 10	47X11-02313			BRACKET ASSY, REAR	1						
1 11	47X11-02304			REGULATOR SET	1						
1 12	A647X-50170			BRUSH SET	2						
1 13	MM502574			RECTIFIER ASSY	1						
1 14	MM502575			NUT SET	1						
THIS PAGE IS NOT APPLICABLE											

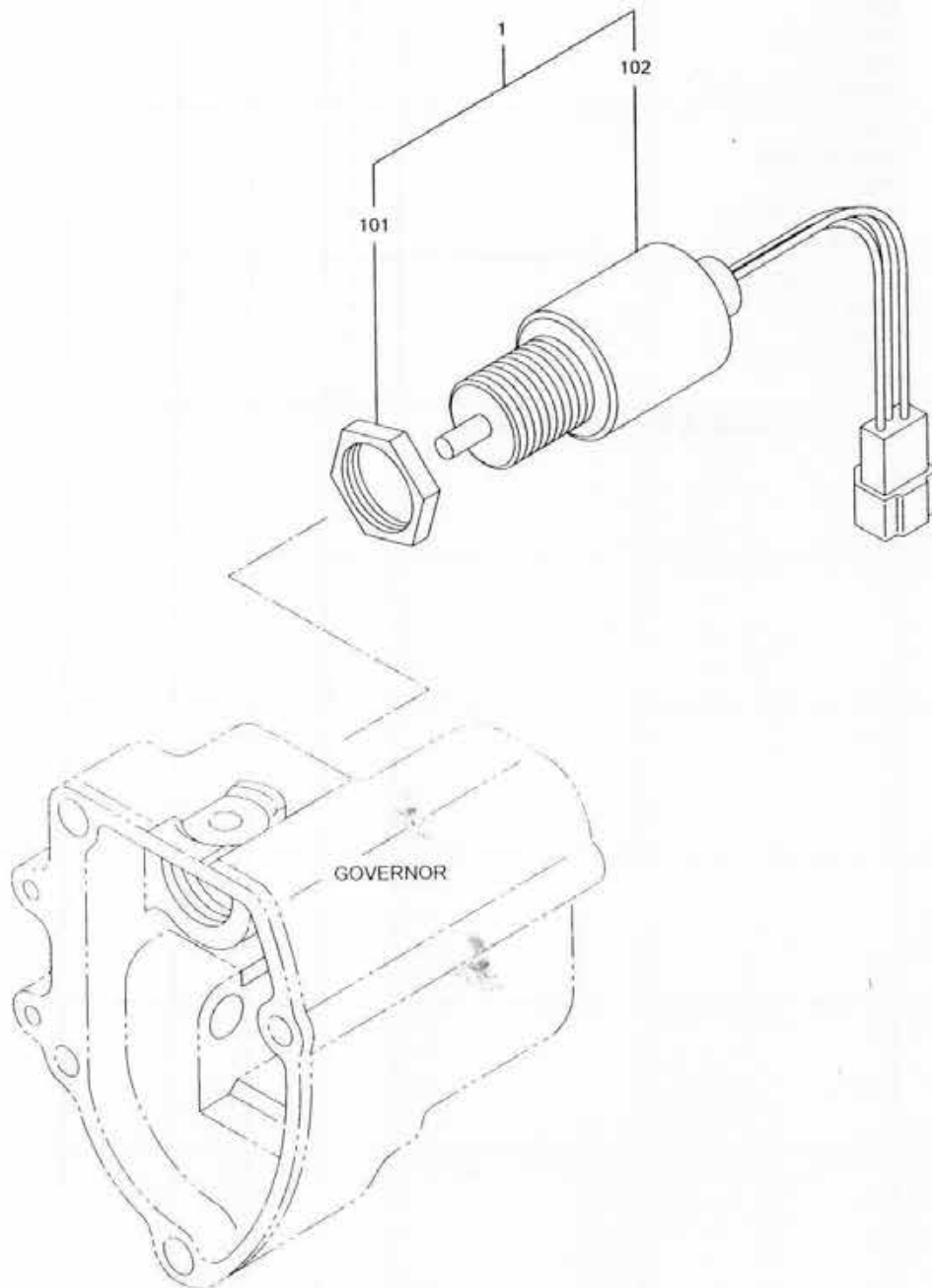

REF. -NO.	PART NO.	R / P	S E Q	C N G	PART NAME & DESCRIPTION	MODEL & QTY			APPLICABLE SERIAL NO.		M / R	V R D
						S3L2			FROM@-	@UPTO		
1	30A87-10042				SOLENOID & NUT SET	1						
1 01	30A87-20402				SOLENOID ASSY	1						
1 02	MM409671				NUT	1						

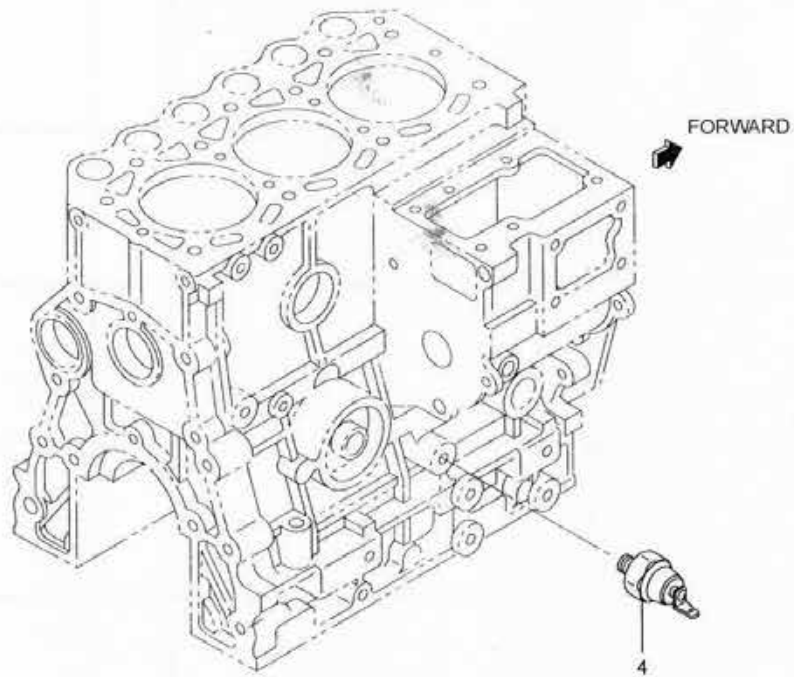
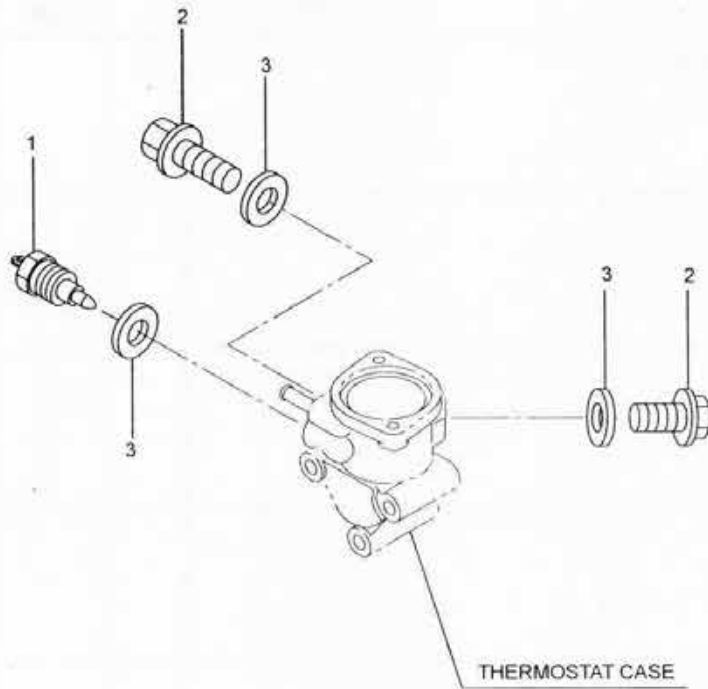

REF. -NO.	PART NO.	R P	S E Q	C N G	PART NAME & DESCRIPTION	MODEL & QTY			APPLICABLE SERIAL NO.		M R	V R D
						S3L2			FROM@-	@UPTO		
1	MM432104				SWITCH ASSY, THERMO	1						
2	MM316248				PLUG, DRAIN	2						
3	05946-01601				WASHER, SEALING	3						
4	31A90-10300				SWITCH, OIL PRESSURE	1						A

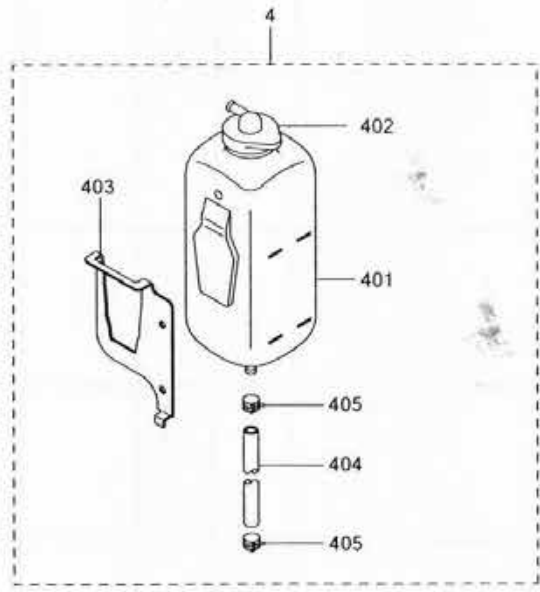
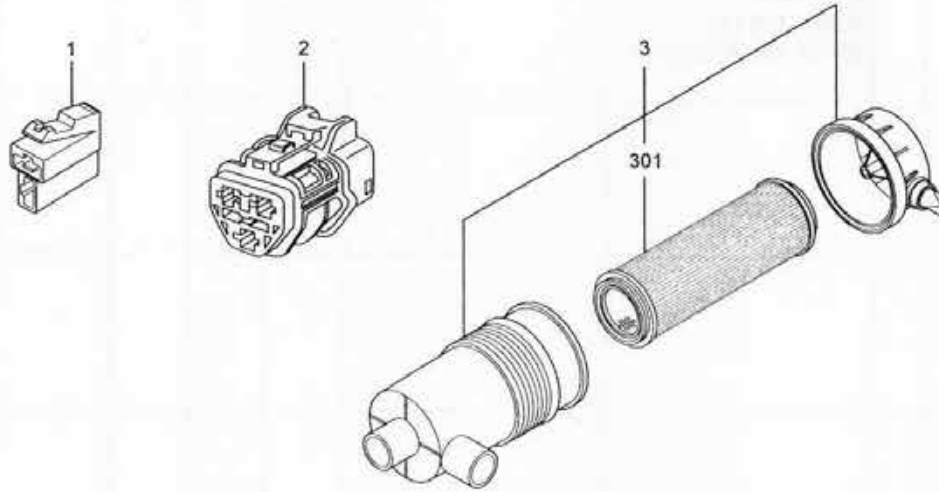

REF. -NO.	PART NO.	R P	S E Q	C N G	PART NAME & DESCRIPTION	MODEL & QTY			APPLICABLE SERIAL NO.		M R	V R D
						S3L2			FROM@-	-@UPTO		
1	F8665-02100				CONNECTOR	1						
2	30A87-00600				CONNECTOR	1						
3	31A30-03020				CLEANER ASSY. AIR	1						
3 01	31A30-03200				ELEMENT	1						
4	MM434-59001				TANK ASSY. RESERVOIR	1						
Refer attached Drawing No. 31N96-00260												
4 01	MM301607				TANK, RESERVOIR	1						
4 02	MM315438				CAP, RESERVOIR	1						
4 03	MM301618				BRACKET, RESERVE	1						
4 04	MM301646				HOSE	1						
4 05	MM317-41701				CLAMP, HOSE	2						

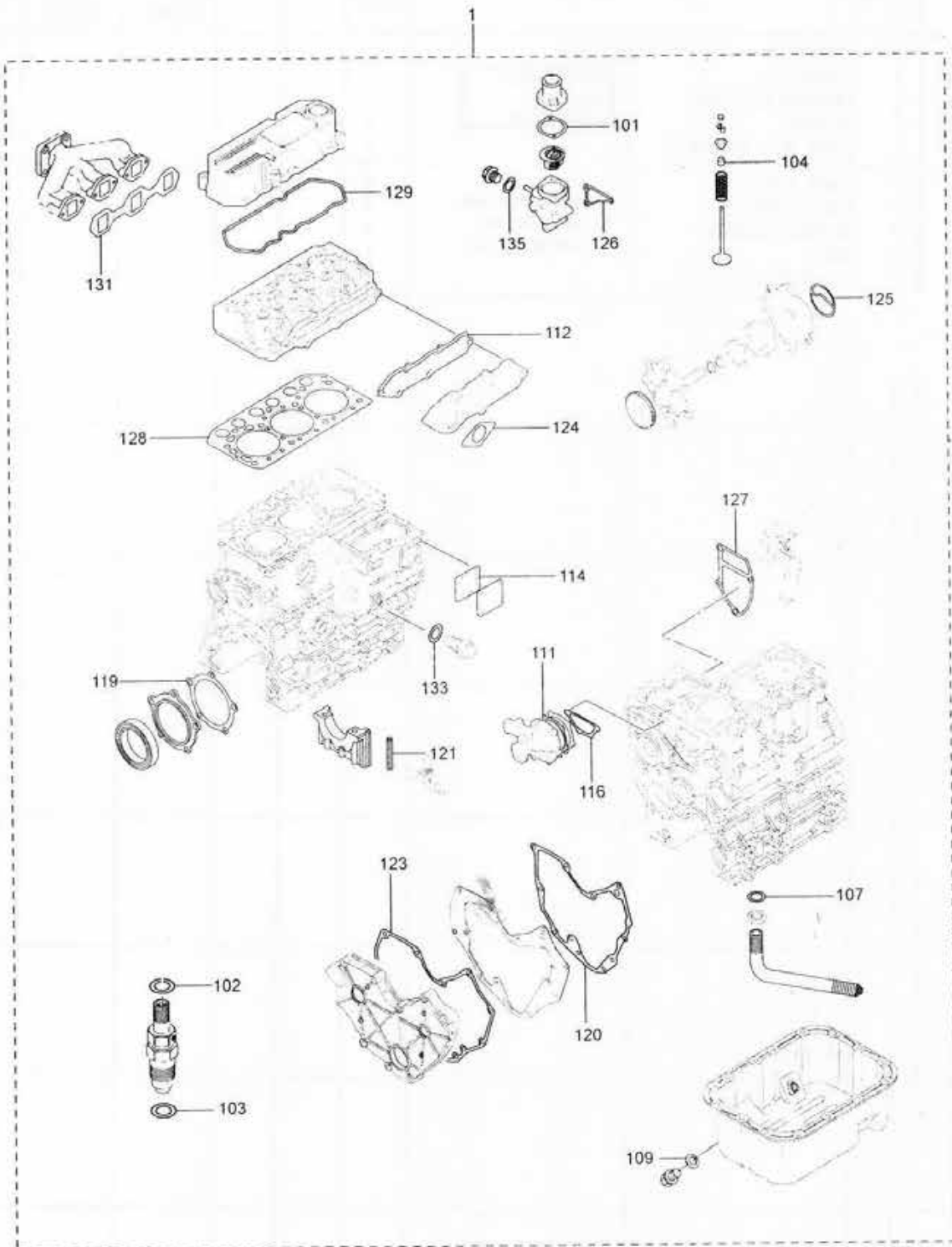

REF. -NO.	PART NO.	R P	S E N G	PART NAME & DESCRIPTION	MODEL & QTY			APPLICABLE SERIAL NO.		M R	V R D
					S3L2			FROM@-	-@UPTO		
1	31B94-16020			GASKET KIT, OVERHAUL	1						
1 01	31A46-11200			GASKET, THERMOSTAT	1						
1 02	MD068355			GASKET, FUEL RETURN	3						
1 03	MD070717			GASKET, HOLDER	3						
1 04	MD115472			SEAL, VALVE STEM	6						
1 05	MD701788			O-RING	1						
1 06	MF520012			O-RING	1						
1 07	MF660036			GASKET	1						
1 08	30A13-02101			GASKET, OIL PAN	1						
1 09	MD050317			GASKET, OIL DRAIN	1						
1 10	49168-15200			GASKET	3						
1 11	MM409326			GASKET, WATER PUMP	1						
1 12	31B30-00800			GASKET, INLET COVER	1						A
1 13	30A30-00200			GASKET, MUFFLER	2						
1 14	30A63-00101			GASKET, TIE-ROD COVER	1						
1 15	31B61-10100			GASKET, RETURN PIPE	3						
1 16	30H45-00101			GASKET, WATER PUMP	1						
1 17	MF660068			GASKET	1						
1 18	MD000312			GASKET	1						
1 19	31A07-11701			GASKET, OIL SEAL CASE	1						
1 20	31A07-11901			GASKET, FRONT PLATE	1						
1 21	31A07-12200			SEAL, SIDE	4						
1 22	F3153-06000			O-RING	1						
1 23	31A11-11200			GASKET, GEAR CASE	1						
1 24	31A30-00801			GASKET, INLET PIPE	1						
1 25	31A35-02300			PACKING, BODY	1						
1 26	31A46-10101			GASKET, THERMO CASE	1						
1 27	31A63-12201			GASKET, GOVERNOR CASE	1						
1 28	31B01-23200			GASKET, CYLINDER HEAD	1						
1 29	31B04-13201			GASKET, ROCKER COVER	1						
1 30	31B30-00902			GASKET, INLET COVER	1						
1 31	31B32-01200			GASKET, EXHAUST MANF	1						
1 32	32A91-05100			GASKET, LIQUID	1						
1 33	34340-00700			GASKET	1						
1 34	MF660063			GASKET	2						
1 35	05946-01601			WASHER, SEALING	4						
1 36	32C39-00200			O-RING, OIL COOLER	1						
1 37	MF520004			O-RING, LEVEL GAGE	1						
1 38	MD000551			GASKET, WATER OUTLET	1						
1 39	MM435249			PROTECTOR, OIL INLET	1						
1 40	F4202-14000			GASKET	2						

Date	Particulars	Debit	Credit	Balance
1912				
Jan 1	Balance forward			
Jan 2	By Cash			
Jan 3	To Cash			
Jan 4	By Cash			
Jan 5	To Cash			
Jan 6	By Cash			
Jan 7	To Cash			
Jan 8	By Cash			
Jan 9	To Cash			
Jan 10	By Cash			
Jan 11	To Cash			
Jan 12	By Cash			
Jan 13	To Cash			
Jan 14	By Cash			
Jan 15	To Cash			
Jan 16	By Cash			
Jan 17	To Cash			
Jan 18	By Cash			
Jan 19	To Cash			
Jan 20	By Cash			
Jan 21	To Cash			
Jan 22	By Cash			
Jan 23	To Cash			
Jan 24	By Cash			
Jan 25	To Cash			
Jan 26	By Cash			
Jan 27	To Cash			
Jan 28	By Cash			
Jan 29	To Cash			
Jan 30	By Cash			
Jan 31	To Cash			
Feb 1	By Cash			
Feb 2	To Cash			
Feb 3	By Cash			
Feb 4	To Cash			
Feb 5	By Cash			
Feb 6	To Cash			
Feb 7	By Cash			
Feb 8	To Cash			
Feb 9	By Cash			
Feb 10	To Cash			
Feb 11	By Cash			
Feb 12	To Cash			
Feb 13	By Cash			
Feb 14	To Cash			
Feb 15	By Cash			
Feb 16	To Cash			
Feb 17	By Cash			
Feb 18	To Cash			
Feb 19	By Cash			
Feb 20	To Cash			
Feb 21	By Cash			
Feb 22	To Cash			
Feb 23	By Cash			
Feb 24	To Cash			
Feb 25	By Cash			
Feb 26	To Cash			
Feb 27	By Cash			
Feb 28	To Cash			
Feb 29	By Cash			
Feb 30	To Cash			
Feb 31	By Cash			
Mar 1	To Cash			
Mar 2	By Cash			
Mar 3	To Cash			
Mar 4	By Cash			
Mar 5	To Cash			
Mar 6	By Cash			
Mar 7	To Cash			
Mar 8	By Cash			
Mar 9	To Cash			
Mar 10	By Cash			
Mar 11	To Cash			
Mar 12	By Cash			
Mar 13	To Cash			
Mar 14	By Cash			
Mar 15	To Cash			
Mar 16	By Cash			
Mar 17	To Cash			
Mar 18	By Cash			
Mar 19	To Cash			
Mar 20	By Cash			
Mar 21	To Cash			
Mar 22	By Cash			
Mar 23	To Cash			
Mar 24	By Cash			
Mar 25	To Cash			
Mar 26	By Cash			
Mar 27	To Cash			
Mar 28	By Cash			
Mar 29	To Cash			
Mar 30	By Cash			
Mar 31	To Cash			

Page

NUMERICAL PARTS INDEX

PART NO.	GROUP NO.	PAGE	REF. NO.	PART NO.	GROUP NO.	PAGE	REF. NO.	PART NO.	GROUP NO.	PAGE	REF. NO.
A414X-19271	68-00-02	89	1 03	MD611928	68-00-02	89	1 08	MF522010	04	7	8 02
A414X-21271	68-00-02	89	1 05	MD701788	94	97	1 05	MF660036	35-02	47	2
A647X-50170	68-00-02	89	1 12	MD703856	65-02	81	2	MF660036	94	97	1 07
A930X-94570	68-00-02	89	1 06	MF100055	07-00-02	15	6	MF660063	94	97	1 34
A981X-20771	68-00-02	89	1 01	MF100055	65-00-01	77	18	MF660068	94	97	1 17
F1035-05010	04	7	8 01	MF100064	11	21	6	MF665511	07-00-01	13	10
F1035-08020	32	43	4	MF100064	63	75	7	MF665532	07-00-01	13	4
F2325-08000	04	7	8 04	MF100110	14	27	1	MF665533	07-00-01	13	5
F2846-05000	07-00-01	13	14	MF101256	35	45	2	MF665537	07-00-01	13	17
F2850-03020	63	75	2 20	MF101266	32	43	5	MF665538	01	3	1 03
F3150-01010	63	75	2 21	MF140026	68-00-01	87	3	MK661-12000	65-00-01	77	19
F3153-06000	94	97	1 22	MF140227	46	61	1 02	MM301607	92	95	4 01
F4202-14000	94	97	1 40	MF240031	45	57	1 01	MM301618	92	95	4 03
F4300-02000	46	61	4 02	MF240051	05	11	4	MM301646	92	95	4 04
F8000-08000	07-00-01	13	13 01	MF240051	11	21	3	MM315438	92	95	4 02
F8665-02100	92	95	1	MF240051	13	25	2	MM316248	90	93	2
K6516441	46	61	1 01	MF240051	62	73	4	MM317-41701	92	95	4 05
K8712630	63	75	2 22	MF241223	62	73	5	MM400380	43	55	1
MD000245	01	3	1 02	MF241224	63	75	11	MM400-88001	62	73	3
MD000269	07-02	17	1	MF241229	48-02	65	2	MM401080	63	75	2 26
MD000312	94	97	1 18	MF241251	65-02	81	5	MM405-43002	48	63	1
MD000425	65-02	81	3	MF241253	30	41	6	MM408245	12	23	3
MD000551	94	97	1 38	MF241259	30	41	5	MM408470	01-02	5	1
MD001521	68-00-01	87	2	MF241261	04-02	9	3	MM409040	65-00-01	77	1
MD006704	19	31	1 01	MF241266	30	41	7	MM409041	65-00-01	77	2
MD008762	11	21	7	MF241266	46	61	3	MM409042	65-00-01	77	3
MD008784	04-02	9	4	MF241280	01-02	5	2	MM409043	65-00-01	77	4
MD016483	04	7	5	MF241282	66	83	2	MM409044	65-00-01	77	5
MD021105	19	31	1 02	MF241308	12	23	5	MM409045	65-00-01	77	6
MD024256	07-00-01	13	15	MF241315	12	23	4	MM409046	65-00-01	77	7
MD041704	49	67	1	MF243628	61-00-01	69	9	MM409047	65-00-01	77	8
MD050316	13	25	1 02	MF244860	45	57	3	MM409048	65-00-01	77	9
MD050317	13	25	1 03	MF244863	45	57	4	MM409150	63	75	9
MD050317	94	97	1 09	MF401936	32	43	3	MM409303	45	57	1
MD068353	61-00-01	69	3	MF430004	63	75	2 23	MM409304	45	57	1 02
MD068355	61-00-01	69	2	MF430006	66	83	4	MM409-31302	46	61	1 03
MD068355	94	97	1 02	MF430006	68-00-01	87	4	MM409326	45	57	1 03
MD070717	61-00-01	69	1	MF430126	20	33	5	MM409326	94	97	1 11
MD070717	94	97	1 03	MF430725	63	75	2 24	MM409327	45	57	1 04
MD115472	04	7	6	MF430729	35-02	47	1 01	MM409427	66	83	3
MD115472	94	97	1 04	MF450006	68-00-01	87	6	MM409645	07-00-01	13	12
MD603490	61-00-02	71	1 03	MF450010	20	33	3	MM409671	87	91	1 02
MD603491	61-00-02	71	1 03	MF450405	63	75	2 25	MM430131	61-00-01	69	10 01
MD603492	61-00-02	71	1 03	MF450406	66	83	5	MM430613	07-00-01	13	3
MD603493	61-00-02	71	1 03	MF450406	68-00-01	87	5	MM430614	61-00-01	69	8
MD603494	61-00-02	71	1 03	MF450410	20	33	4	MM430703	61-00-01	69	7
MD603495	61-00-02	71	1 03	MF472404	07-00-01	13	11	MM431-53801	12	23	1
MD603496	61-00-02	71	1 03	MF476018	65-02	81	4	MM432104	90	93	1
MD603497	61-00-02	71	1 03	MF476215	05	11	2	MM433-30601	04	7	4
MD603498	61-00-02	71	1 03	MF476215	20	33	2	MM433675	63	75	2 28
MD603499	61-00-02	71	1 03	MF520004	94	97	1 37	MM434493	48-02	65	1
MD603660	61-00-02	71	1 07	MF520012	94	97	1 06	MM434-59001	92	95	4

NUMERICAL PARTS INDEX

PART NO.	GROUP NO.	PAGE	REF. NO.	PART NO.	GROUP NO.	PAGE	REF. NO.	PART NO.	GROUP NO.	PAGE	REF. NO.
MM435190	62	73	1	30A13-02101	94	97	1 08	31A09-01030	09	19	3
MM435249	94	97	1 39	30A19-00040	19	31	2	31A09-01040	09	19	4
MM435-94101	61-00-02	71	1	30A19-10010	19	31	3	31A11-00500	11	21	4
MM500229	65-00-02	79	1 07	30A19-10020	19	31	4	31A11-02200	11	21	1
MM500230	65-00-02	79	1 10	30A19-10030	19	31	5	31A11-11200	11	21	5
MM500231	65-00-02	79	1 14	30A30-00200	94	97	1 13	31A11-11200	94	97	1 23
MM500299	65-00-02	79	1 21	30A40-00105	40	51	1	31A17-00010	17	29	4
MM500309	65-00-02	79	1 21	30A61-04900	62	73	6	31A17-00020	17	29	5
MM500310	65-00-02	79	1 21	30A63-00101	63	75	10	31A17-00030	17	29	6
MM500311	65-00-02	79	1 21	30A63-00101	94	97	1 14	31A17-09100	17	29	1
MM500312	65-00-02	79	1 21	30A87-00600	92	95	2	31A17-09200	17	29	2
MM500314	65-00-02	79	1 21	30A87-10042	87	91	1	31A17-09300	17	29	3
MM500315	65-00-02	79	1 21	30A87-20402	87	91	1 01	31A17-10602	17	29	7
MM500316	65-00-02	79	1 12	30H45-00101	45	57	2	31A21-03800	21	37	2
MM500360	65-00-02	79	1 09	30H45-00101	94	97	1 16	31A23-00051	07-00-01	13	13
MM500578	65-00-02	79	1 20	30L07-00700	07-00-02	15	2	31A23-00600	23	39	4 01
MM501098	65-00-02	79	1 08	30L63-00030	63	75	2 04	31A23-00800	23	39	3
MM501152	65-00-02	79	1 18	30L63-00600	63	75	2 02	31A23-01023	23	39	4
MM501162	65-00-02	79	1 15	30L63-00700	63	75	2 07	31A23-01302	23	39	1
MM501246	65-00-02	79	1 21	30L63-00800	63	75	1	31A23-01406	23	39	2
MM501311	65-00-02	79	1 11	30L63-02100	63	75	2 05	31A30-00300	30	41	3
MM501320	65-00-02	79	1 19	30L63-02300	63	75	2 06	31A30-00801	30	41	4
MM501364	65-00-02	79	1 21	30L63-02400	63	75	12	31A30-00801	94	97	1 24
MM501365	65-00-02	79	1 21	30L63-12600	63	75	2 08	31A30-03020	92	95	3
MM501838	61-00-02	71	1 05	31A01-01201	01	3	1 04	31A30-03200	92	95	3 01
MM501841	61-00-02	71	1 06	31A01-01301	01	3	1 05	31A35-02300	35	45	1 01
MM501856	65-00-02	79	1 04	31A01-02500	01	3	1 06	31A35-02300	94	97	1 25
MM502574	68-00-02	89	1 13	31A01-02800	01	3	1 07	31A35-05040	35-02	47	1
MM502575	68-00-02	89	1 14	31A01-11101	01	3	3	31A35-30010	35	45	1
MM502578	68-00-02	89	1 02	31A03-13600	01	3	1 08	31A42-00300	42	53	1
MM514045	61-00-02	71	1 01	31A04-00700	04	7	7	31A45-20700	45-02	59	1
MM514047	61-00-02	71	1 04	31A04-01301	04	7	3	31A46-00020	46	61	1 04
MM514048	61-00-02	71	1 02	31A04-10400	04	7	1	31A46-02600	46	61	4 01
MM514109	65-00-02	79	1 16	31A04-10500	04	7	2	31A46-05010	46	61	4
MM514195	65-00-02	79	1 17	31A04-11024	04	7	8 03	31A46-10101	46	61	2
MM514380	61-00-02	71	1 08	31A04-34100	04	7	8 09	31A46-10101	94	97	1 26
MS471104	07-00-01	13	7	31A04-34300	04	7	8 10	31A46-11200	46	61	1 07
MS471105	07-00-01	13	8	31A05-00300	05	11	5	31A46-11200	94	97	1 01
MS471110	07-00-01	13	9	31A05-01300	05	11	6	31A61-01200	61-00-01	69	10 04
MS602039	62	73	6 01	31A07-00801	07-00-01	13	2 03	31A61-01500	61-00-01	69	10 05
MS604032	61-00-01	69	10 02	31A07-02300	07-00-02	15	5	31A61-07101	61-00-01	69	4
MS660163	62	73	6 02	31A07-03100	07-00-01	13	2 04	31A61-07201	61-00-01	69	5
MS660169	61-00-01	69	10 03	31A07-04401	12	23	2	31A61-07301	61-00-01	69	6
MS661140	01	3	2	31A07-11601	07-00-02	15	3	31A63-01800	63	75	2 09
MS661140	07-00-01	13	6	31A07-11701	07-00-02	15	4	31A63-02301	63	75	8
04826-22000	07-00-01	13	2 01	31A07-11701	94	97	1 19	31A63-02600	63	75	2 10
04826-23500	07-00-01	13	2 02	31A07-11901	11	21	2	31A63-02700	63	75	2 11
04827-90130	07-00-01	13	16	31A07-11901	94	97	1 20	31A63-05300	63	75	2 12
05534-16000	12	23	6	31A07-12200	07-00-02	15	1	31A63-05601	63	75	2 03
05946-01601	90	93	3	31A07-12200	94	97	1 21	31A63-10305	63	75	4
05946-01601	94	97	1 35	31A09-01010	09	19	1	31A63-11061	63	75	6
30405-31403	05	11	3	31A09-01020	09	19	2	31A63-11301	63	75	2 14

NUMERICAL PARTS INDEX

PART NO.	GROUP NO.	PAGE	REF. NO.	PART NO.	GROUP NO.	PAGE	REF. NO.	PART NO.	GROUP NO.	PAGE	REF. NO.
31A63-12201	63	75	3	31B94-16020	94	97	1				
31A63-12201	94	97	1 27	32A04-02401	04	7	8 06				
31A63-15200	63	75	2 15	32A36-05012	36	49	1				
31A63-15500	63	75	2 16	32A66-03100	66-02	85	1				
31A63-20201	63	75	5	32A91-05100	94	97	1 32				
31A63-22100	63	75	2 17	32C04-04501	04	7	8 07				
31A68-00402	68-00-02	89	1	32C04-06101	04	7	8 08				
31A68-02100	68-00-01	87	1	32C39-00200	94	97	1 36				
31A68-20300	68-00-01	87	7	34340-00700	36	49	2				
31A90-10300	90	93	4	34340-00700	94	97	1 33				
31B01-13040	01	3	1	47X01-06100	65-00-02	79	1 01				
31B01-23200	01	3	4	47X01-07600	65-00-02	79	1 06				
31B01-23200	94	97	1 28	47X01-07700	65-00-02	79	1 05				
31B04-00014	04	7	8	47X01-13200	65-00-02	79	1 02				
31B04-01010	04	7	8 11	47X01-13300	65-00-02	79	1 03				
31B04-03011	04-02	9	1	47X01-22700	65-00-02	79	1 13				
31B04-13201	04-02	9	2	47X11-02207	66	83	1 16				
31B04-13201	94	97	1 29	47X11-02213	66	83	1 05				
31B05-00103	05	11	1	47X11-02227	66	83	1 09				
31B07-52010	07-00-01	13	1	47X11-02228	66	83	1 15				
31B13-00013	13	25	1	47X11-02231	66	83	1 13				
31B19-01023	19	31	1	47X11-02232	66	83	1 10				
31B20-00203	20	33	1	47X11-02233	66	83	1 11				
31B20-02900	20-02	35	1	47X11-02234	66	83	1 12				
31B21-00090	21	37	1	47X11-02235	66	83	1 03				
31B30-00040	30	41	1	47X11-02237	66	83	1 01				
31B30-00800	30	41	2	47X11-02239	66	83	1 07				
31B30-00800	94	97	1 12	47X11-02241	66	83	1 18				
31B30-00902	94	97	1 30	47X11-02242	66	83	1 19				
31B32-00900	32	43	1	47X11-02243	66	83	1 20				
31B32-01200	32	43	2	47X11-02244	66	83	1 21				
31B32-01200	94	97	1 31	47X11-02246	66	83	1 08				
31B61-02800	61-00-01	69	11	47X11-02247	66	83	1 02				
31B61-10100	94	97	1 15	47X11-02248	66	83	1 22				
31B61-13100	61-00-01	69	10	47X11-02290	66	83	1 14				
31B62-01100	62	73	2	47X11-02304	68-00-02	89	1 11				
31B63-00400	63	75	2 18	47X11-02305	68-00-02	89	1 04				
31B63-00500	63	75	2 19	47X11-02311	68-00-02	89	1 07				
31B63-12060	63	75	2	47X11-02312	68-00-02	89	1 09				
31B65-00300	65-00-01	77	20	47X11-02313	68-00-02	89	1 10				
31B65-01200	65-02	81	1	47X11-02319	66	83	1 04				
31B65-06100	65-00-01	77	10	47X11-02320	66	83	1 06				
31B65-06200	65-00-01	77	11	47X11-02321	66	83	1 17				
31B65-06600	65-00-01	77	12	49168-15200	94	97	1 10				
31B65-06700	65-00-01	77	13								
31B65-06800	65-00-01	77	14								
31B65-06900	65-00-01	77	15								
31B65-07100	65-00-01	77	16								
31B65-07200	65-00-01	77	17								
31B65-14090	65-00-02	79	1								
31B66-00101	66	83	1								
31B66-04100	66-02	85	2								

Year	Q1	Q2	Q3	Q4	Total	Average
1970						
1971						
1972						
1973						
1974						
1975						
1976						
1977						
1978						
1979						
1980						
1981						
1982						
1983						
1984						
1985						
1986						
1987						
1988						
1989						
1990						
1991						
1992						
1993						
1994						
1995						
1996						
1997						
1998						
1999						
2000						
2001						
2002						
2003						
2004						
2005						
2006						
2007						
2008						
2009						
2010						
2011						
2012						
2013						
2014						
2015						
2016						
2017						
2018						
2019						
2020						
2021						
2022						

REV	DATE	DESCRIPTION
1	11/11/80	ISSUED FOR PRODUCTION
2	01/15/81	REVISED TO INCLUDE PART 31N96-00280
3	03/10/81	REVISED TO INCLUDE PART 31N96-00280
4	05/15/81	REVISED TO INCLUDE PART 31N96-00280
5	07/15/81	REVISED TO INCLUDE PART 31N96-00280
6	09/15/81	REVISED TO INCLUDE PART 31N96-00280
7	11/15/81	REVISED TO INCLUDE PART 31N96-00280
8	01/15/82	REVISED TO INCLUDE PART 31N96-00280
9	03/15/82	REVISED TO INCLUDE PART 31N96-00280
10	05/15/82	REVISED TO INCLUDE PART 31N96-00280
11	07/15/82	REVISED TO INCLUDE PART 31N96-00280
12	09/15/82	REVISED TO INCLUDE PART 31N96-00280
13	11/15/82	REVISED TO INCLUDE PART 31N96-00280
14	01/15/83	REVISED TO INCLUDE PART 31N96-00280
15	03/15/83	REVISED TO INCLUDE PART 31N96-00280
16	05/15/83	REVISED TO INCLUDE PART 31N96-00280
17	07/15/83	REVISED TO INCLUDE PART 31N96-00280
18	09/15/83	REVISED TO INCLUDE PART 31N96-00280
19	11/15/83	REVISED TO INCLUDE PART 31N96-00280
20	01/15/84	REVISED TO INCLUDE PART 31N96-00280
21	03/15/84	REVISED TO INCLUDE PART 31N96-00280
22	05/15/84	REVISED TO INCLUDE PART 31N96-00280
23	07/15/84	REVISED TO INCLUDE PART 31N96-00280
24	09/15/84	REVISED TO INCLUDE PART 31N96-00280
25	11/15/84	REVISED TO INCLUDE PART 31N96-00280
26	01/15/85	REVISED TO INCLUDE PART 31N96-00280
27	03/15/85	REVISED TO INCLUDE PART 31N96-00280
28	05/15/85	REVISED TO INCLUDE PART 31N96-00280
29	07/15/85	REVISED TO INCLUDE PART 31N96-00280
30	09/15/85	REVISED TO INCLUDE PART 31N96-00280
31	11/15/85	REVISED TO INCLUDE PART 31N96-00280
32	01/15/86	REVISED TO INCLUDE PART 31N96-00280
33	03/15/86	REVISED TO INCLUDE PART 31N96-00280
34	05/15/86	REVISED TO INCLUDE PART 31N96-00280
35	07/15/86	REVISED TO INCLUDE PART 31N96-00280
36	09/15/86	REVISED TO INCLUDE PART 31N96-00280
37	11/15/86	REVISED TO INCLUDE PART 31N96-00280
38	01/15/87	REVISED TO INCLUDE PART 31N96-00280
39	03/15/87	REVISED TO INCLUDE PART 31N96-00280
40	05/15/87	REVISED TO INCLUDE PART 31N96-00280
41	07/15/87	REVISED TO INCLUDE PART 31N96-00280
42	09/15/87	REVISED TO INCLUDE PART 31N96-00280

SNR	PART NO.	PART NAME	QTY		REMARKS
			SALE	SALE	
1	31N96-00320	LEG, FRONT RIGHT	1	1	
2	31N96-00320	LEG, FRONT LEFT	1	1	
3	31N96-00390	BRACKET, CROSS	1	1	
4	31N47-00030	RADIATOR ASSY SAL	1	1	
4	31N47-00040	RADIATOR ASSY SAL	1	1	
4-1	31N47-00300	CUSHION	2	2	
5	31N47-00100	HOSE WATER UPPER	1	1	
6	31N47-00200	HOSE WATER LOWER	1	1	
7	31N96-00360	SUPPORT, UPPER	1	1	
8	31N96-00470	STAY, UPPER SUPPORT	1	1	
8	31N96-00480	STAY, UPPER SUPPORT	1	1	
8	30N96-02160	PIPE, SPACER	1	1	
10	31N47-00300	CUSHION	2	2	
11	30N96-02300	WASHER, LARGE OD	1	1	
12	F1035-08025	BOLT (55)	1	1	
13	31N96-00430	CONN. SUB ASSY SAL2	1	1	
13	31N96-00440	CONN. SUB ASSY SAL2	1	1	
14	31N96-00460	FAN GUARD SL	1	1	
15	30N96-02170	FILTER ASSY, FUEL	1	1	
15-1	30N96-02180	BRACKET FUEL FILTER	1	1	
15-2	30N96-02190	FILTER FUEL	1	1	
16	30N96-02280	FUEL FUEL FILTER	2	2	
17	30N96-02270	CONNECTOR, FUEL FILTER	2	2	
18	30N92-01500	WASHER SEAL	4	4	
19	31N96-00490	HOSE FUEL (ø=7/8, L=20)	1	1	
20	30N61-01400	CLIP HOSE (13,1)	2	2	
21	30N50-01800	CLEANER ASSY AIR	1	1	
21-1	30N98-00510	ELEMENT (AND AIR CLEANER)	1	1	
22	30N50-02100	BAND AIR CLEANER	1	1	
23	31N96-00400	MOUNT, AIR CLEANER	1	1	
24	F4300-03201	CLAMP HOSE (32)	1	1	
24	F4300-03201	CLAMP HOSE (32)	1	1	
25	31N50-00700	HOSE AIR (52000-100)	1	1	
26	F4300-05701	CLAMP HOSE (57)	1	1	
27	F4300-03701	CLAMP HOSE (37)	2	2	
28	F4300-04701	CLAMP HOSE (47)	2	2	
29	F2440-08000	NUT, SELF LOCKING	1	1	
30	F1035-08012	BOLT	11	11	
31	F1035-08016	BOLT	2	2	

SNR	PART NO.	PART NAME	QTY		REMARKS
			SALE	SALE	
42	F2300-10000	NUT	4	4	
41	F2300-08000	NUT	4	4	
40	F2300-10000	WASHER, PLAN	2	2	
39	F2500-08000	WASHER, PLAN	11	11	
38	F2515-10000	WASHER, SPRING	4	4	
37	F2515-08000	WASHER, SPRING	8	8	
36	F2515-08000	WASHER, SPRING	8	8	
35	F1035-10030	BOLT	2	2	
34	F1035-10025	BOLT	2	2	
33	F1035-10020	BOLT	12	12	
32	F1035-08020	BOLT	4	4	

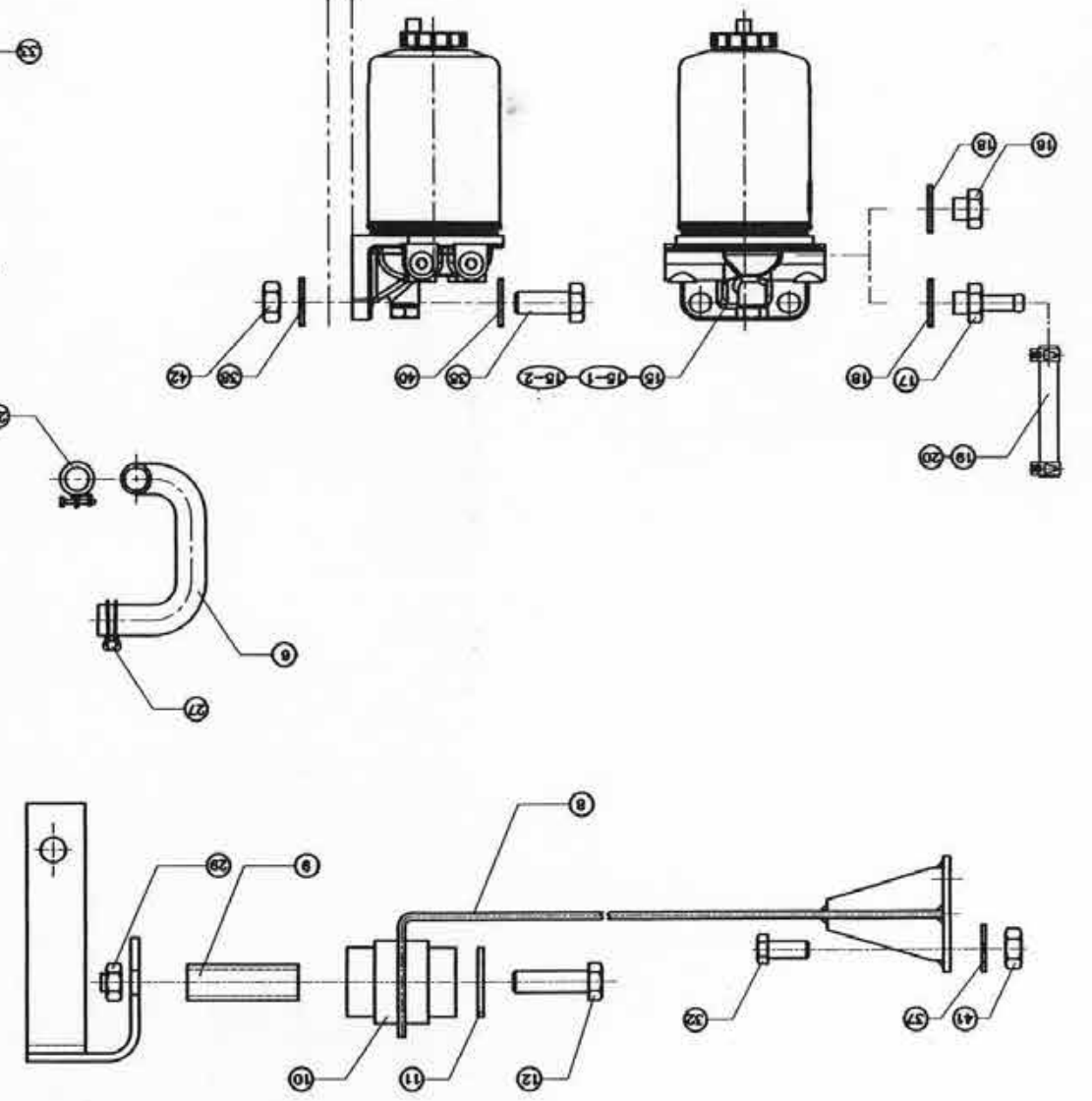
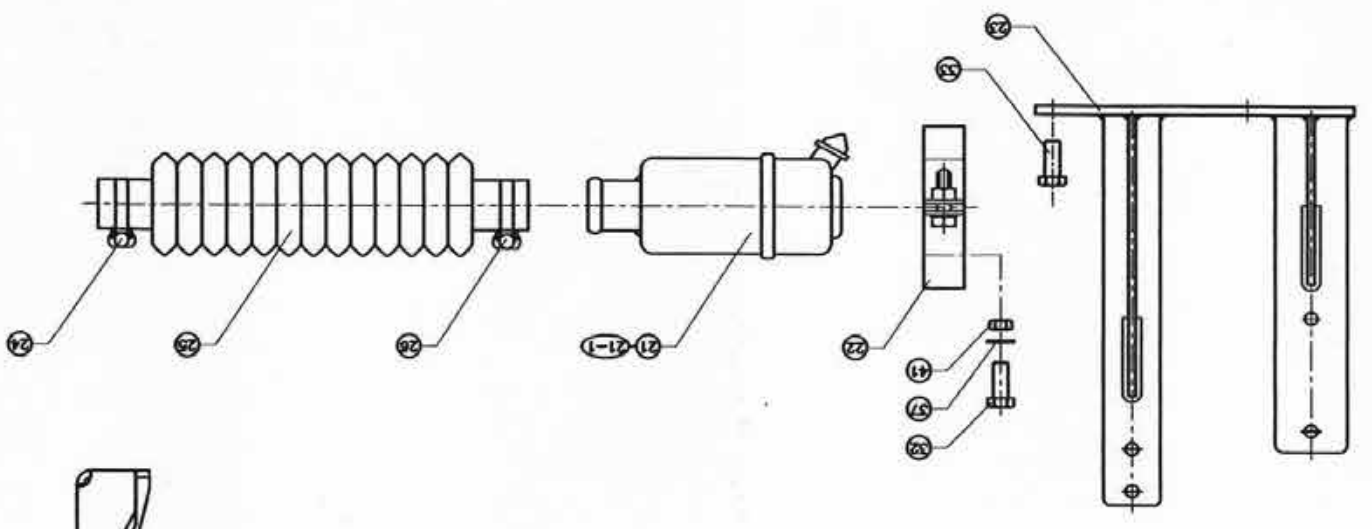
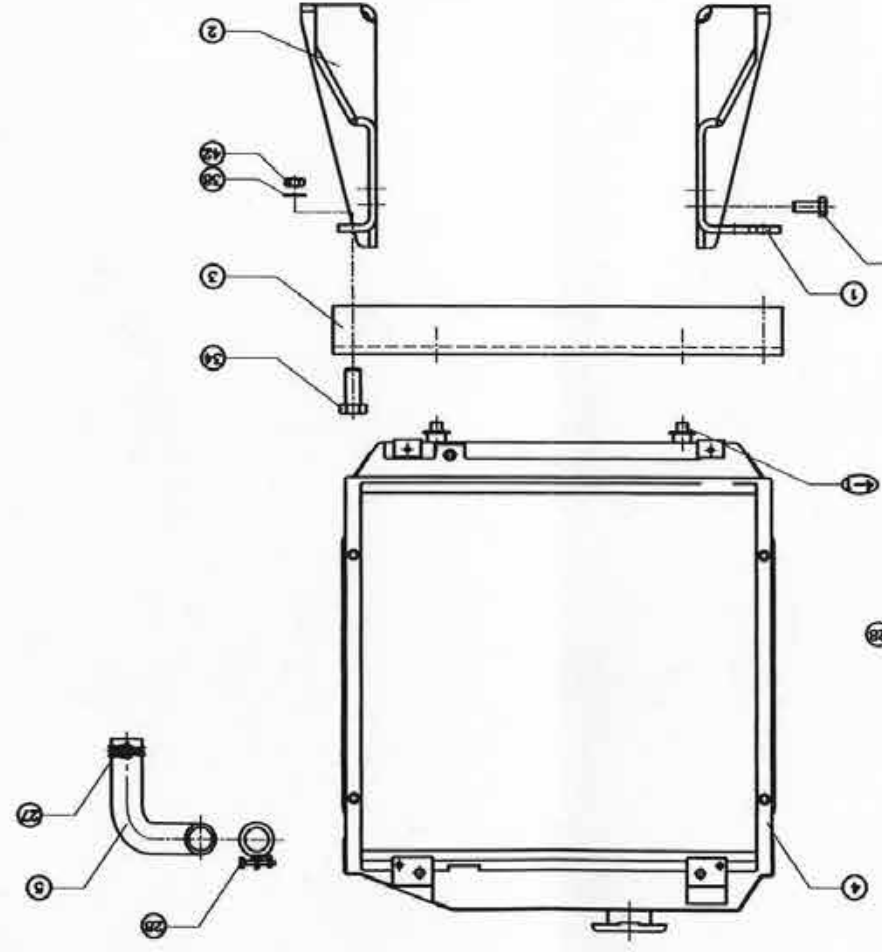
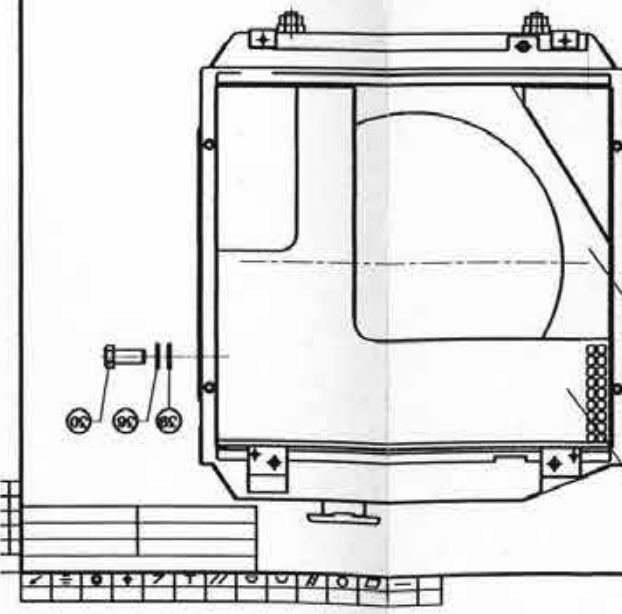

31N96-00280

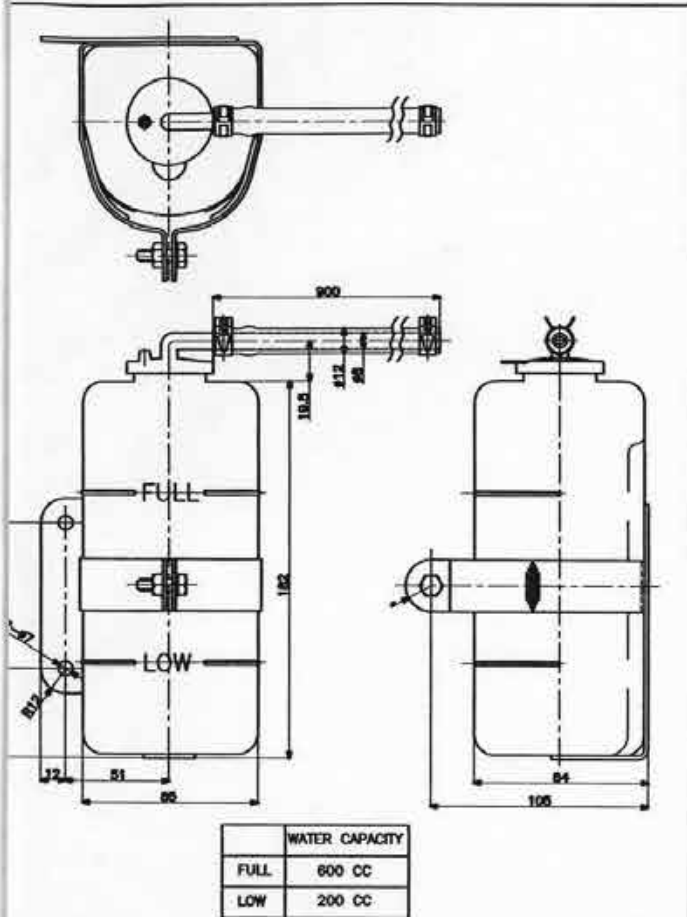

TANK ASSY, RESERVOIR 30N96-00100

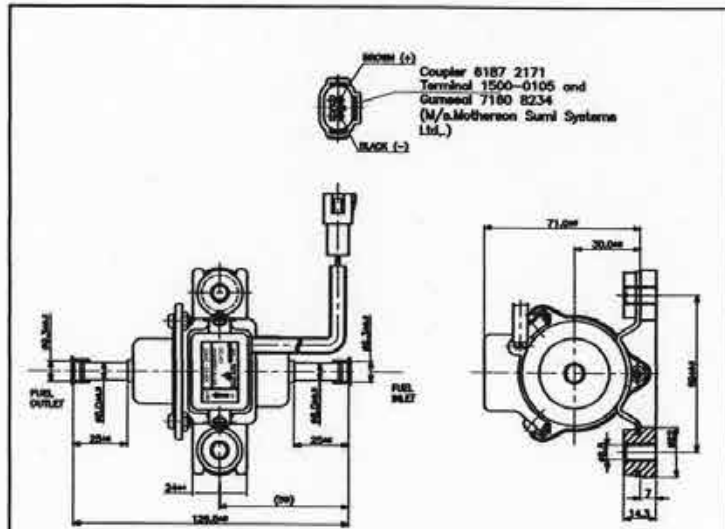

3. Vibration: less than 4.4G for all direction at mounting plate.
 2. Pre filter is required less than 43 micron.
 NOTE: 1. Pump mounting direction: Inlet & outlet pipes horizontally.

SPECIFICATIONS	
RATED VOLTAGE	DC 12 V
MAX. CURRENT	1.5 A MAX
PUMP DELIVERY	500 cc/min
SUCTION HEAD	-500 mm MAX
WEIGHT	450 g
WORKING TEMPERATURE RANGE	-30 ~ 60 °C
TOTAL PRESSURE (DELIVERY + SUCTION)	ZERO DELIVERY 24.9 kpa (0.3 kg) MAX

PUMP ASSY, FUEL 30N60-20300

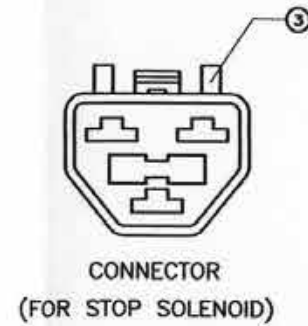

CONNECTOR (FOR STOP SOLENOID)

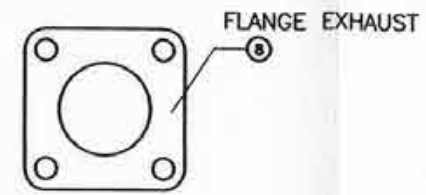

FLANGE EXHAUST

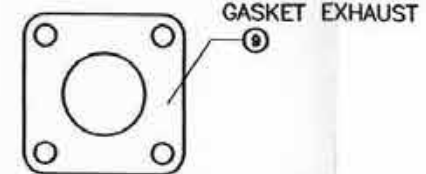

GASKET EXHAUST

RECOMMENDED FUEL LINE

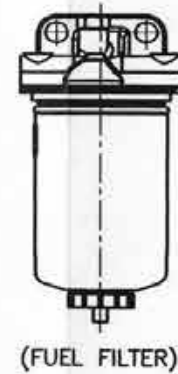
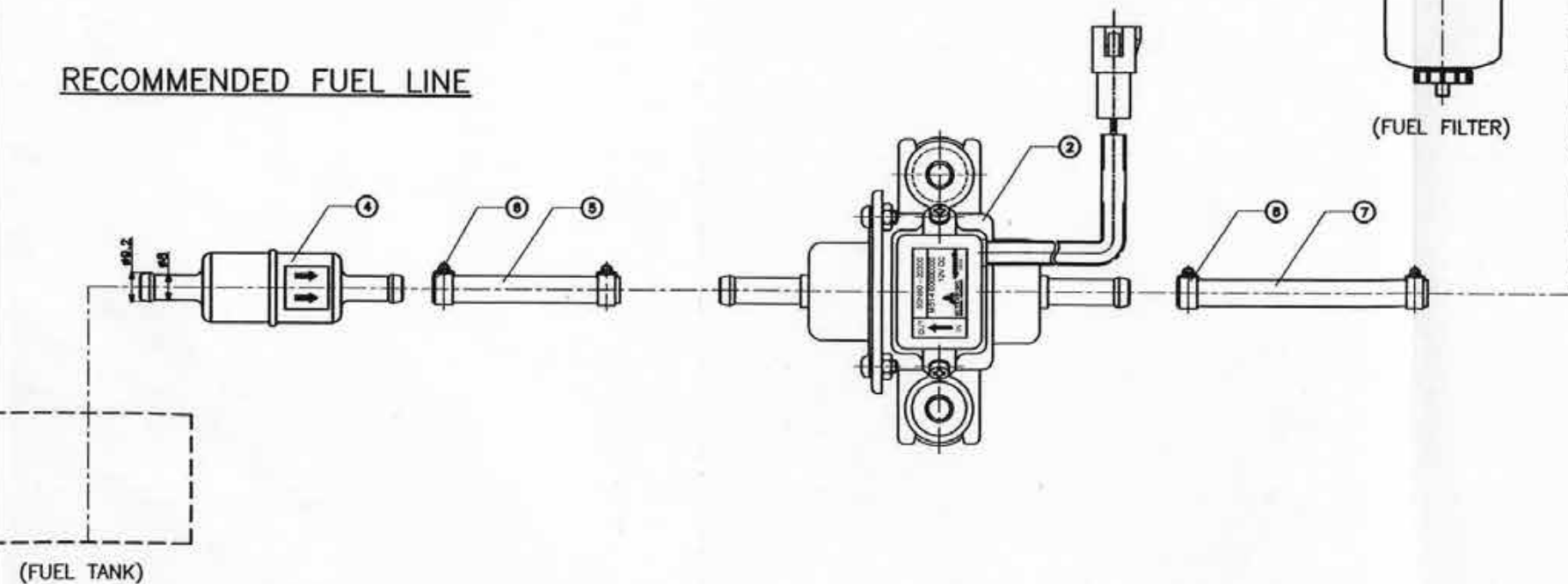

(FUEL FILTER)

SYM	PART NO.	PART NAME	L3E	S3,4L	REMARKS	QTY
9	30N32-00400	GASKET EXHAUST				1
9	30N32-00100	GASKET EXHAUST				1
8	30N32-00300	FLANGE EXHAUST				1
8	30N32-00200	FLANGE EXHAUST				1
7	30N81-02500	HOSE FUEL (d=7.8, L=400)				1 1
6	30N81-02400	CLAMP HOSE (18)				4 4
5	30N81-03300	HOSE FUEL (d=7.8, L=150)				1 1
4	30N82-00400	PRE FILTER				1 1
3	30A87-00800	CONNECTOR				1 1
2	30N60-20300	PUMP ASSY FUEL				1 1
1	30N96-00100	TANK, RESERVOIR				1 1

LOOSE SUPPLY KIT L3E	
30N96-02040	LOOSE SUPPLY KIT L3E
(30N96-02040)	30N96-02030

30N96-02030
30N96-02030

